

Revised 4-6-18		CMS#	18134014 PERMIT	
CenturyLink BSW Order/Maintenance Work Authorization				
Company	T600	Exchange Name	OSSEO	Service Order#
Work Activity	Fiber-Buried	Capital	Y	Maintenance
Customer Name	Linda Roxbury		Phone#	7634247601
Address	10773 Boundary Creek Terr		One Call Ticket#	
City & Zip	Maple Grove MN			
Location/Directions	Plow 165 ft from ped to Nid. 15 ft bore required under driveway			
Held Order	N	Permit:	Y	Bore:
Tech Name and Tech #	Don Evans	Employee Contact#	6124303133	
Sketch	Material/Labor Units		Footage/Quantity	Comments
(Include Cntr Line & Pedestal)	Description	Notes		
Cntr Line foot#	33	SEB3-22	BSW-3 & plow picmt	
		SEB3-22T	BSW-3 & hand dig picmt	
Ped#		SEPCUTOVER	CUTOVER BSW	1
Parish/County		BM83	BSW guard at house	
		XXSEB-GL	Remove temp drop	1
Township:		BM61(1.25)SEB	BSW Bore footage	100
Section		SEBO PER FT LBR	Fiber & plow picmt	65
Range		SEBO PER FT LBR T	Fiber & hand dig picmt	
		SEB6-22	BSW-6 & plow picmt	
		BM2(5/8)(8)	Ground Rod	
		Trip Charge	Trip Charge	1
		BM61(3)D-Rock CBL	Rock Boring	
		Permit	Permit	1
Nearest cross st.		Plat Page		Map#

Estimated Cost

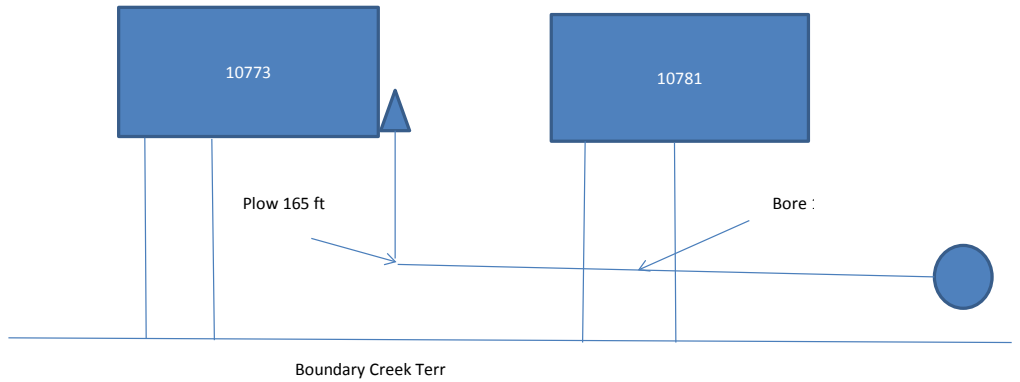

Originated By:		Date:		Completed By:		Date:	
Authorized By: (APS)		Date:		Inspected By:		Date:	
Authorized By: (AOM)		Date:					
Email sketch to:	MetroBSW@Centurylink.com						
1. Distance of the bury in Right-of-Way		3. Distance to the nearest intersection					
2. Distance from the terminal to the centerline		4. Nearest State Hwy mile marker					