

DESIGNER EXPRESS DESIGN

7/5/2018 12:50:34 PM

WO# 86855006 Install New Service Line - Plastic - CSV  
 INSTALL: 2" X 1-1/4" IPS PE2406/2708 SVC TEE W/ 3/4" TAP  
 INSTALL 1 1/4" ASSEMBLY 2" IPS CEFV 5500 SERIES EFV  
 INSTALL 320' OF 1 1/4" IPS PE2406/2708 CL-6 SERVICE LINE  
 W/ 1 1/4" MPT x 1 1/4" IPS ANODELESS RISER W/ BYPASS, WSLEEVE  
 SVC EQ 61242621

WO# 86718578 Install New Measurement Station  
 INSTALL 3MTC ERT'D OSM W/ BYPASS (CL-6) (LOAD: 3,148 CFH)  
 @2PSI W/ 2" B34R REGULATOR W/ 3/8" ORIFICE W/ 1" 289H RELIEF @3PSI  
 MTR EQ 15128807

When butt fusing to existing in-service polyethylene, visually inspect for the presence of hydrocarbon permeation immediately after removing fusion iron. If any bubbling is identified on the heated surface, cut to new PE pipe. Allow to cool and cut this end off (12" length) and send to the Golden Valley Street location and W.O. #. Complete tie-in/extension using an electrofusion coupling(s). in field notes.

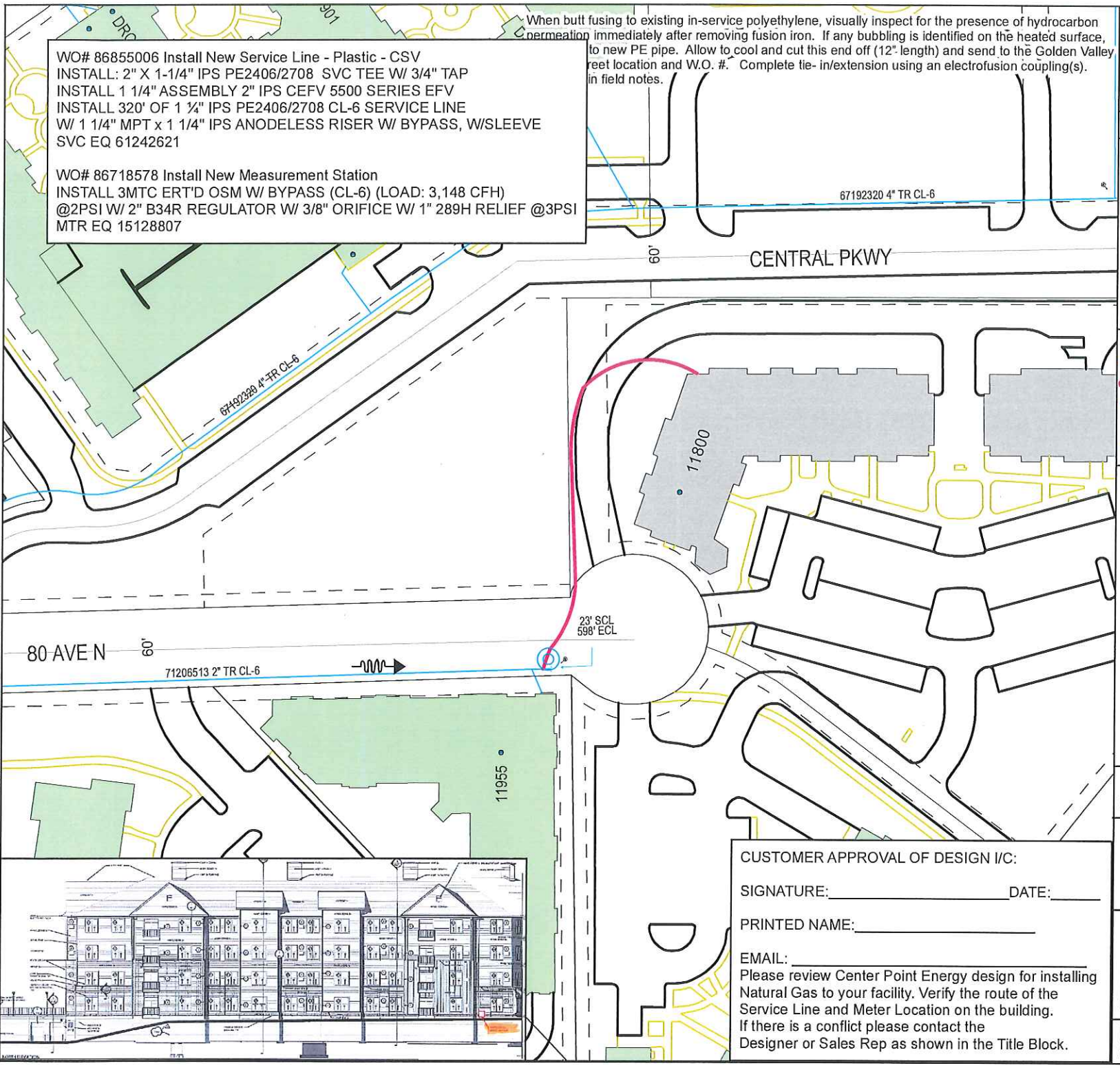

PROPRIETARY AND CONFIDENTIAL

**86855006**  
 M52900 MAPLE GROVE

ONE CALL:  
 Hennepin  
 \*SE23 T119/R22  
 \* = this Page

LEGEND:

	ACTIVE		Interruptible
	DESIGNED		Existing
	PROPOSED		Normal
	ABANDONED		Future
	ABANDONED		Proposed

Address: 11800 80 AVE N  
 Customer: BOTTINEAU RIDGE II  
 Contact Person: LYLE BEUMER  
 Contact Phone: 320-980-4825  
 Sales Rep: JAKE SCHWEITERING  
 Sales Rep Phone: 763-785-5432  
 Construction Hotline: 612-321-5310  
 Copies To Pipeline Integrity: No  
 Curb Valve: No  
 Copies to Corrosion: No  
 Corrosion Approval: NA  
 Follow Internal Pipe Sampling Requirements? No  
 GFIP#: N/A  
 Permits: CITY  
 Requested Install Date: 08/05/2018

Approval: \_\_\_\_\_

PROJECT DESCRIPTION:  
 BOTTINEAU RIDGE II

DESIGNER: Stacie Yerks  
 PHONE #: 612-321-5279  
 DRAWN BY: Stacie Yerks  
 DESIGN DATE: 7/5/2018

Revised Print  
 Destroy All Others  
 Revision History  
 Date:  
 Description:  
 Design Approval:

IC Services  
 SCAN DATE: \_\_\_\_\_

1" : 100'  
 SHEET 1 OF 1

CUSTOMER APPROVAL OF DESIGN I/C:  
 SIGNATURE: \_\_\_\_\_ DATE: \_\_\_\_\_  
 PRINTED NAME: \_\_\_\_\_  
 EMAIL: \_\_\_\_\_  
 Please review Center Point Energy design for installing Natural Gas to your facility. Verify the route of the Service Line and Meter Location on the building. If there is a conflict please contact the Designer or Sales Rep as shown in the Title Block.

