

9530 Kingsview Ln N, Maple Grove
 Feeder: ECK061
 Voltage: 13.8 kVA

Task 1. Directional Bore
 Bore in 670' of 1/0 AL UG cable from LBC P10 to D4, D4 to D6.
 Bore in 4620' of #2 AL UG cable from splice between D4 and D6 to E4 (A Phase). Then B phase from D6 to E5, then A + B phase meet at splice and both phases go to splice before K5. B phase goes north at splice to K5. Then from K5 to F5, F5 to L5, L5 to G5, G5 to M5, M5 to N5, N5 to H5, and H5 to P5.

Task 2 Terminations.
 Terminate at P10, D4, D6, E4, E5, K5, F5, L5, G5, M5, N5, H5, and P5.

Task 3 Restorations.

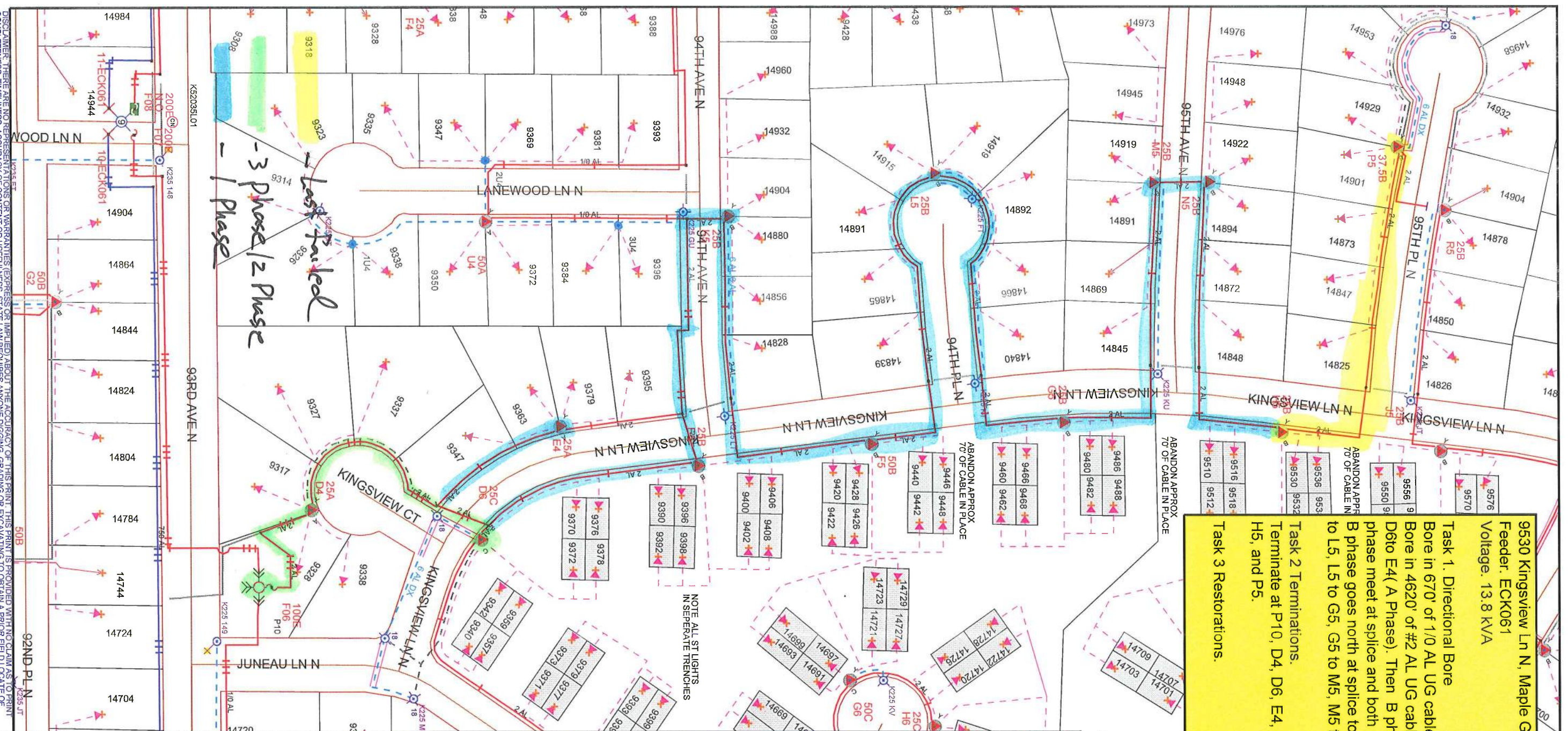

Alex Carlson
 O-651-229-2512
 C-218-591-5080

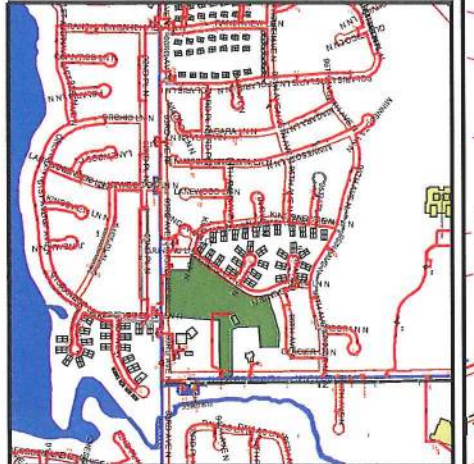

Work Order Information	
Service Request #	: 0000547524
Design Number	: 217029
Designer/Planner ID	: Carlson, Alex
Designer/Planner Name	: Carlson, Alex
Designer/Planner Ph #	: 651-229-2512
Manager Approval	:
Joint Utility	
E:	G:
T:	C:
Design Location	
Division	: Maple Grove
County	: Hennepin
City	: Maple Grove
Address	: 9530 Kingsview Ln N
T: 119N R: 22W S: 9	Permit:
Map #: K52025	
Electric	
Feeder:	See Notes
Voltage:	See Notes
Phase:	See Notes Bkup Dev ID:
Gas	
System:	Pressure:
Size:	Material:
Dead End:	
Work Order #: 12432128	
Date: 08/30/2016	
Sketch: # Of Sketch Data	
Scale: 1" equals 133'	
CONSTRUCTION USE ONLY	
<input type="checkbox"/> NO CHANGES (BUILT AS DESIGNED) <input type="checkbox"/> CHANGES MADE AS INDICATED <input type="checkbox"/> ALL UPRD MUST HAVE ACTUAL MEASUREMENTS FROM THE FIELD SITE!	
RFO	DATE
FOREMAN	DATE
TEAM LEADER	DATE

DISCLAIMER: THERE ARE NO REPRESENTATIONS OR WARRANTIES (EXPRESS OR IMPLIED) ABOUT THE ACCURACY OF THIS PRINT. THIS PRINT IS PROVIDED WITH NO CLAIM AS TO PRINT COMPLETENESS, TIMELINESS, ACCURACY OF CONTENT OR USEFULNESS. STATE LAW REQUIRES ANYONE DIGGING, GRADING OR EXCAVATING TO OBTAIN A PRIOR FIELD LOCATOR OF ALL UTILITIES. THIS PRINT DOES NOT DISCHARGE THIS REQUIREMENT OR ANY OTHER REQUIREMENT. THE COMPANY AND ITS AFFILIATES ASSUME NO LEGAL RESPONSIBILITY OF LOSS OR LIABILITY FOR THE RECIPIENT'S USE OF ANY OTHER PARTIES' USE OF THE PRINT, INCLUDING THE RECIPIENT'S WEDDING PRINTS, HOUSE OR RISK. BY ACCEPTING THIS PRINT, THE RECIPIENT HAS BEEN AUTHORIZED TO PROVIDE THIS PRINT TO ANY OTHER PARTIES AND AGREES TO THIS DISCLAIMER. For All Field Locators Call 811