

**Tony Rosales**  
 Office:763-245-6056  
 Cell:763-245-6056  
 8311 Niagara Ln N  
 Maple Grove MN  
 Feeder:ECK062  
 Boring in approx 200ft of new 4/0AL UG service cable to feed address 8311. Abandon old cable.  
 \*\*House is currently on add a phase.

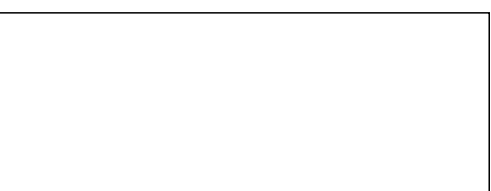
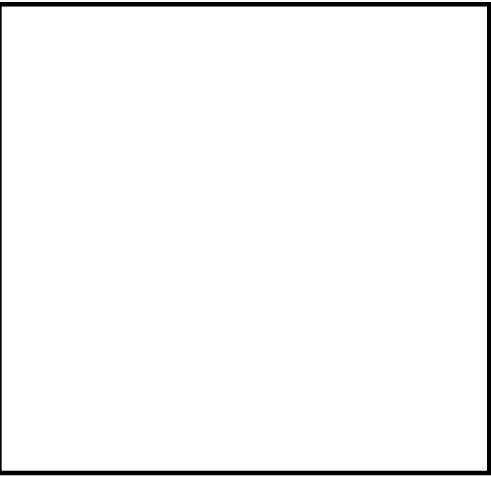
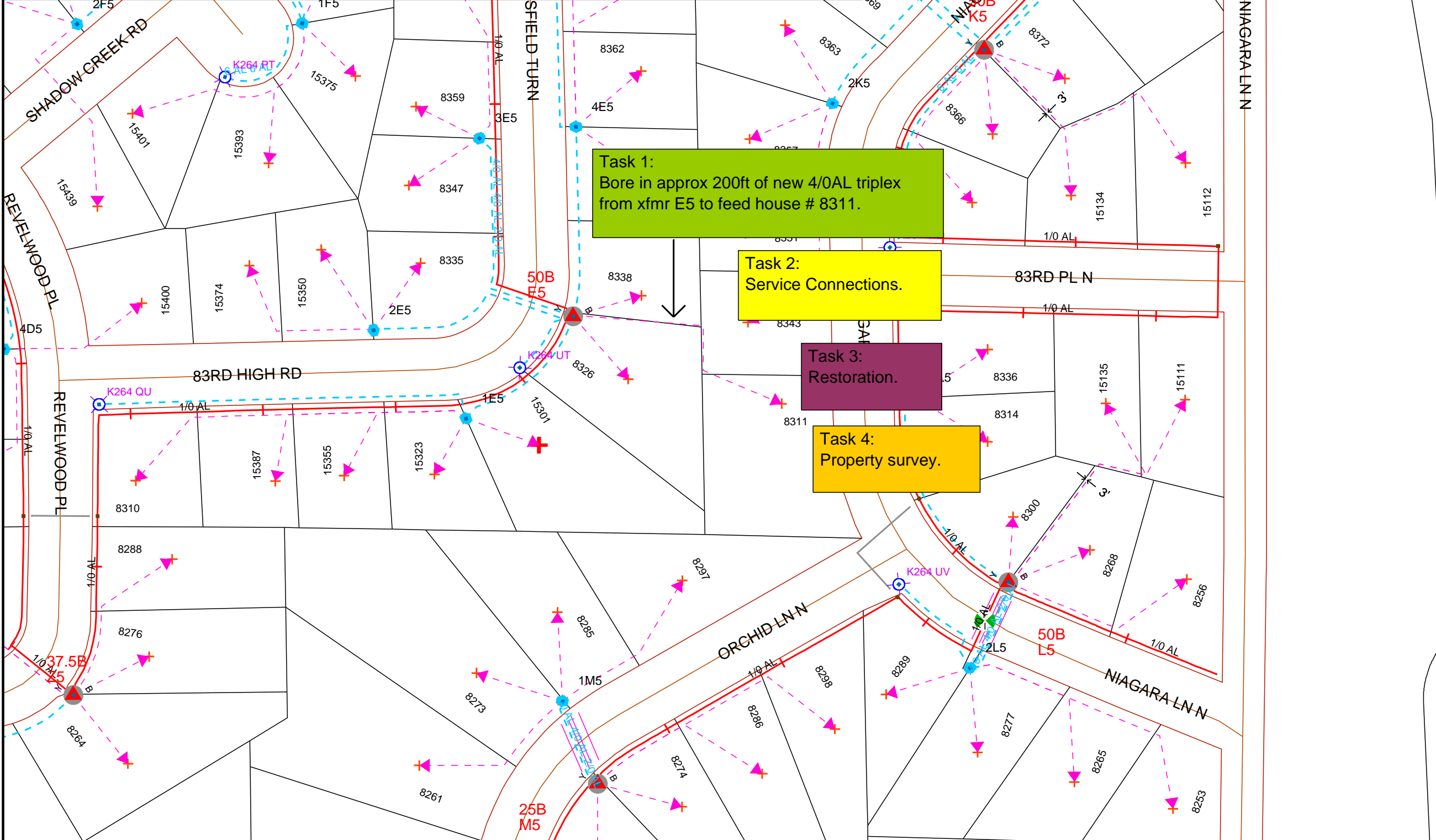

Work Order Information	
Service Request #	:
Design Number	: 0000545925 1
Designer/Planner ID	: 223912
Designer/Planner Name	: Tony Rosales
Designer/Planner Ph #	: 763-245-6056
Manager Approval	:

Joint Utility	
E:	G:
T:	C:

Design Location	
Division	: Maple Grove
County	: Hennepin
City	: Maple Grove
Address	:
T: 119N	R: 22W S: 21
Map #	: K52064
Permit	:

Electric	
Feeder: ECK062	Voltage: 7970
Phase: B	Bkup Dev ID:

Gas	
System	: Pressure
Size	: Material
Dead End	:

Work Order # :

Date: 08/17/2016

Sketch: # Of # Sketch Data

Scale: 1" equals 100'

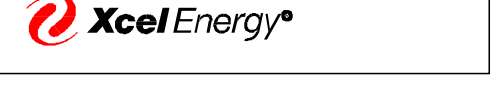
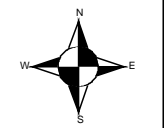

**CONSTRUCTION USE ONLY**

- NO CHANGES (BUILT AS DESIGNED)
- CHANGES MADE AS INDICATED (ALL URD MUST HAVE ACTUAL MEASUREMENTS FROM THE FIELD SITE)

RFO \_\_\_\_\_

FOREMAN \_\_\_\_\_ DATE \_\_\_\_\_

TEAM LEADER \_\_\_\_\_

DISCLAIMER: THERE ARE NO REPRESENTATIONS OR WARRANTIES (EXPRESS OR IMPLIED) ABOUT THE ACCURACY OF THIS PRINT. THIS PRINT IS PROVIDED WITH NO CLAIM AS TO PRINT COMPLETENESS, TIMELINESS, ACCURACY OF CONTENT OR USEFULNESS. STATE LAW REQUIRES ANYONE DIGGING, GRADING OR EXCAVATING TO OBTAIN A PRIOR FIELD LOCATE OF ALL UTILITIES; THIS PRINT DOES NOT DISCHARGE THIS REQUIREMENT OR ANY OTHER REQUIREMENT. THE COMPANY AND ITS AFFILIATES ASSUME NO LEGAL RESPONSIBILITY OR LIABILITY FOR THE RECIPIENT'S USE (OR ANY OTHER PARTIES' USE) OF THE PRINT, INCLUDING THE RECIPIENT'S INTENDED PURPOSE IN USING THE PRINT. NO COMPANY EMPLOYEE OR OTHER PARTY HAS BEEN AUTHORIZED TO PROVIDE THIS PRINT FOR PLANNING OR ESTIMATING PURPOSES; RELY ON THIS PRINT AT YOUR OWN RISK. BY ACCEPTING THIS PRINT, THE RECIPIENT & ANY OTHER PARTY RECEIVING A COPY OF THE PRINT ACKNOWLEDGES AND AGREES TO THIS DISCLAIMER. For All Field Locates Call 811