

NOTE: BORE ALL PAVED STREETS AND DRIVEWAYS  
 Minimum depth requirements for crossings of state highways and county roads is 60".  
 Minimum depth requirements for crossings of city streets and township roads is 48".  
 Minimum depth for parallel installations on state highways and county roads is 36".  
 Minimum depth for parallel installations on city streets and township roads is 30".  
 All steel pipe welds to be coated with 2 part epoxy.

INSTALL LOCATING POINTS AT A MAXIMUM SPACING OF 1,000 FT.

INSTALL 2" PE CL-6  
 JOINT TRENCH IN UTILITY EASEMENT

MAINTAIN A MINIMUM DISTANCE  
 OF 10 FEET FROM ALL BUILDINGS

C = INSTALL 2" PE CAP TO COVER SERVICE  
 T = INSTALL 2" PE TEE

Install; Clean and Test; and Put in Service; Proposed new main per  
 CenterPoint Energy Construction and Service Manual.

Purge new main until essentially 100% gas reading is obtained on  
 Combustible Gas Indicator. See CenterPoint Energy Construction  
 and Service Manual Section CS-B-1.230 for purging mains into service.

Install a marker ball at a new end of main, at a valve, at each ell of a  
 horizontal offset, at road crossings and at any fitting or pressure  
 control identified as needing to be located in the future. Refer to  
 CenterPoint Energy Construction and Service Manual section  
 CS-B-1.310 for installation procedures.

I hereby certify that this plan, specification, or report was prepared  
 by me or under my direct supervision and that I am a duly Licensed  
 Professional Engineer under the laws of the state of Minnesota.

Signature: 

Typed or Printed Name: Daniel G. Christensen

Date: 06/01/2018 License Number: 46588

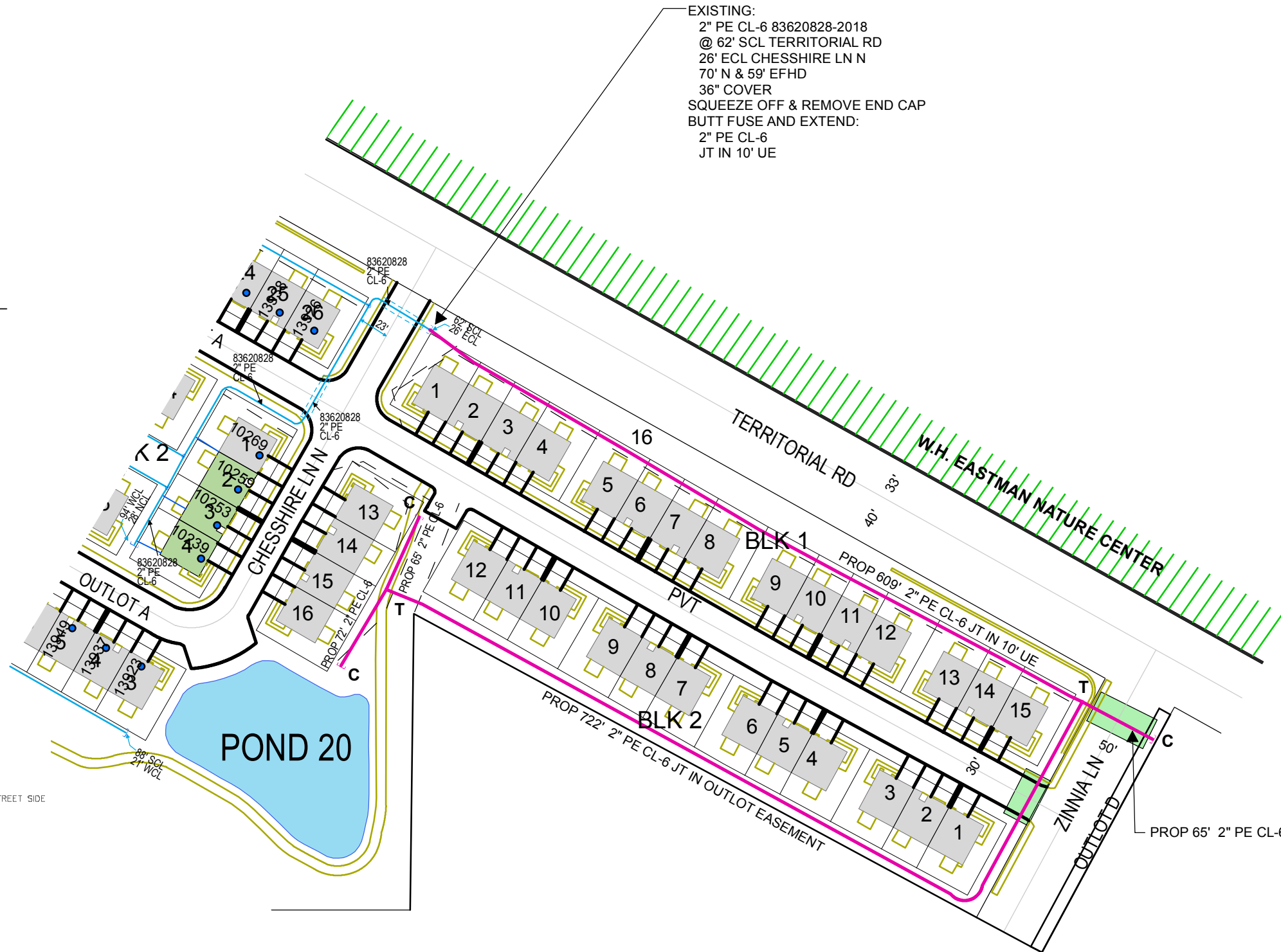

EXISTING:  
 2" PE CL-6 83620828-2018  
 @ 62' SCL TERRITORIAL RD  
 26' ECL CHESSHIRE LN N  
 70' N & 59' EFHD  
 36" COVER  
 SQUEEZE OFF & REMOVE END CAP  
 BUTT FUSE AND EXTEND:  
 2" PE CL-6  
 JT IN 10' UE

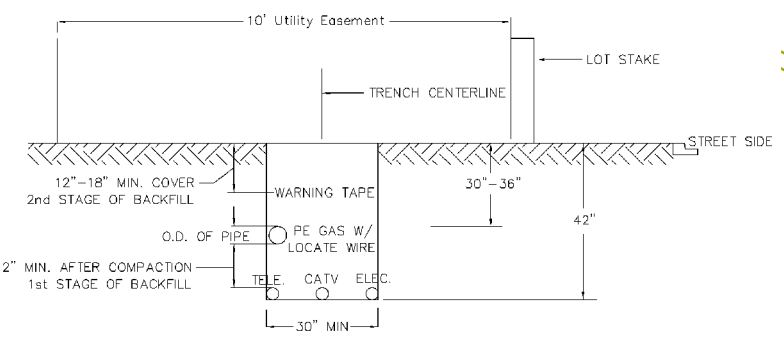

MINNESOTA REGION

PROPRIETARY AND CONFIDENTIAL

PROJECT #: 86351436

M52900 MAPLE GROVE

ONE CALL:  
 Hennepin  
 \*SW3 T119/R22  
 \* = this Page

LEGEND:

- ACTIVE MAIN
- DESIGNED MAIN
- PROPOSED ABANDONED/ OUT OF SERVICE MAIN
- ABANDONED/ OUT OF SERVICE MAIN
- 4" PVC CONDUIT CROSSING TWO REQUIRED

PIPE REQUIRED:  
 1533' 2" PE CL-6  
 1533' PIPE

PROPOSED ABANDONED PIPE:

COPIES:  
 PIPELINE INTEGRITY PACKET: N  
 STATION MANAGER: N  
 DD NUMBER: N  
 CORROSION: N  
 EMP: N

FOLLOW INTERNAL PIPE  
 SAMPLING REQUIREMENTS? N  
 SURVEYOR REQUIRED? N  
 RETURN PACKET TO ENG? N  
 GFIP#: N  
 PERMITS: MAPLE GROVE

PROJECT DESCRIPTION: NBRE  
 TERRITORIAL WOODS 2ND

DESIGNER: Wendy Kronwall  
 PHONE #: 612-321-5508  
 DRAWN BY: Wendy Kronwall  
 DESIGN DATE: 6/1/2018

REVISION INFO:

Main SS# SCALE 1" = 100' SHEET 1 OF 1

6/1/2018 1:37:46 PM DESIGNER EXPRESS DESIGN

DUAL MAIN IN UTILITY EASEMENT