

Escalated Cable Replacement
 9760 102nd Pl N, Maple Grove
 Feeder. OSS073/ A/7.97Kva

Directional Bore. Bore in 2500' of #2 al 1 phase cable from
 M70 to D3, D3 to E3, E3 to F3, F3 to G3, G3 to H3
 H3 to J3, H3 to L3

Terminations. 14 terminations at M70, D3, E3, F3, G3, H3, J3, K3, L3
 Replace Xfmrs and basements At all transformers

Restorations.

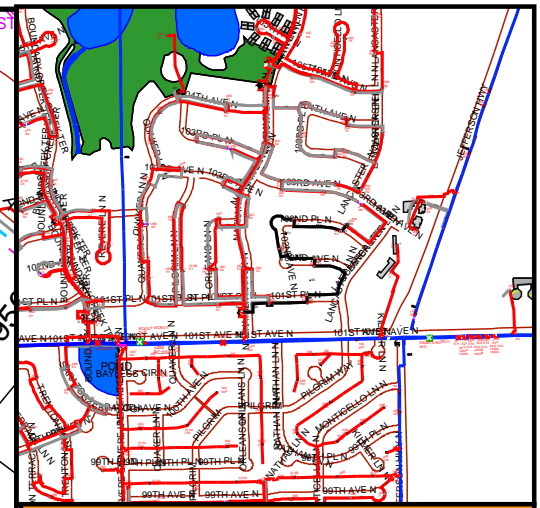
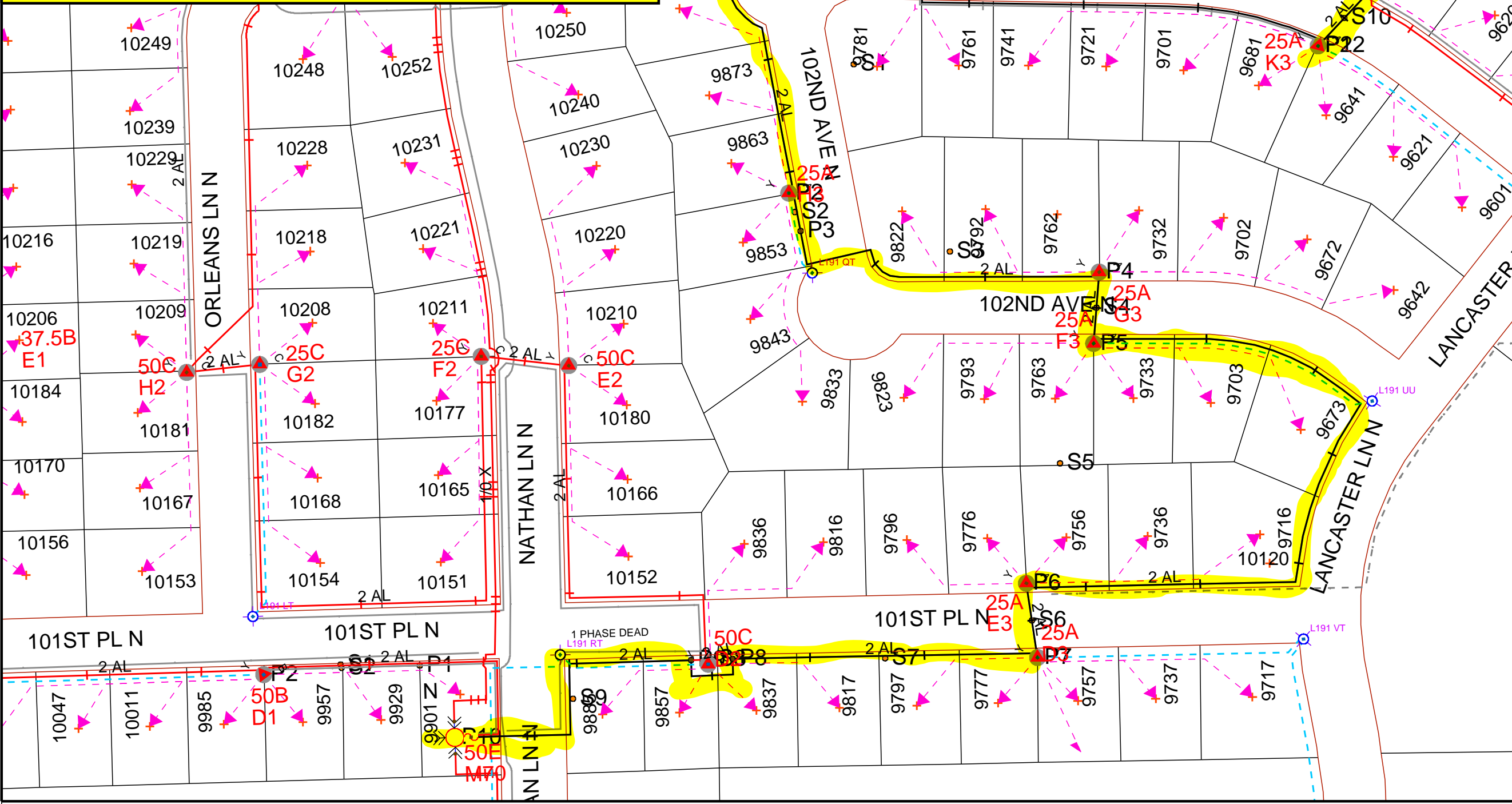

Brad Lylum
 O (651)-229-5517

Work Order Information	
Service Request #	:
Design Number	: 000000775830
Designer/Planner ID	: 233210
Designer/Planner Name	: Brad Lylum
Designer/Planner Ph #	: (651) 229-5571
Manager Approval	:

Joint Utility	
E:	G:
T:	C:

Design Location	
Division	: Maple Grove
County	: Hennepin
City	: Maple Grove
Address	: 9760 102nd Pl N.
T:	119N R: 22W S: 1
Map #	: L51091 Permit :

Electric	
Feeder	: See Notes Voltage: See Notes
Phase	: See Notes Bkup Dev ID:

Gas	
System	: Pressure :
Size	: Material :
Dead End	:

Work Order # :
 Date: 05/21/2018
 Sketch: # Of # Sketch Data
 Scale: 1" equals 120'

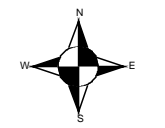

CONSTRUCTION USE ONLY	
<input type="checkbox"/>	NO CHANGES (BUILT AS DESIGNED)
<input type="checkbox"/>	CHANGES MADE AS INDICATED (ALL URD MUST HAVE ACTUAL MEASUREMENTS FROM THE FIELD SITE)

RFO
 FOREMAN _____ DATE _____
 TEAM LEADER _____

DISCLAIMER: THERE ARE NO REPRESENTATIONS OR WARRANTIES (EXPRESS OR IMPLIED) ABOUT THE ACCURACY OF THIS PRINT. THIS PRINT IS PROVIDED WITH NO CLAIM AS TO PRINT COMPLETENESS, TIMELINESS, ACCURACY OF CONTENT OR USEFULNESS. STATE LAW REQUIRES ANYONE DIGGING, GRADING OR EXCAVATING TO OBTAIN A PRIOR FIELD LOCATE OF ALL UTILITIES; THIS PRINT DOES NOT DISCHARGE THIS REQUIREMENT OR ANY OTHER REQUIREMENT. THE COMPANY AND ITS AFFILIATES ASSUME NO LEGAL RESPONSIBILITY OR LIABILITY FOR THE RECIPIENT'S USE (OR ANY OTHER PARTIES' USE) OF THE PRINT, INCLUDING THE RECIPIENT'S INTENDED PURPOSE IN USING THE PRINT. NO COMPANY EMPLOYEE OR OTHER PARTY HAS BEEN AUTHORIZED TO PROVIDE THIS PRINT FOR PLANNING OR ESTIMATING PURPOSES; RELY ON THIS PRINT AT YOUR OWN RISK. BY ACCEPTING THIS PRINT, THE RECIPIENT & ANY OTHER PARTY RECEIVING A COPY OF THE PRINT ACKNOWLEDGES AND AGREES TO THIS DISCLAIMER. For All Field Locates Call 811