

NOTE: BORE ALL PAVED STREETS AND DRIVEWAYS
 Minimum depth requirements for crossings of state highways and county roads is 60".
 Minimum depth requirements for crossings of city streets and township roads is 48".
 Minimum depth for parallel installations on state highways and county roads is 36".
 Minimum depth for parallel installations on city streets and township roads is 30".
 All steel pipe welds to be coated with 2 part epoxy.

INSTALL 2" PE CL-6
 @ 48' NCL 96 AVE N IN 10' EASEMENT NF99-4

C = INSTALL 2" PE CAP TO COVER SERVICE WHILE LEAVING A 5' STUB S

Install; Clean and Test; and Put in Service; Proposed new main per CenterPoint Energy Construction and Service Manual.

Purge new main until essentially 100% gas reading is obtained on Combustible Gas Indicator. See CenterPoint Energy Construction and Service Manual Section CS-B-1.230 for purging mains into service.

Install a marker ball at a new end of main, at a valve, at each ell of a horizontal offset, at road crossings and at any fitting or pressure control identified as needing to be located in the future. Refer to CenterPoint Energy Construction and Service Manual section CS-B-1.310 for installation procedures.

I hereby certify that this plan, specification, or report was prepared by me or under my direct supervision and that I am a duly Licensed Professional Engineer under the laws of the state of Minnesota.

Signature: Casey Tollefson

Typed or Printed Name: Casey Tollefson

Date: 4/10/18 License Number: 52693

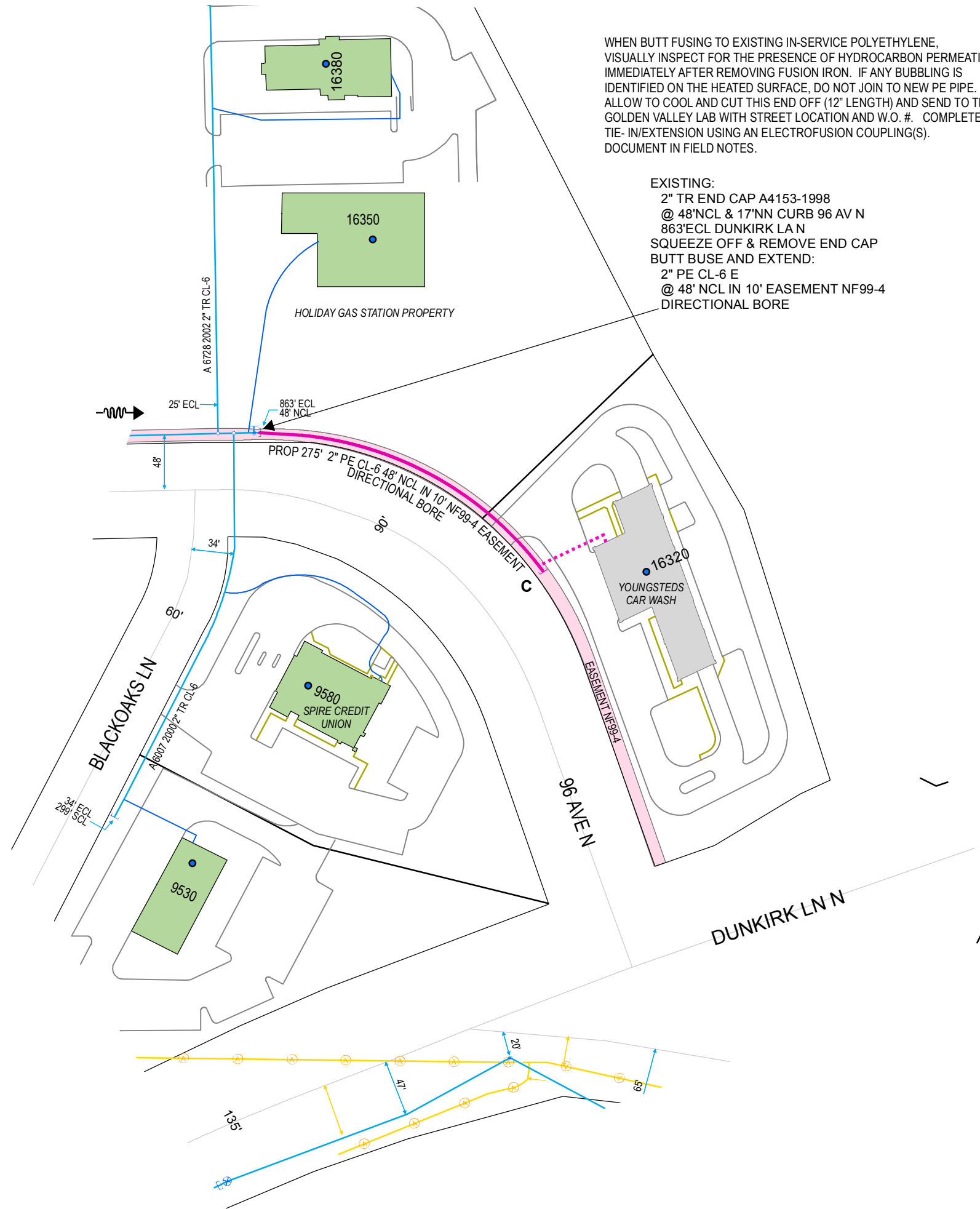

MINNESOTA REGION
 PROPRIETARY AND CONFIDENTIAL

PROJECT #: **85595589**

M52900 MAPLE GROVE

ONE CALL:
 Hennepin
 *SE8 T119/R22
 * = this Page

LEGEND:
 — ACTIVE MAIN
 — DESIGNED MAIN
 - - - PROPOSED ABANDONED/
 OUT OF SERVICE MAIN
 ○ ABANDONED/
 OUT OF SERVICE MAIN

PIPE REQUIRED:
 275' 2" PE CL-6
 275' PIPE

PROPOSED ABANDONED PIPE:

COPIES:
 PIPELINE INTEGRITY PACKET: N
 GAS VALVE: N
 DD NUMBER: N
 CORROSION: N
 EMP: N

FOLLOW INTERNAL PIPE SAMPLING REQUIREMENTS? N
 SURVEYOR REQUIRED? N
 RETURN PACKET TO ENG? N
 GFIP#: N
 PERMITS: MAPLE GROVE

PROJECT DESCRIPTION: NBCO
 YOUNGSTEDTS CAR WASH

DESIGNER: Wendy Kronwall
 PHONE #: 612-321-5508
 DRAWN BY: Wendy Kronwall
 DESIGN DATE: 4/6/2018

REVISION INFO:

Main
 SCAN DATE: SCALE 1" = 100'
 SHEET 1 OF 1

4/9/2018 10:35:36 AM DESIGNER EXPRESS DESIGN