

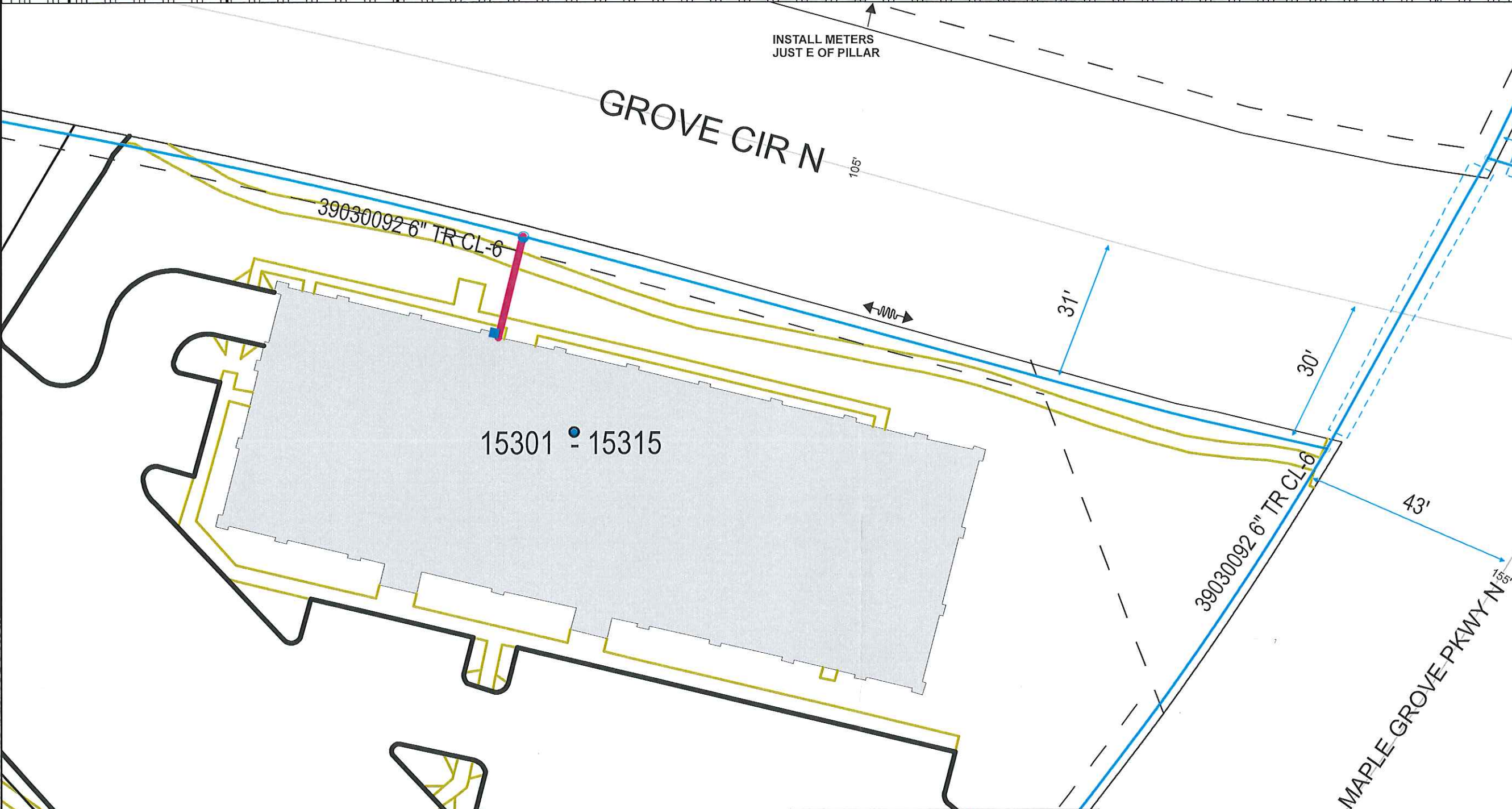

PROPRIETARY AND CONFIDENTIAL

79280914
M52900 MAPLE GROVE

ONE CALL:
Hennepin
*NW9 T119/R22
* = this Page



- LEGEND:
- ACTIVE
 - DESIGNED
 - PROPOSED
 - - - ABANDONED
 - A ABANDONED

- Interruptible
- Existing
- Normal
- Future
- Proposed

Address: 15301 Grove Cir N, Maple Grove
 Customer: Park Nicollet at The Grove
 Contact Person: Dave Brouhard
 Contact Phone: 612-369-3803
 Sales Rep: Melissa Lisher
 Sales Rep Phone: 612-321-4381
 Construction Hotline: 612-321-5310
 Copies To Pipeline Integrity: No
 Customer Service Valve: No
 Copies to Corrosion: No
 Corrosion Approval: No
 Follow Internal Pipe Sampling Requirements? No
 GFIP#: NA
 Permits: City
 Requested Install Date: 8/18/16

Approval: *Ben Smith 8/15/16*

PROJECT DESCRIPTION:
Park Nicollet at The Grove

DESIGNER: John Miller
 PHONE #: 612-321-5231
 DRAWN BY: John Miller
 DESIGN DATE: 8/15/2016

Revised Print
 Destroy All Others
 Revision History
 Date:
 Description:
 Design Approval:

IC Services
 SCAN DATE: 1" : 40'
 SHEET 1 OF 1

CUSTOMER APPROVAL OF DESIGN I/C:
 SIGNATURE: _____ DATE: _____
 PRINTED NAME: _____
 EMAIL: _____
 Please review Center Point Energy design for installing Natural Gas to your facility. Verify the route of the Service Line and Meter Location on the building. If there is a conflict please contact the Designer or Sales Rep as shown in the Title Block.

79280914 - Install New Service Line - Plastic - CSV
 INSTALL: 6" X 1-1/4" IPS PE SVC TEE W/ 3/4" TAP
 INSTALL 40' OF 1-1/4" IPS PE CL-6 SVC LINE
 W/ 1-1/4" MPT x 1-1/4" IPS ANODELESS RISER W/ BYPASS, W/SLEEVE
 EQUIPMENT# 60572577
 TAP LOCATION IS APPROX 90' SE OF NWBL

79181602 - Install New Measurement Station - CSV
 INSTALL 425TC/630TC 2-FIT ERT'D OSM'S (CL-6) (LOAD: 1,638 CFH)
 W/ 1-1/4" 1813C REG @ 2PSI W/ 3/16" ORIFICE
 METER M/I WO# 79280817/79282505
 EQUIPMENT# 14865295

DESIGNER EXPRESS DESIGN
8/15/2016 1:54:39 PM