



MCI metro

ACCESS TRANSMISSION SERVICES CORP
D/B/A VERIZON ACCESS TRANSMISSION
OUTSIDE PLANT CONSTRUCTION
FIBER OPTIC CABLE ROUTE

GUSHERS

SITE CODE: HENNMN

BH06 / GOLDEN VAL-VICKSBURG / 074GUSHERS
MAPLE GROVE, MN

PROJECT STATUS: ISSUED FOR PERMITTING
STATUS DATE: 3/23/18



PROJECT: 074GUSHERS

BH06 / GOLDEN VAL-VICKSBURG

MAPLE GROVE, MN

CLARIFICATION NO.	QUANTITY

DATE: 2/8/18

ENGINEER: NW

DRAWN BY: NW

REVISIONS

DATE	DESCRIPTION	INITIAL
2/8/18	CONST PKG	NW
3/23/18	QC	SJH

EXCEPT AS MAY BE OTHERWISE PROVIDED BY CONTRACT, THESE DRAWINGS AND SPECIFICATIONS SHALL REMAIN THE PROPERTY OF MCI COMMUNICATIONS SERVICES, INC., BOTH BEING ISSUED IN STRICT CONFIDENCE AND SHALL NOT BE REPRODUCED, COPIED, OR USED FOR ANY PURPOSE WITHOUT SPECIFIC WRITTEN PERMISSION.

SCALE

HORIZONTAL: NTS

VERTICAL: NTS

MP _____ TO MP _____

SHEET 5 OF 19

FILE: 074GUSHERS.DWG

MCI metro
ACCESS TRANSMISSION SERVICES, LLC

OUTSIDE PLANT CONSTRUCTION

TITLE: FIBER OPTIC CABLE ROUTE

074GUSHERS

GENERAL NOTES

1. VERIZON BUSINESS COMPRISES THE FOLLOWING OPERATING ENTITIES:

- MCI COMMUNICATIONS SERVICES, INC.
- MCI METRO ACCESS TRANSMISSION SERVICES, LLC
- MCI METRO ACCESS TRANSMISSION SERVICES OF VIRGINIA, INC.
- MCI METRO ACCESS TRANSMISSION SERVICES OF MASSACHUSETTS, INC.
- METROPOLITIAN FIBER SYSTEMS OF NEW YORK, INC.

2. ALL WORK TO BE PERFORMED IN STRICT ACCORDANCE WITH THE APPLICABLE CODES OR REQUIREMENTS OF ANY REGULATING GOVERNMENTAL AGENCY, VERIZON BUSINESS AND THE RIGHT-OF-WAY GRANTOR.

3. LOCATIONS OF SOME OF THE PHYSICAL FEATURES WERE OBTAINED FROM DATED RAILROAD EVALUATION MAPS OR OTHER DRAWINGS AND MAY NOT BE AS SHOWN OR DEPICTED ON THESE DRAWINGS.

4. UNDERGROUND UTILITIES HAVE BEEN PLOTTED FROM AVAILABLE RECORDS AND FIELD OBSERVATIONS BUT ARE NOT NECESSARILY EXACT. THEREFORE, UTILITY LOCATIONS WILL BE VERIFIED AT LEAST 100 FEET IN ADVANCE OF TRENCHING OR PLOWING, SO THAT CHANGES IN CABLE PLACEMENT CAN BE MADE IN THE EVENT OF CONFLICT.

5. ANY AND ALL IMPROVEMENTS, SUCH AS ASPHALT OR CONCRETE PAVEMENT, CURBS, GUTTERS, WALKS, DRAINAGE DITCHES, EMBANKMENTS, SHRUBS, TREES, GRASS SOD, ETC., IF DAMAGED, SHALL BE RESTORED TO ORIGINAL CONDITION.

6. EQUIPMENT TYPES SPECIFIED HEREIN (IE: "BACKHOE", SWAMP PLOW" ETC.) ARE SUGGESTIONS ONLY AND ARE NOT INTENDED AS REQUIREMENTS.

7. SHORING OF EXCAVATIONS AND TRENCHES IN ACCORDANCE WITH OSHA REGULATIONS IS MANDATORY.

8. BURIED CABLE MARKERS WILL BE PLACED AT ALL UNDERGROUND UTILITY LOCATIONS AND ALL OTHER LOCATIONS IN ACCORDANCE WITH THE CONSTRUCTION DRAWINGS AND THE OUTSIDE PLANT HANDBOOK.

9. ALL 2" ID CONDUIT WILL BE HDPE, OR AS SPECIFIED.

10. UNDERGROUND CONDUIT WILL BE PLACED AT 36" MINIMUM COVER UNLESS OTHERWISE SPECIFIED ON THE CONSTRUCTION DRAWINGS.

CLARIFICATION NOTES

- STATION
- LOCATION
- CLARIFICATION NO. AND MINIMUM COVER
- QUANTITY LINEAR FOOTAGE/SQUARE FOOTAGE, SIZE OF MANHOLE/HANDHOLE SIZE OF PULL/SPLICE BOX, DIMENSION OF WALL, HEIGHT/CLASS/TYPICAL POLE
- TYPICAL DRAWING NO. AND TYPICAL DETAIL DRAWING NUMBER
- PLANT ACCOUNTING CODE
- SPECIFIED CONDUIT, HANDHOLE/MANHOLE NO., SPECIFIED PURPOSE AND MATERIAL, BRIDGE NO. AND RAILROAD STATION, MATERIAL, POLE NO.

1.
2.
3.
4.
5.
6.
7.

ADDENDUM NOTES

CLARIFICATION NOTES (CONTINUED)

100	110	JACK AND DRY BORE CONDUIT(S)
200	210	PLACE CONDUIT
	212	PLACE HIGH DENSITY POLYETHYLENE (HDPE)
	213	ROCK ADDER
	214	SLURRY BACKFILL ADDER
	215	EXPOSE CONDUIT
	216	EXPOSE COMDUIT AND RELOCATE
	217	EXPOSE CONDUIT AND REPLACE/SUBSTITUTE
	218	EXPOSE AND REMOVE CONDUIT
	219	EXPOSE AND REMOVE CONDUIT (ABANDONED)
	220	CONCRETE ENCASE
	221	REMOVE CONCRETE ENCACEMENT
	222	REMOVE CONCRETE CAP
	240	PLACE HANDHOLE
	244	REMOVE EXISTING HANDHOLE
	245	RELOCATE HANHOLE
		REPLACE/SUBSTITUTE HANDHOLE
	247	EXCAVATE SPLICE PIT
	250	PLACE MANHOLE
	252	REMOVE EXISTING MANHOLE
	255	RELOCATE PRECAST MANHOLE
	256	REPLACE/SUBSTITUTE PRECAST MANHOLE
	260	CONSTRUCT WALL
	270	REMOVE AND RESTORE ASPHALT
	280	REMOVE AND RESTORE CONCRETE
	281	REMOVE AND RESTORE SIDEWALK
	282	REMOVE AND RESTORE CURBING
300	310	ATTACH CONDUIT TO WALL OR STRUCTURE
	315	DETACH CONDUIT FROM WALL OR STRUCTURE
	320	CORE BORE
	330	ATTACH PULL/SPLICE BOX TO WALL OR STRUCTURE
400	410	PULL CABLE
	411	PULL THROUGH DUCT (INNERDUCT)
	415	REMOVE CABLE FROM CONDUIT
	420	REPOSITION ACTIVE CABLE SLACK
500	510	DIRECT BURY CABLE
	515	EXPOSE DIRECT BURIED CABLE
	516	EXPOSE DIRECT BURIED CABLE AND RELOCATE
	517	REMOVE AND DISPOSE OF CABLE
	520	PLACE AERIAL CABLE
	525	RELOCATE AERIAL CABLE
	526	DELASH AERIAL CABLE
	527	RELASH AERIAL CABLE
	528	REMOVE AERIAL CABLE
	530	PLACE POLE/PUSH BRACE
	535	REMOVE POLE/PUSH BRACE
600	610	JETTING CONDUIT
	620	EMBEDMENT PLOW
	630	DIRECTIONAL BORE
700	710	PLACE BURIED CABLE MARKERS AND SIGNS/MWCOM WATER CROSSING SIGNS
	711	PLACE ISOLATOR/PROTECTION SYSTEM AT EXISTING HANDHOLES/MANHOLE
	712	REMOVE BURIED CABLE MARKER POST/HARDWARE
	714	REMOVE CONCRETE BURIED CABLE MARKER POST

GENERAL NOTES

- CONTRACTOR MUST OBTAIN LOCATES PRIOR TO DISTURBING THE GROUND.
- CONTRACTOR MUST HAVE A COPY OF THE APPROVED PERMIT FROM THE APPROPRIATE AGENCY ON THE JOBSITE AT ALL TIMES.
- ALL CABLE WILL BE PLACED AT STANDARD MINIMUM DEPTH. (MCI STANDARD IS 48" DEEP UNLESS OTHERWISE DIRECTED BY A MCI REPRESENTATIVE.)
- ANY LANDSCAPING WILL BE REPLACED TO EQUAL OR BETTER THAN THAT WHICH EXISTED PRIOR TO WORK.
- PROJECT SITE WILL BE PROPERLY SECURED PRIOR TO THE END OF EACH DAY.
- ALL WORK IS TO BE IN ACCORDANCE WITH ALL AUTHORITIES HAVING JURISDICTION IN THE WORK ZONE.
- CONTRACTORS ARE ADVISED TO CONTACT MCI FOR ANY ADDITIONAL INFORMATION OR CLARIFICATION CONCERNING SCOPE OF WORK OR THE REQUIREMENTS NECESSARY FOR PROJECT COMPLETION.
- CONTRACTOR IS RESPONSIBLE TO FIELD VERIFY ALL DIMENSIONS, QUANTITIES AND EXISTING CONDITIONS PRIOR TO CONSTRUCTION. IF A SIGNIFICANT CHANGE TO THE RUNNING LINE IS NEEDED, PLEASE CONTACT YOUR MCI REPRESENTATIVE BEFORE PROCEEDING.
- BEFORE CONSTRUCTION BEGINS, CONTRACTOR SHALL TAKE APPROPRIATE PRECAUTIONS TO AVOID ANY POTENTIAL OBSTRUCTIONS PRIOR TO PROCEEDING WITH WORK.
- NO CONSTRUCTION ON PRIVATE PROPERTY WILL COMMENCE UNTIL APPROVAL IS GIVEN BY THE APPROPRIATE MCI EMPLOYEE.
- CONTRACTOR SHALL NOT PROCEED WITH WORK UNTIL THEY HAVE RECEIVED A PURCHASE ORDER AND HAVE BEEN DIRECTED TO DO SO BY AN AUTHORIZED MCI REPRESENTATIVE.
- CONTRACTOR SHALL NOT EXCEED THE PURCHASE ORDER VALUE WITHOUT AUTHORIZATION IN WRITING FROM THE APPROPRIATE MCI REPRESENTATIVE.
- AS-BUILTS WILL BE REQUIRED FOR EACH PROJECT INCLUDING CABLE FOOTAGE SEQUENTIALS AT EVERY ACCESS POINT, SLACK LOOP, SPLICE LOCATION, POLE AND TERMINATION POINT. CONTRACTOR SHALL PROVIDE NOTES OF ALL CHANGES IN DEPTHS, RUNNING LINES, MH/HH LOCATIONS, AND ANY OTHER APPLICABLE NOTES TO DEPICT THE WORK THAT TOOK PLACE. NOTE: ALL MAJOR CHANGES NEED TO BE PRE-APPROVED BY AN AUTHORIZED MCI EMPLOYEE PRIOR TO STARTING THE WORK.
- THE SUBSURFACE UTILITY INFORMATION IN THIS PLAN IS UTILITY QUALITY LEVEL D. THIS UTILITY QUALITY LEVEL WAS DETERMINED ACCORDING TO THE GUIDELINES OF CI/ASCE 38-02, ENTITLED STANDARD GUIDELINES FOR THE COLLECTION AND DEPICTION OF EXISTING SUBSURFACE UTILITY DATA. IT SHALL BE THE CONTRACTORS RESPONSIBILITY TO UTILIZE THE GOPHER STATE ONE CALL EXCAVATION NOTICE SYSTEM REQUIRED MN STATUTE, CHAPTER 216D FOR ALL UNDERGROUND UTILITY LOCATIONS.

CLARIFICATION SUMMARY SHEET PROJECT SPECIFIC



PROJECT: 074GUSHERS

BH06 / GOLDEN VAL-VICKSBURG

MAPLE GROVE, MN

PROJECT CLARIFICATION SUMMARY				
DESCRIPTION	QUANTITY	UNITS	CLARIFICATION NUMBER	CLARIFICATION NO. AND ALPHA
C-100: NEW UNDERGROUND - BORE/TRENCH/PLOW - 1-2" HDPE - SOFTSCAPE	4760	LF	100	C100
C-110: NEW UNDERGROUND - BORE/TRENCH/PLOW - 1-2" HDPE - HARDSCAPE	529	LF	110	C110
C-500: CABLE PREP/SPLICING/TESTING - LOOSE TUBE	48	EA	500	C500

PERMITS REQUIRED			
PERMIT	SHEET NUMBER	FOOTAGE	DATE APPROVED
City of Maple Grove \ Gushers-1	8-19	5209'	

CLARIFICATION NO. QUANTITY

MCImetro
ACCESS TRANSMISSION SERVICES, LLC



OUTSIDE PLANT CONSTRUCTION

TITLE: FIBER OPTIC CABLE ROUTE

074GUSHERS

BOM / MAKE READY COST ESTIMATE PROJECT SPECIFIC

DATE: 2/8/18

ENGINEER: NW

DRAWN BY: NW

REVISIONS

DATE	DESCRIPTION	INITIAL
2/8/18	CONST PKG	NW
3/23/18	QC	SJH

Hub Name		SITE Hub Name	E-300 Footage	E-350 Footage	Existing VZB Owned Fiber	E-355 Footage	E-400 Footage	E-500	E-700	E-800	E-1000	C-100 Footage	C-110 Footage	C-120 Footage	C-200 Footage	C-300 Footage	C-400 Cost Estimate	C-500	C-510	MISC-1
VICKSBURG	TO	GUSHERS	5,289'	0'	0'	0'	0'	0'	0'	\$ -	0'	4,760'	529'	0'	0'	0'	\$0.00	48	0	0
Hand holes 24"x36"x24"	Hand Holes 30"x60"x30"	Manholes 4'x4'x4'	2"HDPE SDR 11 5%	Ground Rods	Locate Test Station	Marker Posts	Storage Loops Footage	Splice Case 600D	Splice Case 450D	864 Fiber 3%	576 Fiber 3%	432 Fiber 3%	288 Fiber 3%	216 Fiber 3%	144 Fiber 3%	96 Fiber 3%	72 Fiber 3%	48 Fiber 3%	24 Fiber 3%	12 PORT MST
0	6	0	5,553	1	1	6	650'	1	0	0'	0'	0'	0'	0'	0'	0'	6,117'	0'	0'	0

EXCEPT AS MAY BE OTHERWISE PROVIDED BY CONTRACT, THESE DRAWINGS AND SPECIFICATIONS SHALL REMAIN THE PROPERTY OF MCI COMMUNICATIONS SERVICES, INC., BOTH BEING ISSUED IN STRICT CONFIDENCE AND SHALL NOT BE REPRODUCED, COPIED, OR USED FOR ANY PURPOSE WITHOUT SPECIFIC WRITTEN PERMISSION.

SCALE

HORIZONTAL: NTS

VERTICAL: NTS

MP _____ TO MP _____

SHEET 7 OF 19

FILE: 074GUSHERS.DWG

MCImetro
 ACCESS TRANSMISSION SERVICES, LLC
 OUTSIDE PLANT CONSTRUCTION
 TITLE: FIBER OPTIC CABLE ROUTE
 074GUSHERS

DATE: 2/8/18

ENGINEER: NW

DRAWN BY: NW

REVISIONS

DATE	DESCRIPTION	INITIAL
2/8/18	CONST PKG	NW
3/23/18	QC	SH

EXCEPT AS MAY BE OTHERWISE PROVIDED BY CONTRACT, THESE DRAWINGS AND SPECIFICATIONS SHALL REMAIN THE PROPERTY OF MCI COMMUNICATIONS SERVICES, INC., BOTH BEING ISSUED IN STRICT CONFIDENCE AND SHALL NOT BE REPRODUCED, COPIED, OR USED FOR ANY PURPOSE WITHOUT SPECIFIC WRITTEN PERMISSION.

SCALE
 HORIZONTAL: 1"=50'
 VERTICAL: 1"=50'
 MP _____ TO MP _____
 SHEET 8 OF 19
 FILE: 074GUSHERS

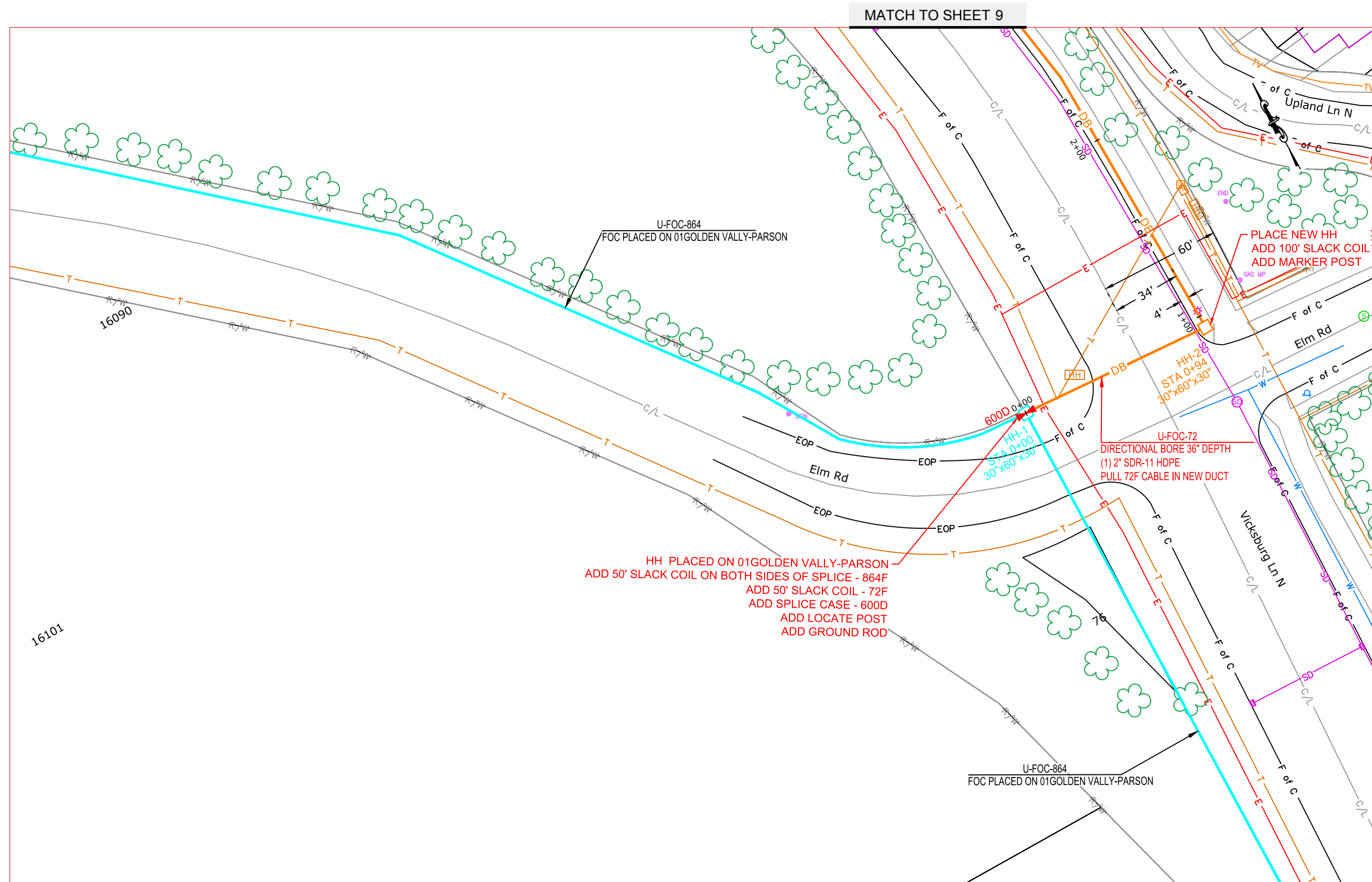



PROJECT: 074GUSHERS

BH06 / GOLDEN VAL-VICKSBURG

MAPLE GROVE, MN

CLARIFICATION NO. QUANTITY

CLARIFICATION NO.	QUANTITY

ACCESS TRANSMISSION SERVICES, LLC



OUTSIDE PLANT CONSTRUCTION

TITLE: FIBER OPTIC CABLE ROUTE

074GUSHERS

DATE: 2/8/18

ENGINEER: NW

DRAWN BY: NW

REVISIONS

DATE	DESCRIPTION	INITIAL
2/8/18	CONST PKG	NW
3/23/18	QC	SJH

EXCEPT AS MAY BE OTHERWISE PROVIDED BY CONTRACT, THESE DRAWINGS AND SPECIFICATIONS SHALL REMAIN THE PROPERTY OF MCI COMMUNICATIONS SERVICES, INC., BOTH BEING ISSUED IN STRICT CONFIDENCE AND SHALL NOT BE REPRODUCED, COPIED, OR USED FOR ANY PURPOSE WITHOUT SPECIFIC WRITTEN PERMISSION.

SCALE

HORIZONTAL: 1"=50'

VERTICAL: 1"=50'

MP TO MP

SHEET 9 OF 19

FILE: 074GUSHERS

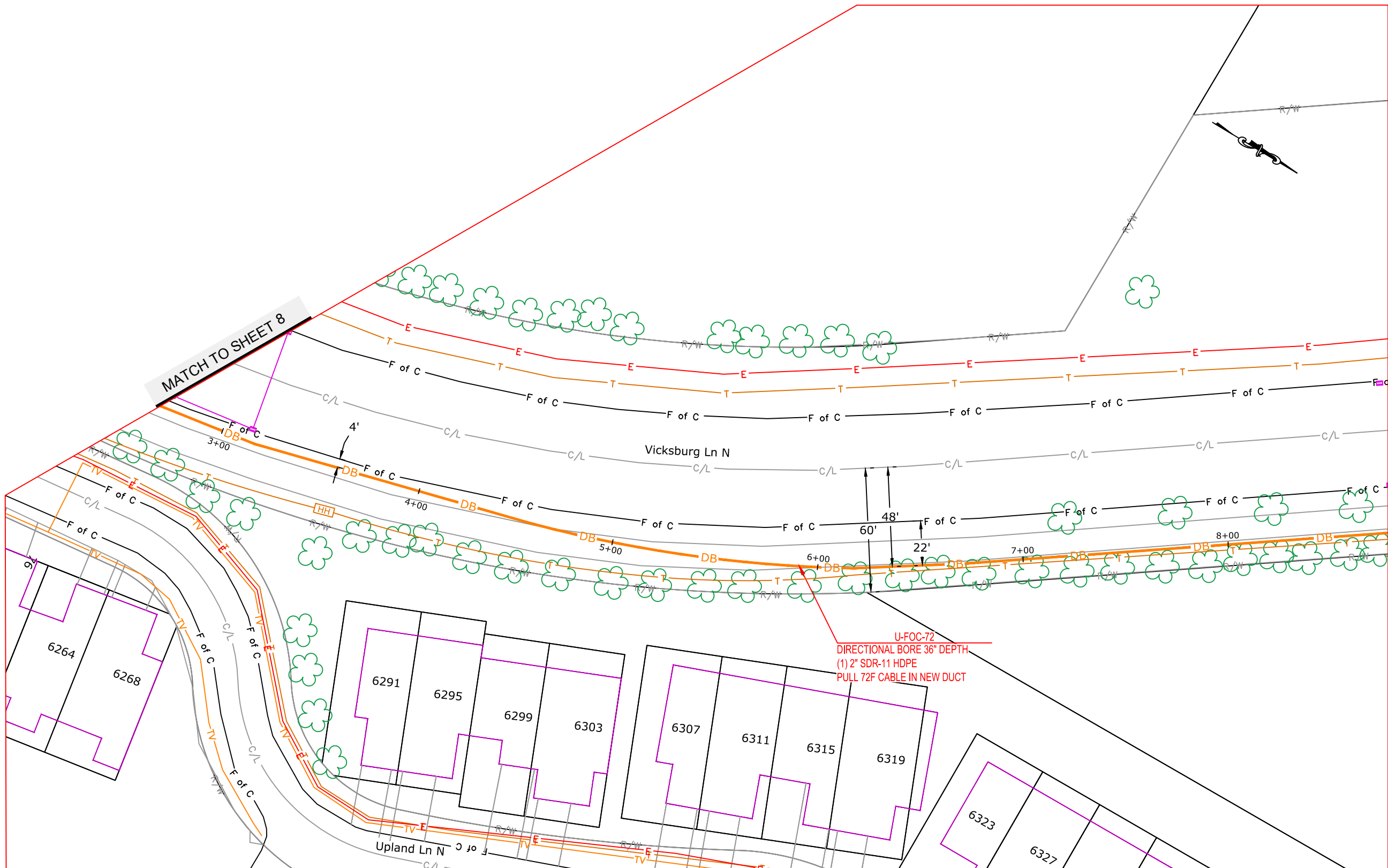

MATCH TO SHEET 8

MATCH TO SHEET 10

6264
6268

6291
6295
6299
6303
6307
6311
6315
6319

6323
6327

U-FOC-72
DIRECTIONAL BORE 36" DEPTH
(1) 2" SDR-11 HDPE
PULL 72F CABLE IN NEW DUCT



PROJECT: 074GUSHERS

BH06 / GOLDEN VAL-VICKSBURG

MAPLE GROVE, MN

CLARIFICATION NO.	QUANTITY

CLARIFICATION NO.	QUANTITY

MCImetro
ACCESS TRANSMISSION SERVICES, LLC

OUTSIDE PLANT CONSTRUCTION
TITLE: FIBER OPTIC CABLE ROUTE
074GUSHERS

DATE: 2/8/18

ENGINEER: NW

DRAWN BY: NW

REVISIONS

DATE	DESCRIPTION	INITIAL
2/8/18	CONST PKG	NW
3/23/18	QC	SJH

DATE	DESCRIPTION	INITIAL

EXCEPT AS MAY BE OTHERWISE PROVIDED BY CONTRACT, THESE DRAWINGS AND SPECIFICATIONS SHALL REMAIN THE PROPERTY OF MCI COMMUNICATIONS SERVICES, INC., BOTH BEING ISSUED IN STRICT CONFIDENCE AND SHALL NOT BE REPRODUCED, COPIED, OR USED FOR ANY PURPOSE WITHOUT SPECIFIC WRITTEN PERMISSION.

SCALE

HORIZONTAL: 1"=50'

VERTICAL: 1"=50'

MP _____ TO MP _____

SHEET 10 OF 19

FILE: 074GUSHERS

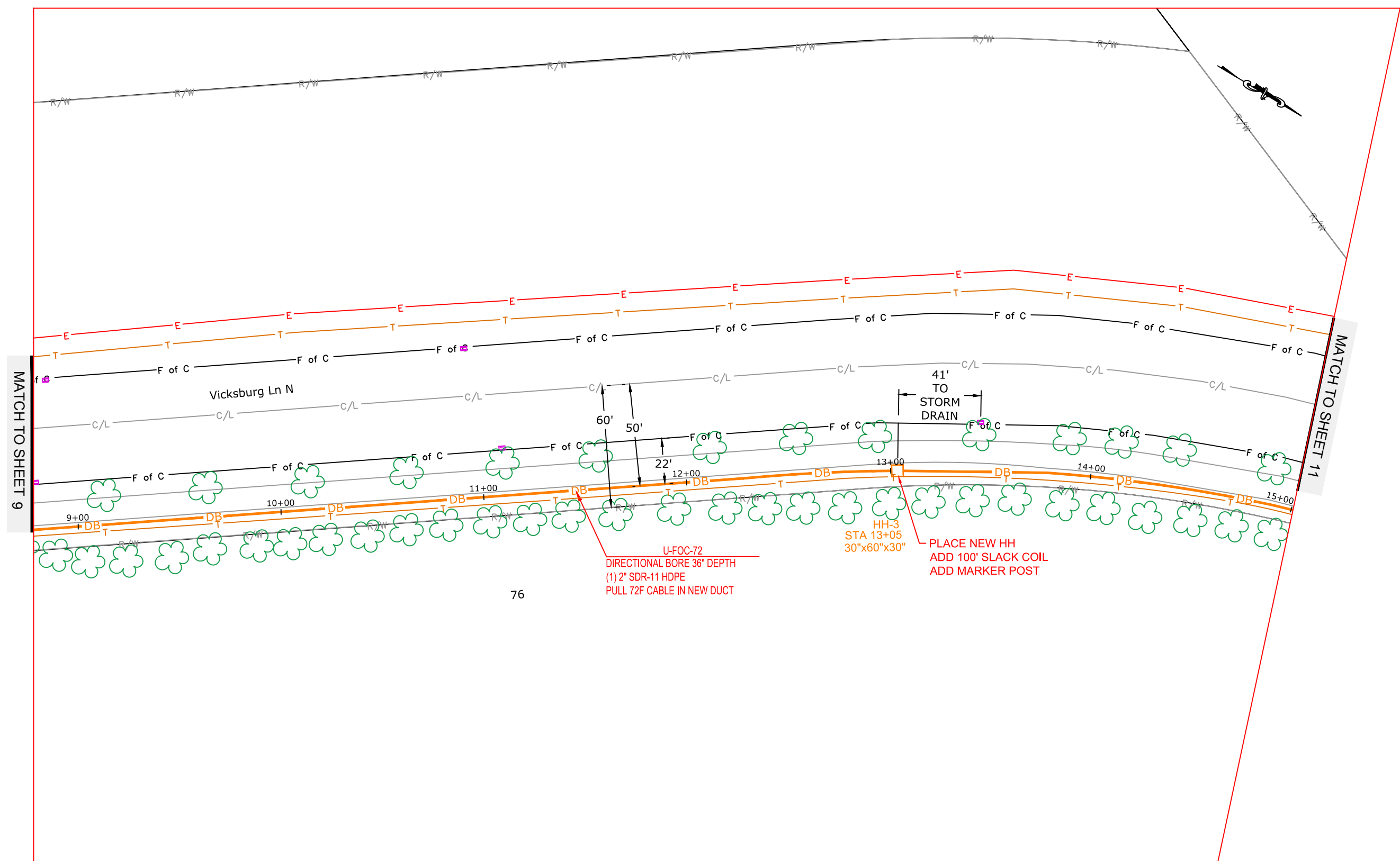

U-FOC-72
DIRECTIONAL BORE 36" DEPTH
(1) 2" SDR-11 HDPE
PULL 72F CABLE IN NEW DUCT

PLACE NEW HH
ADD 100' SLACK COIL
ADD MARKER POST

MATCH TO SHEET 9

MATCH TO SHEET 11

76



PROJECT: 074GUSHERS

BH06 / GOLDEN VAL-VICKSBURG

MAPLE GROVE, MN

CLARIFICATION NO.	QUANTITY

MCImetro
ACCESS TRANSMISSION SERVICES, LLC
OUTSIDE PLANT CONSTRUCTION
TITLE: FIBER OPTIC CABLE ROUTE
074GUSHERS

DATE: 2/8/18

ENGINEER: NW

DRAWN BY: NW

REVISIONS

DATE	DESCRIPTION	INITIAL
2/8/18	CONST PKG	NW
3/23/18	QC	SJH

EXCEPT AS MAY BE OTHERWISE PROVIDED BY CONTRACT,
THESE DRAWINGS AND SPECIFICATIONS SHALL REMAIN
THE PROPERTY OF MCI COMMUNICATIONS SERVICES, INC.,
BOTH BEING ISSUED IN STRICT CONFIDENCE AND SHALL
NOT BE REPRODUCED, COPIED, OR USED FOR ANY PURPOSE
WITHOUT SPECIFIC WRITTEN PERMISSION.

SCALE
HORIZONTAL: 1"=50'
VERTICAL: 1"=50'
MP ____ TO MP ____
SHEET 11 OF 19
FILE: 074GUSHERS

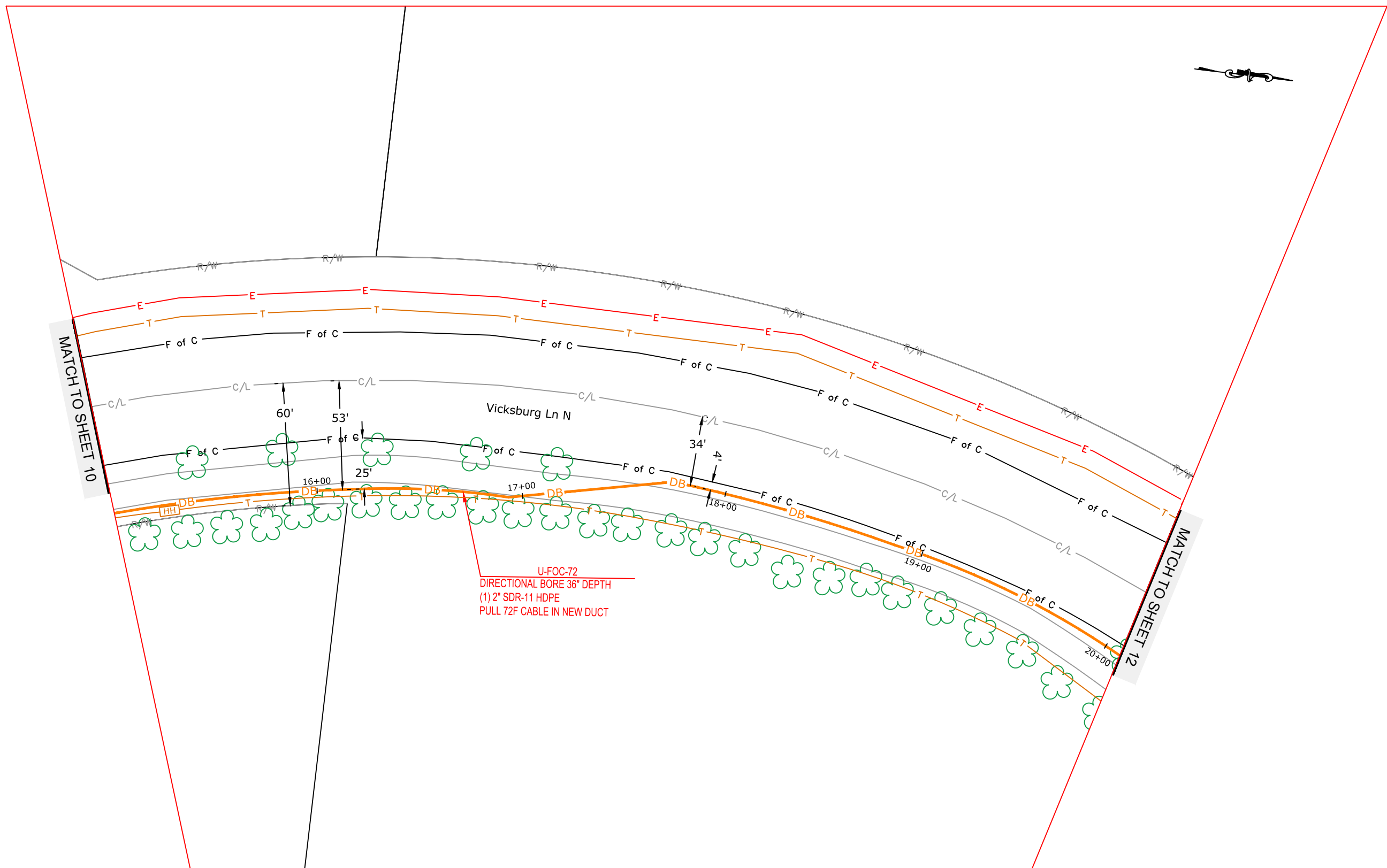



PROJECT: 074GUSHERS
 BH06 / GOLDEN VAL-VICKSBURG
 MAPLE GROVE, MN

CLARIFICATION NO.	QUANTITY

MCI
 ACCESS TRANSMISSION SERVICES, LLC
 OUTSIDE PLANT CONSTRUCTION
 TITLE: FIBER OPTIC CABLE ROUTE
 074GUSHERS

DATE: 2/8/18
 ENGINEER: NW
 DRAWN BY: NW

REVISIONS		
DATE	DESCRIPTION	INITIAL
2/8/18	CONST PKG	NW
3/23/18	QC	SH

EXCEPT AS MAY BE OTHERWISE PROVIDED BY CONTRACT, THESE DRAWINGS AND SPECIFICATIONS SHALL REMAIN THE PROPERTY OF MCI COMMUNICATIONS SERVICES, INC. BOTH BEING ISSUED IN STRICT CONFIDENCE AND SHALL NOT BE REPRODUCED, COPIED, OR USED FOR ANY PURPOSE WITHOUT SPECIFIC WRITTEN PERMISSION.

SCALE

HORIZONTAL: 1"=50'
 VERTICAL: 1"=50'

MP _____ TO MP _____

SHEET 12 OF 19

FILE: 074GUSHERS

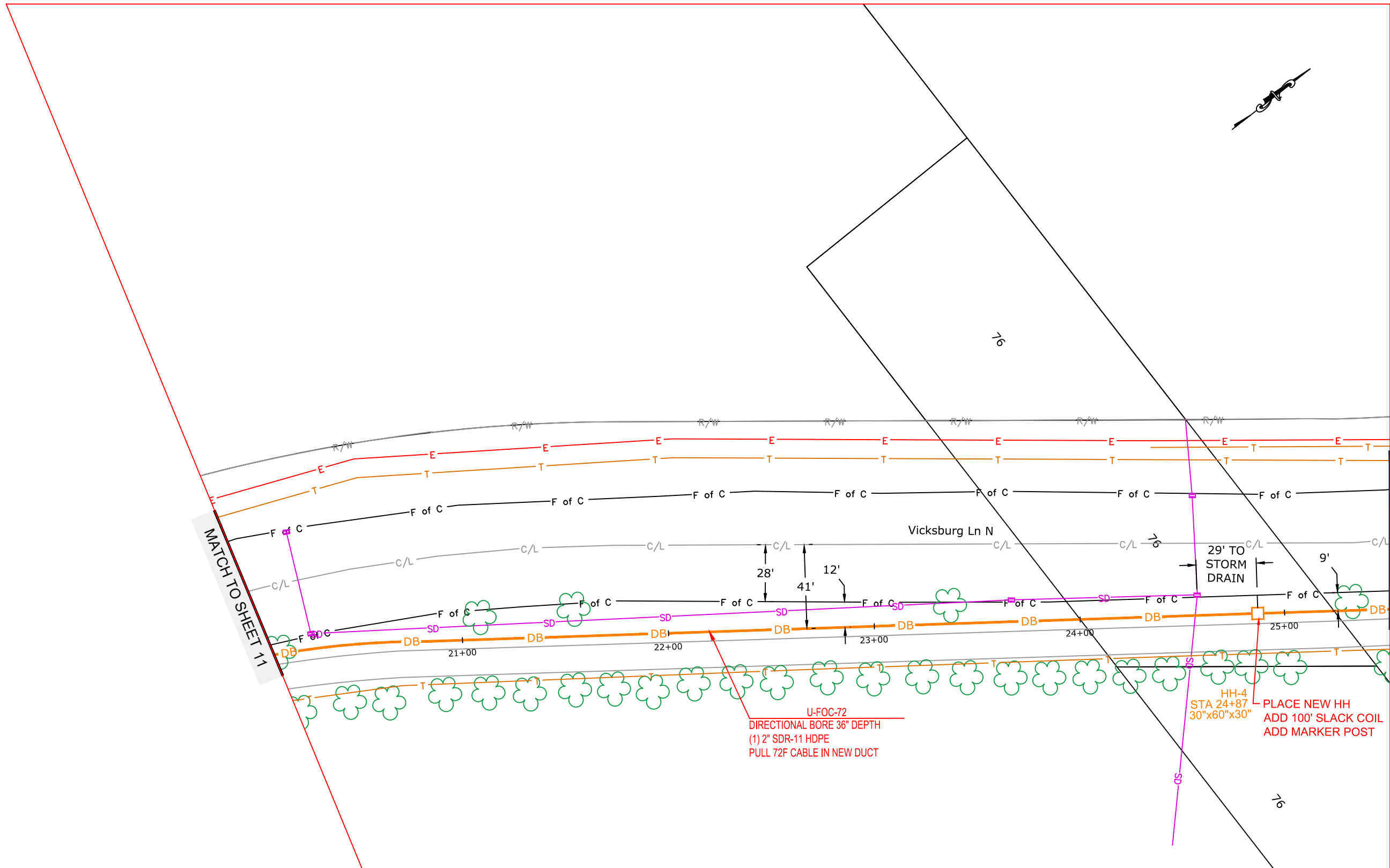



PROJECT: 074GUSHERS

BH06 / GOLDEN VAL-VICKSBURG

MAPLE GROVE, MN

CLARIFICATION NO.	QUANTITY

MCImetro
ACCESS TRANSMISSION SERVICES, LLC



OUTSIDE PLANT CONSTRUCTION

TITLE: FIBER OPTIC CABLE ROUTE

074GUSHERS

DATE: 2/8/18

ENGINEER: NW

DRAWN BY: NW

REVISIONS

DATE	DESCRIPTION	INITIAL
2/8/18	CONST PKG	NW
3/23/18	QC	SJH

EXCEPT AS MAY BE OTHERWISE PROVIDED BY CONTRACT, THESE DRAWINGS AND SPECIFICATIONS SHALL REMAIN THE PROPERTY OF MCI COMMUNICATIONS SERVICES, INC., BOTH BEING ISSUED IN STRICT CONFIDENCE AND SHALL NOT BE REPRODUCED, COPIED, OR USED FOR ANY PURPOSE WITHOUT SPECIFIC WRITTEN PERMISSION.

SCALE

HORIZONTAL: 1"=50'

VERTICAL: 1"=50'

MP TO MP

SHEET 13 OF 19

FILE: 074GUSHERS

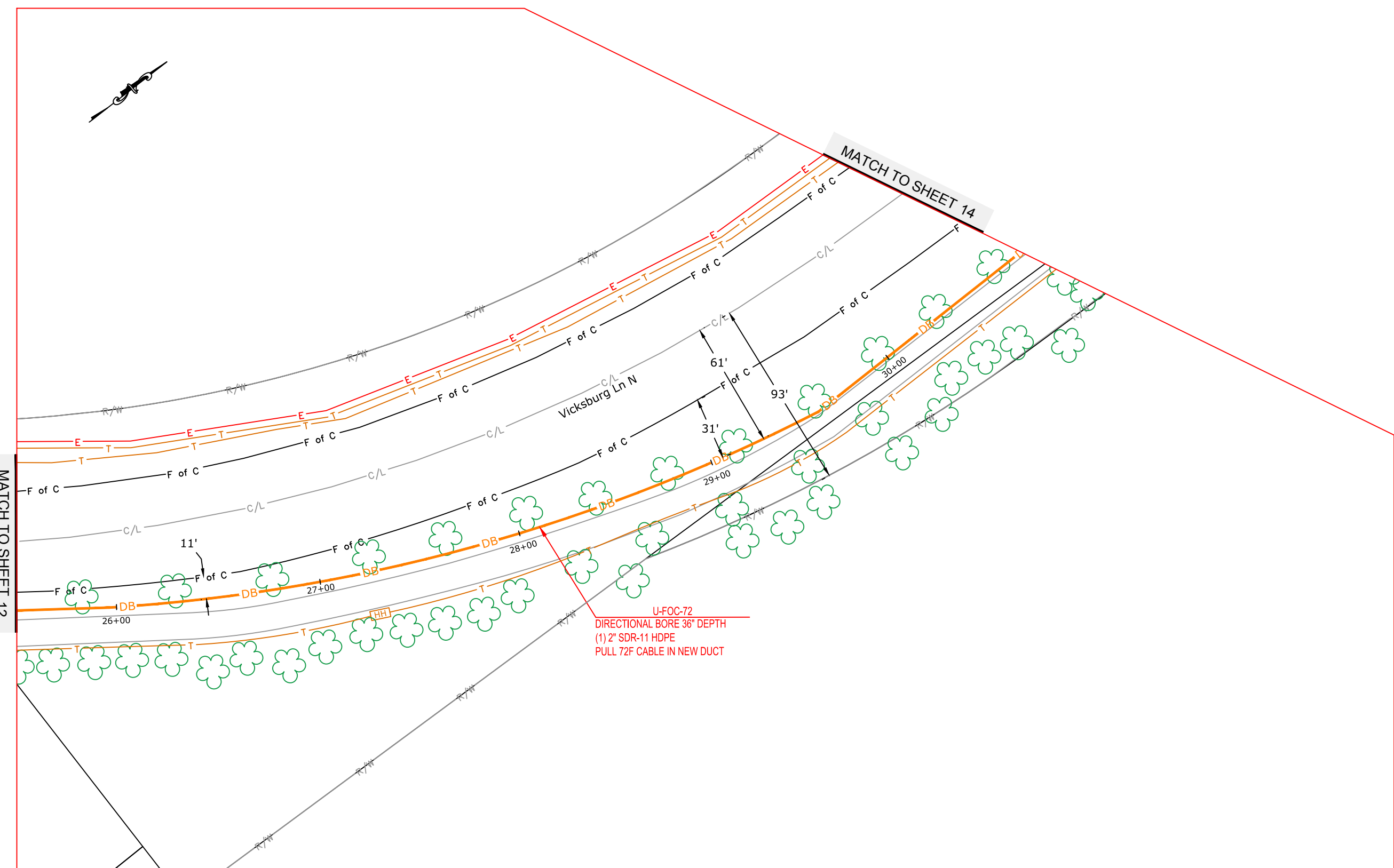



PROJECT: 074GUSHERS

BH06 / GOLDEN VAL-VICKSBURG

MAPLE GROVE, MN

CLARIFICATION NO. QUANTITY

CLARIFICATION NO.	QUANTITY

MCI
ACCESS TRANSMISSION SERVICES, LLC
OUTSIDE PLANT CONSTRUCTION
TITLE: FIBER OPTIC CABLE ROUTE
074GUSHERS

DATE: 2/8/18

ENGINEER: NW

DRAWN BY: NW

REVISIONS

DATE	DESCRIPTION	INITIAL
2/8/18	CONST PKG	NW
3/23/18	QC	SJH

EXCEPT AS MAY BE OTHERWISE PROVIDED BY CONTRACT, THESE DRAWINGS AND SPECIFICATIONS SHALL REMAIN THE PROPERTY OF MCI COMMUNICATIONS SERVICES, INC., BOTH BEING ISSUED IN STRICT CONFIDENCE AND SHALL NOT BE REPRODUCED, COPIED, OR USED FOR ANY PURPOSE WITHOUT SPECIFIC WRITTEN PERMISSION.

SCALE

HORIZONTAL: 1"=50'

VERTICAL: 1"=50'

MP TO MP

SHEET 14 OF 19

FILE: 074GUSHERS

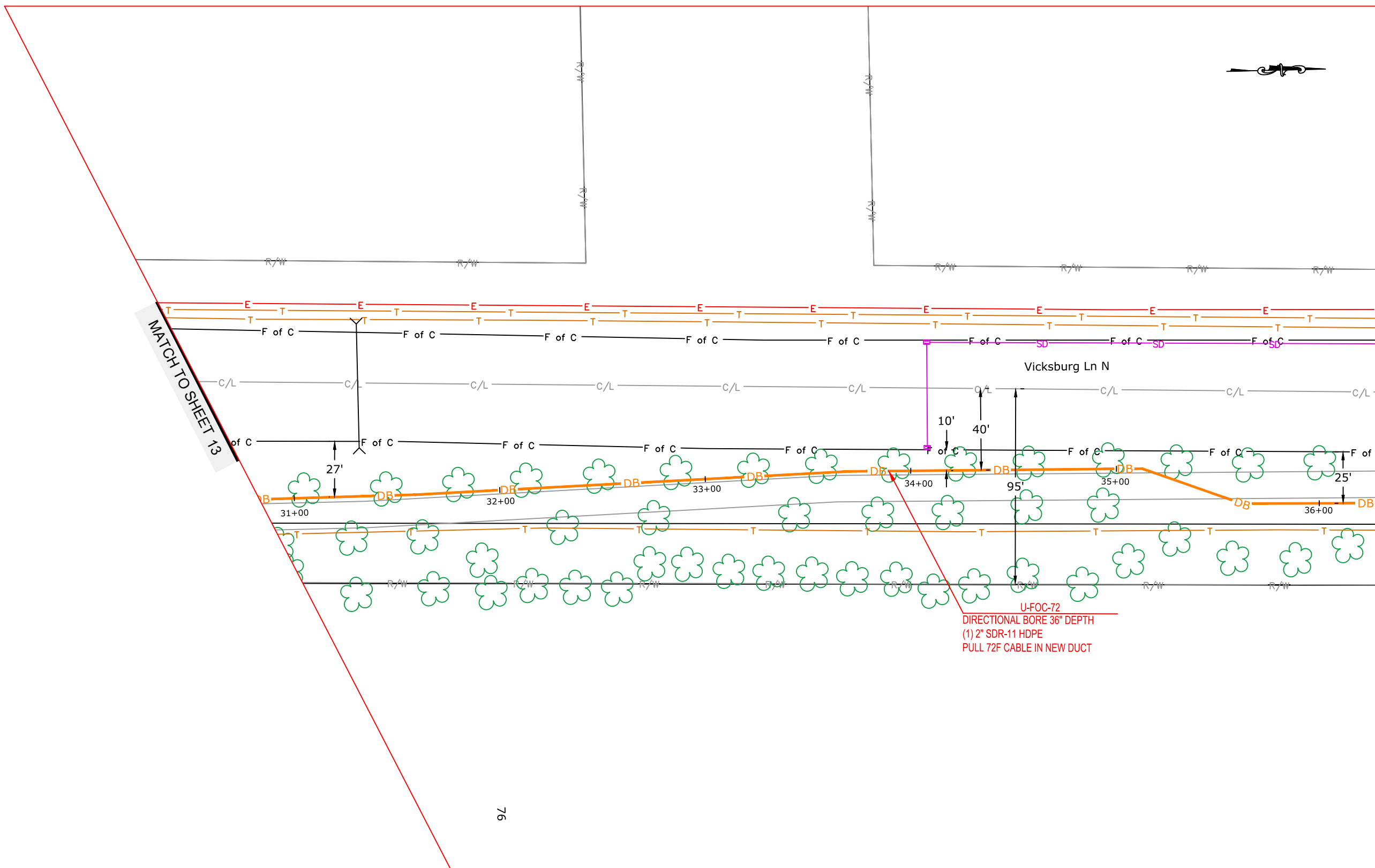

MATCH TO SHEET 13

MATCH TO SHEET 15

U-FOC-72
DIRECTIONAL BORE 36" DEPTH
(1) 2" SDR-11 HDPE
PULL 72F CABLE IN NEW DUCT



PROJECT: 074GUSHERS

BH06 / GOLDEN VAL-VICKSBURG

MAPLE GROVE, MN

CLARIFICATION NO. QUANTITY

MCImetro
ACCESS TRANSMISSION SERVICES, LLC

MCI
OUTSIDE PLANT CONSTRUCTION

TITLE: FIBER OPTIC CABLE ROUTE
074GUSHERS

DATE: 2/8/18

ENGINEER: NW

DRAWN BY: NW

REVISIONS

DATE	DESCRIPTION	INITIAL
2/8/18	CONST PKG	NW
3/23/18	QC	SIJ

EXCEPT AS MAY BE OTHERWISE PROVIDED BY CONTRACT, THESE DRAWINGS AND SPECIFICATIONS SHALL REMAIN THE PROPERTY OF MCI COMMUNICATIONS SERVICES, INC., BOTH BEING ISSUED IN STRICT CONFIDENCE AND SHALL NOT BE REPRODUCED, COPIED, OR USED FOR ANY PURPOSE WITHOUT SPECIFIC WRITTEN PERMISSION.

SCALE

HORIZONTAL: 1"=50'

VERTICAL: 1"=50'

MP TO MP

SHEET 15 OF 19

FILE: 074GUSHERS

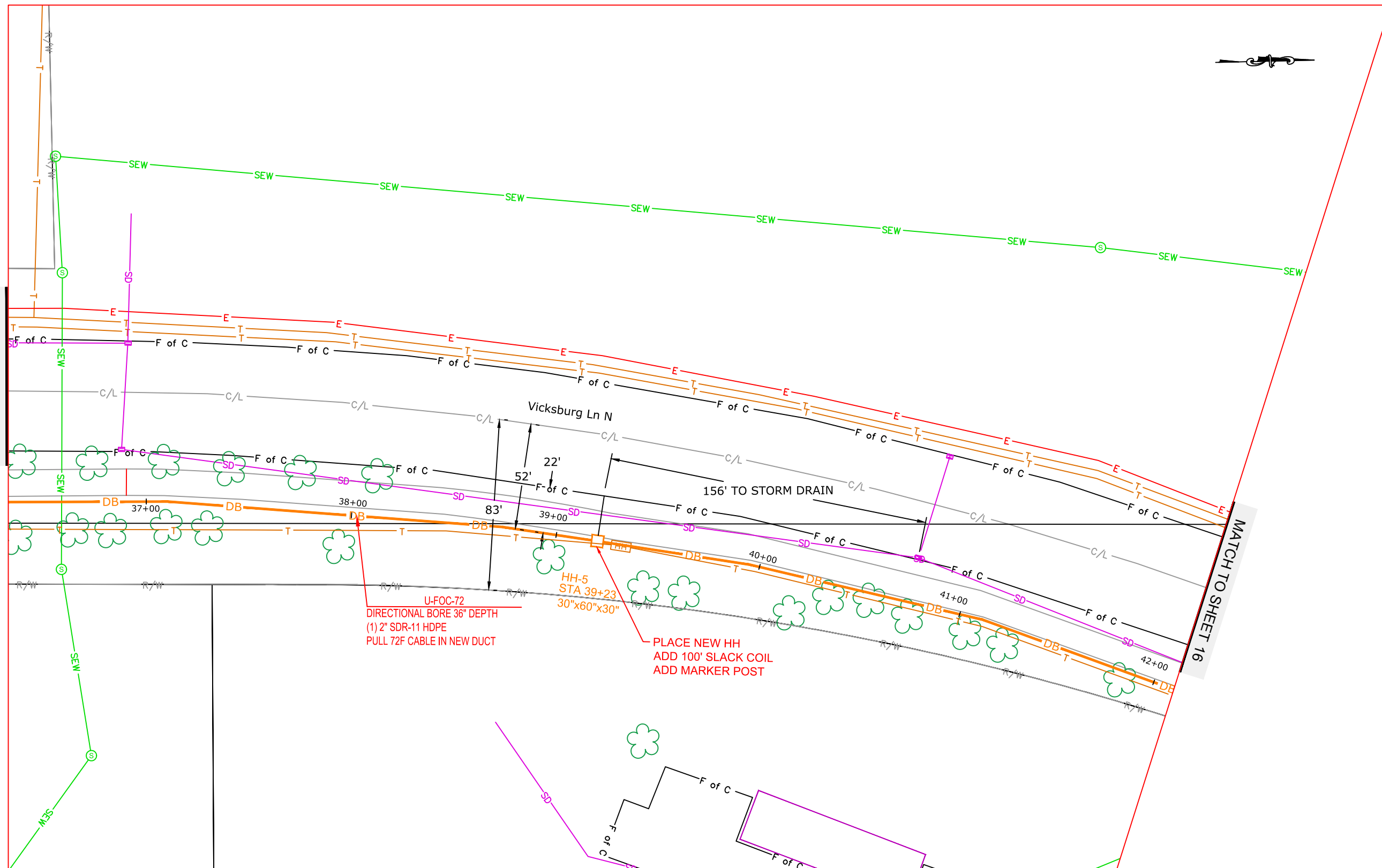

MATCH TO SHEET 14

MATCH TO SHEET 16



PROJECT: 074GUSHERS

BH06 / GOLDEN VAL-VICKSBURG

MAPLE GROVE, MN

CLARIFICATION NO.	QUANTITY

MCI
ACCESS TRANSMISSION SERVICES, LLC

MCI
OUTSIDE PLANT CONSTRUCTION

TITLE: FIBER OPTIC CABLE ROUTE
074GUSHERS

DATE: 2/8/18

ENGINEER: NW

DRAWN BY: NW

REVISIONS

DATE	DESCRIPTION	INITIAL
2/8/18	CONST PKG	NW
3/23/18	QC	SJH

EXCEPT AS MAY BE OTHERWISE PROVIDED BY CONTRACT, THESE DRAWINGS AND SPECIFICATIONS SHALL REMAIN THE PROPERTY OF MCI COMMUNICATIONS SERVICES, INC., BOTH BEING ISSUED IN STRICT CONFIDENCE AND SHALL NOT BE REPRODUCED, COPIED, OR USED FOR ANY PURPOSE WITHOUT SPECIFIC WRITTEN PERMISSION.

SCALE

HORIZONTAL: 1"=50'

VERTICAL: 1"=50'

MP _____ TO MP _____

SHEET 16 OF 19

FILE: 074GUSHERS

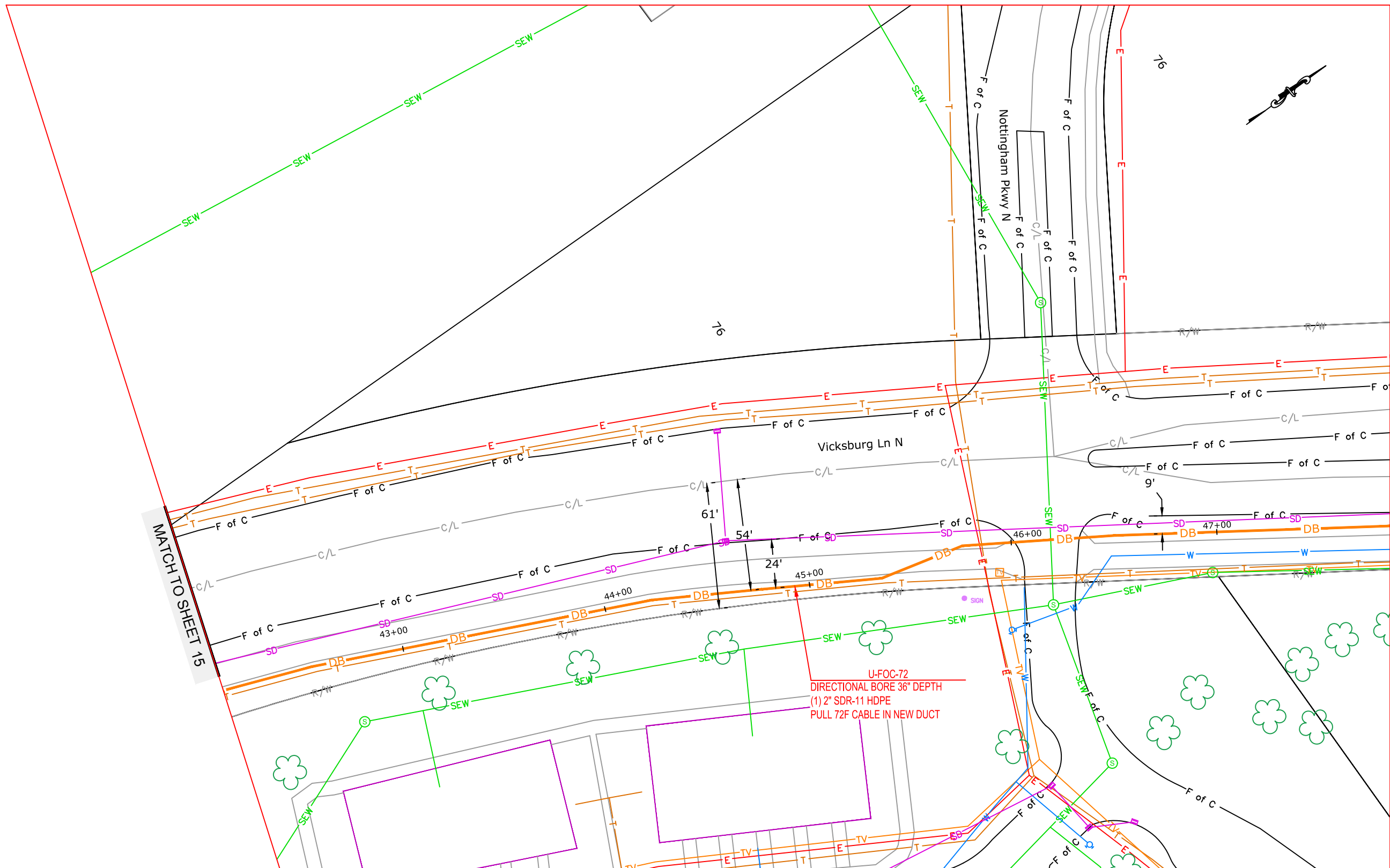

U-FOC-72
DIRECTIONAL BORE 36" DEPTH
(1) 2" SDR-11 HDPE
PULL 72F CABLE IN NEW DUCT

