

| CLARIFICATION NO. | QUANTITY |
|-------------------|----------|
| | |
| | |
| | |
| | |
| | |
| | |
| | |
| | |
| | |
| | |
| | |
| | |
| | |
| | |

MCI
 ACCESS TRANSMISSION SERVICES, LLC
 OUTSIDE PLANT CONSTRUCTION
 TITLE: FIBER OPTIC CABLE ROUTE
 037MAPLEDALE

DATE: 6/19/18

ENGINEER: NW / DC

DRAWN BY: NW

REVISIONS

| DATE | DESCRIPTION | INITIAL |
|----------|-------------------------|---------|
| 1/19/18 | CONST PKG | NW |
| 2/7/18 | QC | NW |
| 11/21/16 | REV ROUTE UP POLARIS LA | TR |

EXCEPT AS MAY BE OTHERWISE PROVIDED BY CONTRACT, THESE DRAWINGS AND SPECIFICATIONS SHALL REMAIN THE PROPERTY OF MCI COMMUNICATIONS SERVICES, INC., BOTH BEING ISSUED IN STRICT CONFIDENCE AND SHALL NOT BE REPRODUCED, COPIED, OR USED FOR ANY PURPOSE WITHOUT SPECIFIC WRITTEN PERMISSION.

| SCALE | |
|-------------|--------------|
| HORIZONTAL: | 1"=50' |
| VERTICAL: | 1"=50' |
| MP | TO MP |
| SHEET | 28 OF 30 |
| FILE: | 037MAPLEDALE |

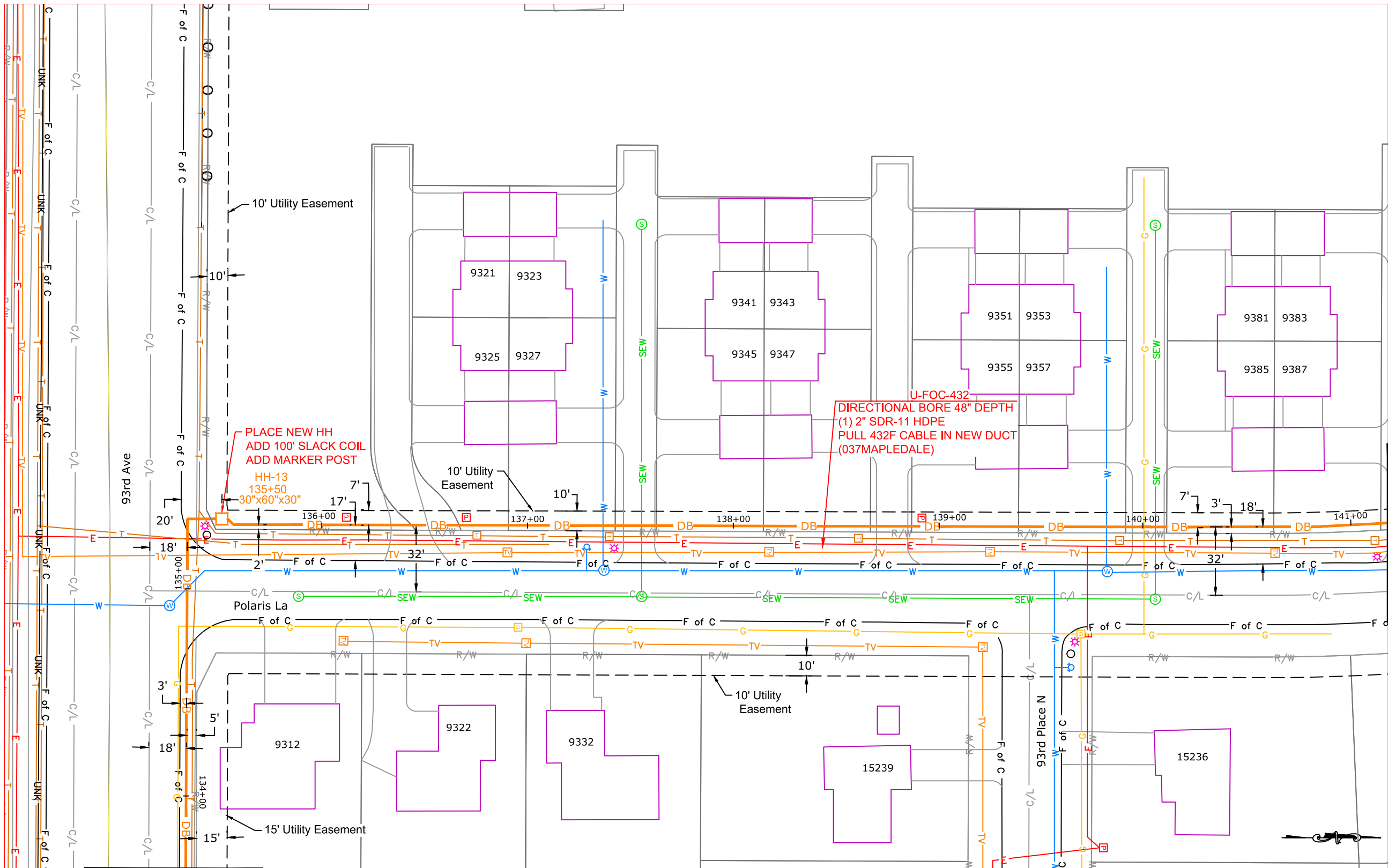

MATCH TO SHEET 27

MATCH TO SHEET 29



PROJECT: 037MAPLEDALE

BH03 / ISOTOPE-ALEXANDER

MAPLE GROVE, MN

| CLARIFICATION NO. | QUANTITY |
|-------------------|----------|
| | |
| | |
| | |
| | |
| | |
| | |
| | |
| | |
| | |
| | |
| | |
| | |
| | |

ACCESS TRANSMISSION SERVICES, LLC

MCI

OUTSIDE PLANT CONSTRUCTION

TITLE: FIBER OPTIC CABLE ROUTE

037MAPLEDALE

DATE: 6/19/18

ENGINEER: NW / DC

DRAWN BY: NW

| REVISIONS | | |
|-----------|-------------------------|---------|
| DATE | DESCRIPTION | INITIAL |
| 1/19/18 | CONST PKG | NW |
| 2/7/18 | QC | NW |
| 11/21/18 | REV ROUTE UP POLARIS LA | TR |
| | | |
| | | |

EXCEPT AS MAY BE OTHERWISE PROVIDED BY CONTRACT, THESE DRAWINGS AND SPECIFICATIONS SHALL REMAIN THE PROPERTY OF MCI COMMUNICATIONS SERVICES, INC., BOTH BEING ISSUED IN STRICT CONFIDENCE AND SHALL NOT BE REPRODUCED, COPIED, OR USED FOR ANY PURPOSE WITHOUT SPECIFIC WRITTEN PERMISSION.

SCALE

HORIZONTAL: 1"=50'

VERTICAL: 1"=50'

MP _____ TO MP _____

SHEET 29 OF 30

FILE: 037MAPLEDALE

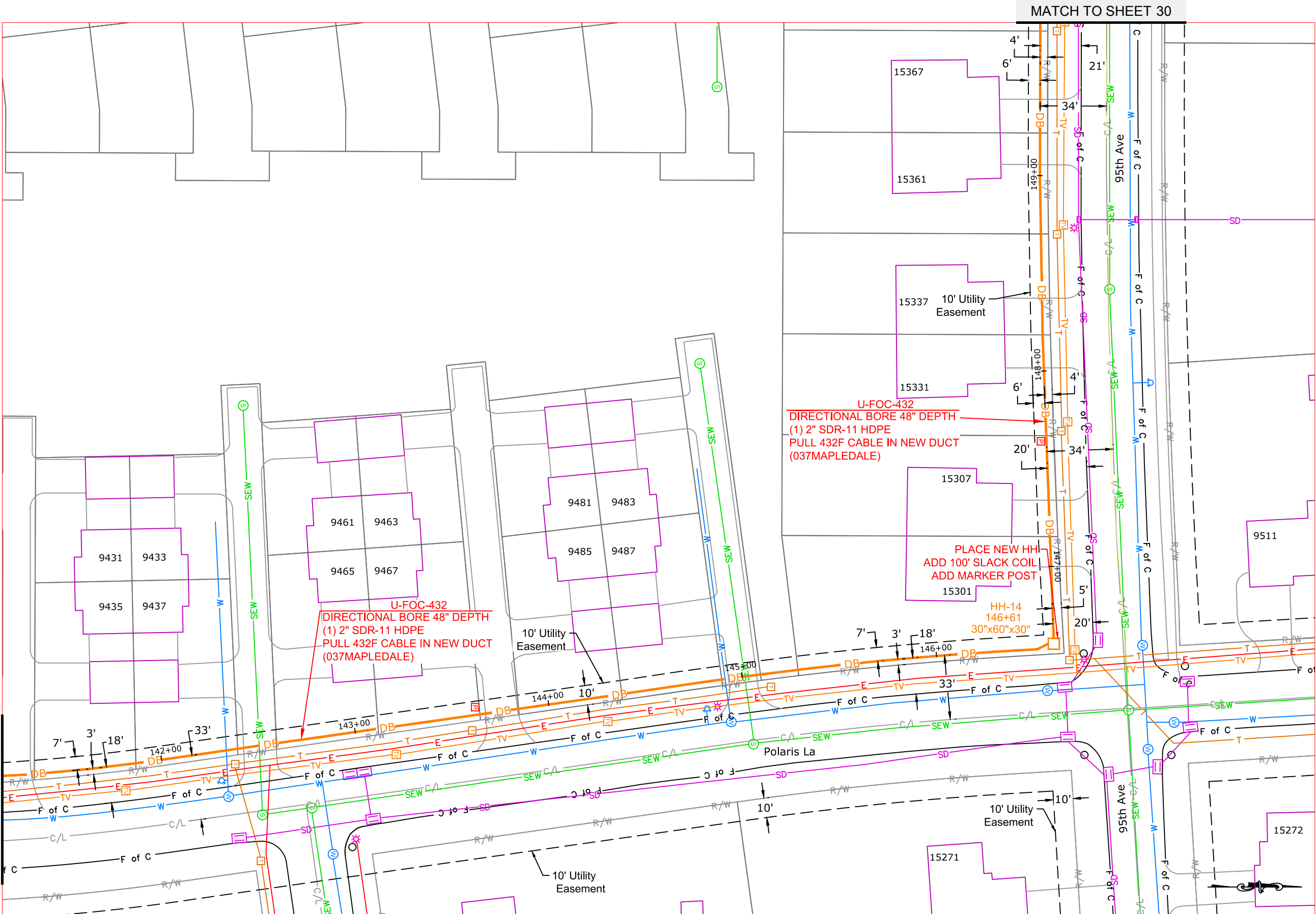



PROJECT: 037MAPLEDALE

BH03 / ISOTOPE-ALEXANDER

MAPLE GROVE, MN

CLARIFICATION NO. QUANTITY

| CLARIFICATION NO. | QUANTITY |
|-------------------|----------|
| | |
| | |
| | |
| | |
| | |
| | |
| | |
| | |
| | |
| | |
| | |
| | |
| | |
| | |
| | |
| | |
| | |
| | |
| | |
| | |
| | |
| | |

MCI
 ACCESS TRANSMISSION SERVICES, LLC
 OUTSIDE PLANT CONSTRUCTION
 TITLE: FIBER OPTIC CABLE ROUTE
 037MAPLEDALE

DATE: 6/19/18

ENGINEER: NW / DC

DRAWN BY: NW

REVISIONS

| DATE | DESCRIPTION | INITIAL |
|----------|-------------|---------|
| 1/19/18 | CONST PKG | NW |
| 2/7/18 | QC | NW |
| 11/21/18 | REV ROUTE | TR |

EXCEPT AS MAY BE OTHERWISE PROVIDED BY CONTRACT, THESE DRAWINGS AND SPECIFICATIONS SHALL REMAIN THE PROPERTY OF MCI COMMUNICATIONS SERVICES, INC., BOTH BEING ISSUED IN STRICT CONFIDENCE AND SHALL NOT BE REPRODUCED, COPIED, OR USED FOR ANY PURPOSE WITHOUT SPECIFIC WRITTEN PERMISSION.

SCALE

HORIZONTAL: 1"=50'

VERTICAL: 1"=50'

MP TO MP

SHEET 30 OF 30

FILE: 037MAPLEDALE

MATCH TO SHEET 29

