

SCALE: NTS

CENTURYLINK ENGINEER: TODD PAULSON
TELEPHONE: 651 312-5527
EMAIL: TODD.PAULSON@CENTURYLINK.COM

CENTURYLINK CPA: MARCIE DEMAIO
TELEPHONE: 214 386-2305
EMAIL: MARCIE.DEMAIO@CENTURYLINK.COM

PROJECT NUMBER: N.336075
SITE ADDRESS: 11670 FOUNTAINS DR. MAPLE GROVE, MN
COUNTY: HENNEPIN
SECTION: 27, TOWN: 119, RANGE: 22
COORDINATES: 45.093996, -93.427031

GOODMAN NETWORKS

PERMIT DRAWING

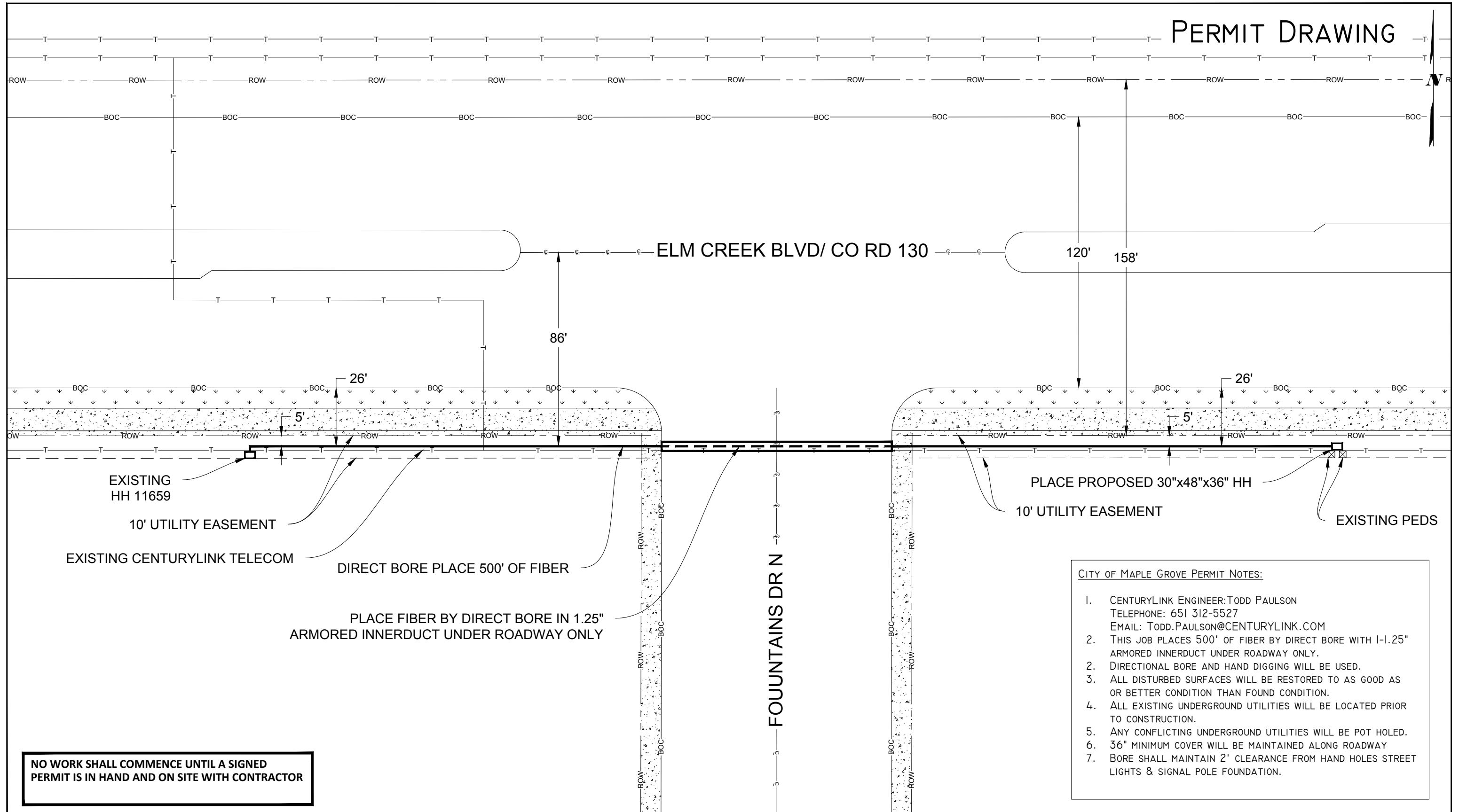

- CITY OF MAPLE GROVE PERMIT NOTES:**
1. CENTURYLINK ENGINEER: TODD PAULSON
TELEPHONE: 651 312-5527
EMAIL: TODD.PAULSON@CENTURYLINK.COM
 2. THIS JOB PLACES 500' OF FIBER BY DIRECT BORE WITH 1-1.25" ARMORED INNERDUCT UNDER ROADWAY ONLY.
 2. DIRECTIONAL BORE AND HAND DIGGING WILL BE USED.
 3. ALL DISTURBED SURFACES WILL BE RESTORED TO AS GOOD AS OR BETTER CONDITION THAN FOUND CONDITION.
 4. ALL EXISTING UNDERGROUND UTILITIES WILL BE LOCATED PRIOR TO CONSTRUCTION.
 5. ANY CONFLICTING UNDERGROUND UTILITIES WILL BE POT HOLED.
 6. 36" MINIMUM COVER WILL BE MAINTAINED ALONG ROADWAY
 7. BORE SHALL MAINTAIN 2' CLEARANCE FROM HAND HOLES STREET LIGHTS & SIGNAL POLE FOUNDATION.

NO WORK SHALL COMMENCE UNTIL A SIGNED PERMIT IS IN HAND AND ON SITE WITH CONTRACTOR



PERMITS REQUIRED CITY OF MAPLE GROVE
W/C: OSSEMN
CPA: MDEMAIO

CONTACT PERSON: LANCE MURDOCK
PHONE: 214-326-7894
FAX:
EMAIL: LANCE.MURDOCK@CENTURYLINK.COM

JOB: N.336075
LOCATION: 11670 FOUNTAINS DR
MAPLE GROVE, MN

