

**REPLACE 3PH- FUSED LBC "O". BARRIER BOARDS WON'T STAY IN PLACE AND ARE ARCING.
REFERRAL- 51450650
OSS073 - 13.8KV**

Replace 3 phase fused LBC "O".
Set new 3 phase fused LBC and stencil cabinet "O"
POI for the 50E fuses is L51081F01.

Restoration
Restore grassy area around new LBC "O"

**Designer -
John Pfothenauer
763-493-1876; 612-963-3804 cell**

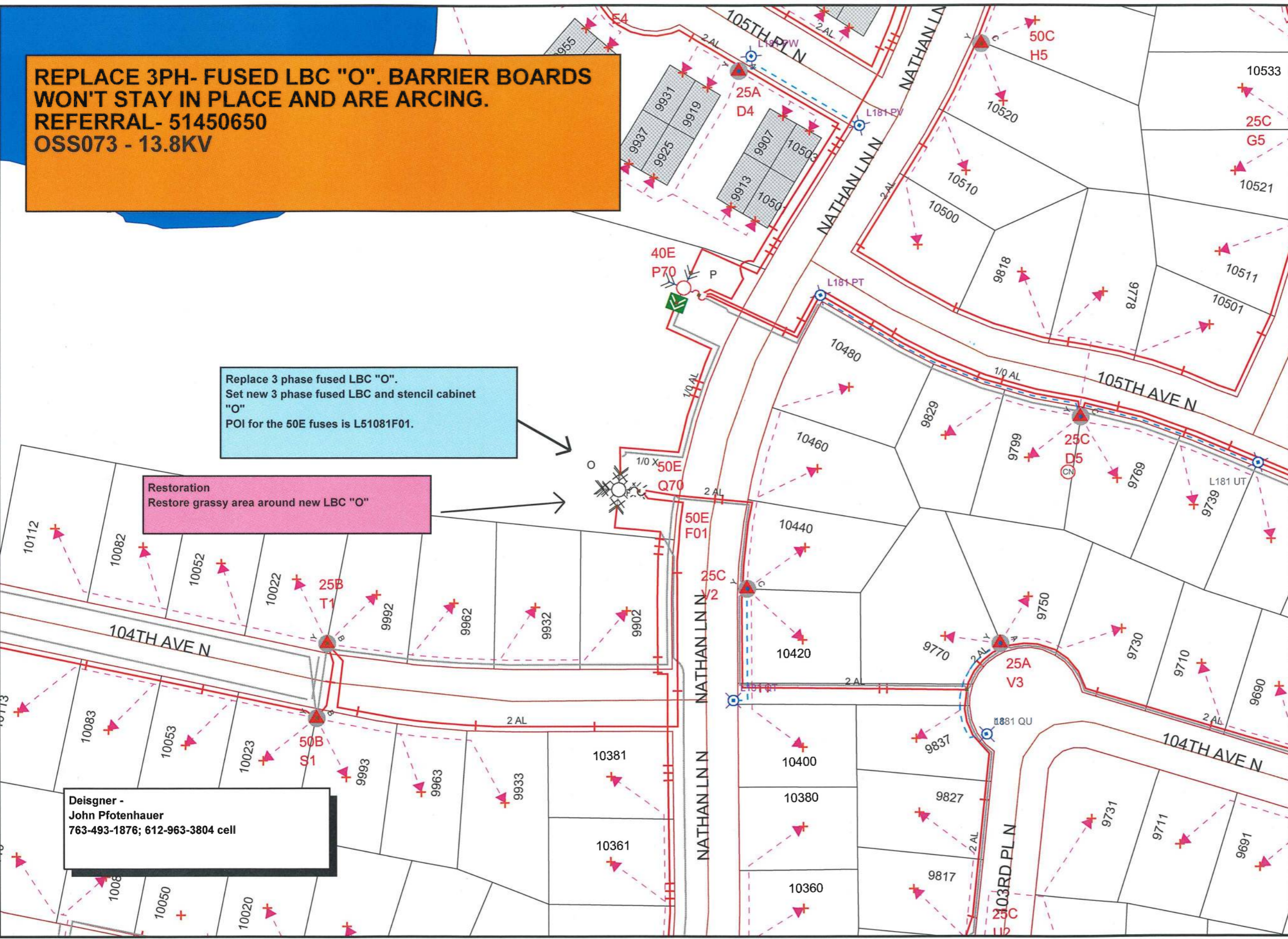

Work Order Information	
Service Request #	:
Design Number	: 00000742461
Designer/Planner ID	: pftj01
Designer/Planner Name	: Pfothenauer, John
Designer/Planner Ph #	: (763) 493-1876
Manager Approval	:

Joint Utility	
E:	G:
T:	C:

Design Location	
Division	: Maple Grove
County	: Hennepin
City	: Maple Grove
Address	: 9902 104th Ave N
T: 119N	R: 22W S: 1
Map #	: L51081 Permit :

Electric	
Feeder:	OSS073 Voltage: 13.8 KVA
Phase:	ABC Bkup Dev ID:

Gas	
System	: Pressure :
Size	: Material :
Dead End	:

Work Order # :
Date: 02/08/2018
Sketch: 1 Of 1 Sketch Data
Scale: 1" equals 100'



CONSTRUCTION USE ONLY
 NO CHANGES (BUILT AS DESIGNED)
 CHANGES MADE AS INDICATED
 (ALL URD MUST HAVE ACTUAL MEASUREMENTS FROM THE FIELD SITE)

RFO _____
 FOREMAN _____ DATE _____
 TEAM LEADER _____

DISCLAIMER: THERE ARE NO REPRESENTATIONS OR WARRANTIES (EXPRESS OR IMPLIED) ABOUT THE ACCURACY OF THIS PRINT. THIS PRINT IS PROVIDED WITH NO CLAIM AS TO PRINT COMPLETENESS, TIMELINESS, ACCURACY OF CONTENT OR USEFULNESS. STATE LAW REQUIRES ANYONE DIGGING, GRADING OR EXCAVATING TO OBTAIN A PRIOR FIELD LOCATE OF ALL UTILITIES; THIS PRINT DOES NOT DISCHARGE THIS REQUIREMENT OR ANY OTHER REQUIREMENT. THE COMPANY AND ITS AFFILIATES ASSUME NO LEGAL RESPONSIBILITY OR LIABILITY FOR THE RECIPIENT'S USE (OR ANY OTHER PARTIES' USE) OF THE PRINT, INCLUDING THE RECIPIENT'S INTENDED PURPOSE IN USING THE PRINT. NO COMPANY EMPLOYEE OR OTHER PARTY HAS BEEN AUTHORIZED TO PROVIDE THIS PRINT FOR PLANNING OR ESTIMATING PURPOSES; RELY ON THIS PRINT AT YOUR OWN RISK. BY ACCEPTING THIS PRINT, THE RECIPIENT & ANY OTHER PARTY RECEIVING A COPY OF THE PRINT ACKNOWLEDGES AND AGREES TO THIS DISCLAIMER. For All Field Locates Call 811