

Address: Maple Grove/9520 Zachary Lane North  
 Feeder: OSS 073  
 Voltage: ABC phase 13.8 kVA  
 Last Failed Spans: TR Z to TR Y

Task 1: Bore 1,880' three Phase 1/0 AL 13.8 kVA cable  
 TR Z to TR Y

Task 2: Terminate TR Z to TR Y  
 Splice P2, P3, P4

Task 3: Restore

Transformers from OH  
 only are 13.8

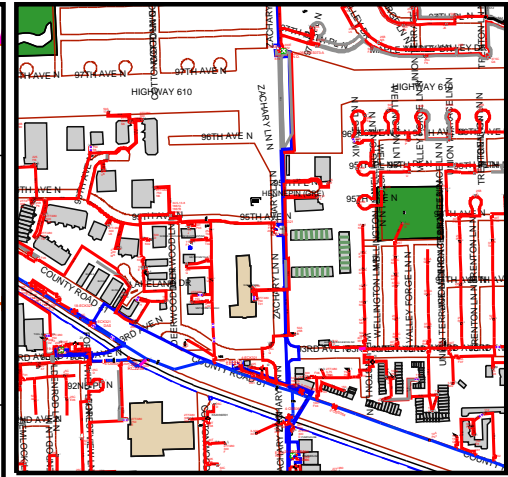
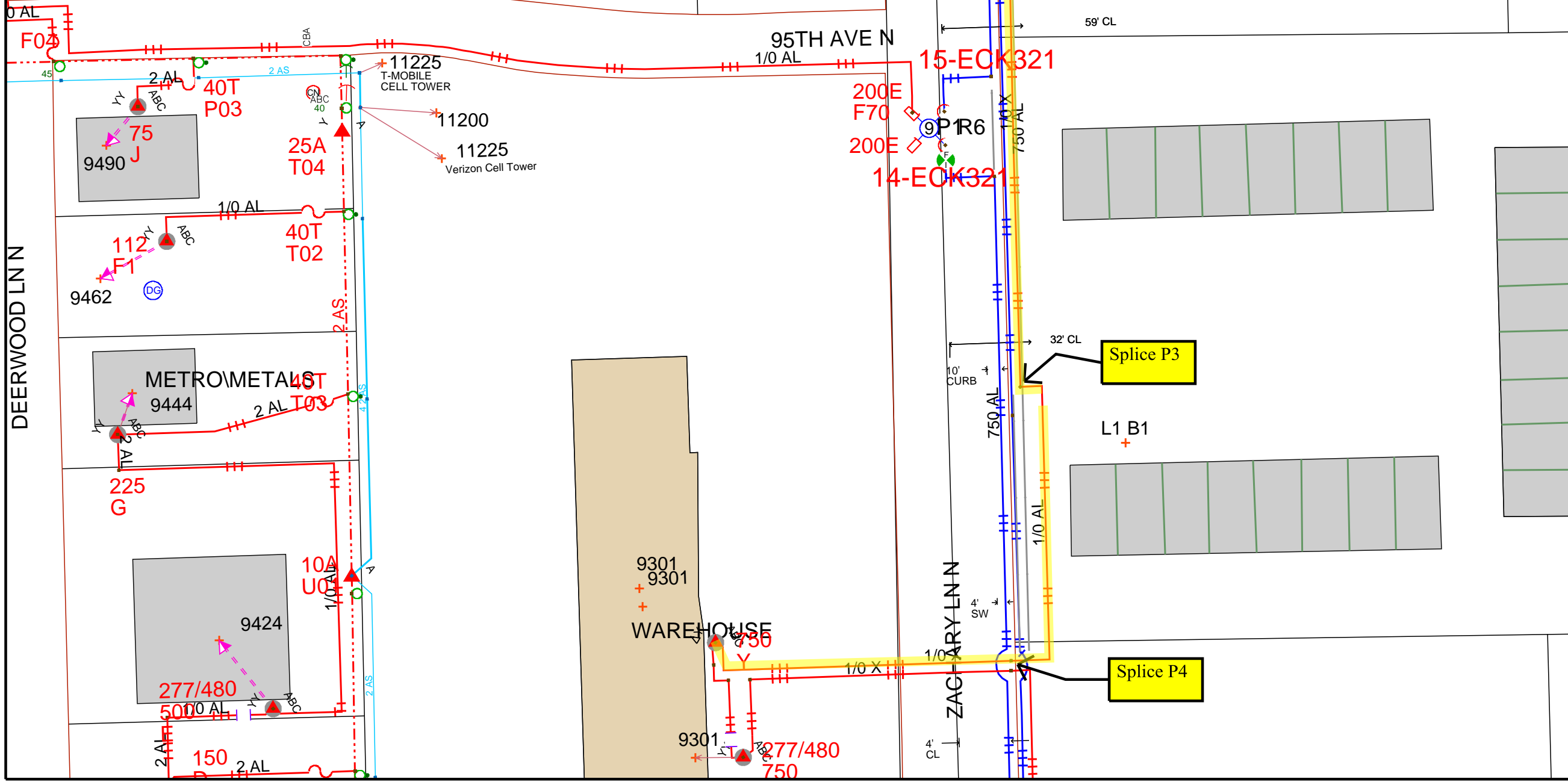

TBD

Work Order Information

Service Request #	:	
Design Number	:	TBD
Designer/Planner ID	:	TBD
Designer/Planner Name	:	TBD
Designer/Planner Ph #	:	(XXX) XXX - XXXX
Manager Approval	:	

Joint Utility

E:	G:
T:	C:

Design Location

Division	:	Maple Grove
County	:	Hennepin
City	:	Maple Grove
Address	:	9520 Zachary Lane North, Maple Grove, MN
T: 119N	R: 22W	S: 11
Map #	:	K52029
Permit	:	

Electric

Feeder	:	See notes	Voltage	:	See notes
Phase	:	See notes	Bkup Dev ID	:	

Gas

System	:		Pressure	:	
Size	:		Material	:	
Dead End	:				

Work Order # :

Date: 10/16/2017

Sketch: # Of # Sketch Data

Scale: 1" equals 125'



CONSTRUCTION USE ONLY

- NO CHANGES (BUILT AS DESIGNED)
- CHANGES MADE AS INDICATED  
 (ALL URD MUST HAVE ACTUAL MEASUREMENTS FROM THE FIELD SITE)

RFO \_\_\_\_\_  
 FOREMAN \_\_\_\_\_ DATE \_\_\_\_\_  
 TEAM LEADER \_\_\_\_\_

DISCLAIMER: THERE ARE NO REPRESENTATIONS OR WARRANTIES (EXPRESS OR IMPLIED) ABOUT THE ACCURACY OF THIS PRINT. THIS PRINT IS PROVIDED WITH NO CLAIM AS TO PRINT COMPLETENESS, TIMELINESS, ACCURACY OF CONTENT OR USEFULNESS. STATE LAW REQUIRES ANYONE DIGGING, GRADING OR EXCAVATING TO OBTAIN A PRIOR FIELD LOCATE OF ALL UTILITIES; THIS PRINT DOES NOT DISCHARGE THIS REQUIREMENT OR ANY OTHER REQUIREMENT. THE COMPANY AND ITS AFFILIATES ASSUME NO LEGAL RESPONSIBILITY OR LIABILITY FOR THE RECIPIENT'S USE (OR ANY OTHER PARTIES' USE) OF THE PRINT, INCLUDING THE RECIPIENT'S INTENDED PURPOSE IN USING THE PRINT. NO COMPANY EMPLOYEE OR OTHER PARTY HAS BEEN AUTHORIZED TO PROVIDE THIS PRINT FOR PLANNING OR ESTIMATING PURPOSES; RELY ON THIS PRINT AT YOUR OWN RISK. BY ACCEPTING THIS PRINT, THE RECIPIENT & ANY OTHER PARTY RECEIVING A COPY OF THE PRINT ACKNOWLEDGES AND AGREES TO THIS DISCLAIMER. For All Field Locates Call 811