

NOTE: BORE ALL PAVED STREETS AND DRIVEWAYS
 Minimum depth requirements for crossings of state highways and county roads is 60".
 Minimum depth requirements for crossings of city streets and township roads is 48".
 Minimum depth for parallel installations on state highways and county roads is 36".
 Minimum depth for parallel installations on city streets and township roads is 30".
 All steel pipe welds to be coated with 2 part epoxy.

INSTALL
 4" PE CL-6 @ 14' ECL TROY LN N
 2" PE CL-6 IN PRIVATE PROPERTY 3' NORTH OF CURB LINE

Install; Clean and Test; and Put in Service; Proposed new main per CenterPoint Energy Construction and Service Manual.

Purge new main until essentially 100% gas reading is obtained on Combustible Gas Indicator. See CenterPoint Energy Construction and Service Manual Section CS-B-1.230 for purging mains into service.

Install a marker ball at a new end of main, at a valve, at each ell of a horizontal offset, at road crossings and at any fitting or pressure control identified as needing to be located in the future. Refer to CenterPoint Energy Construction and Service Manual section CS-B-1.310 for installation procedures.

I hereby certify that this plan, specification, or report was prepared by me or under my direct supervision and that I am a duly Licensed Professional Engineer under the laws of the state of Minnesota.

Signature: 

Typed or Printed Name: Daniel G. Christensen

Date: 10/19/2017 License Number: 46588

WHEN BUTT FUSING TO EXISTING IN-SERVICE POLYETHYLENE, VISUALLY INSPECT FOR THE PRESENCE OF HYDROCARBON PERMEATION IMMEDIATELY AFTER REMOVING FUSION IRON. IF ANY BUBBLING IS IDENTIFIED ON THE HEATED SURFACE, DO NOT JOIN TO NEW PE PIPE. ALLOW TO COOL AND CUT THIS END OFF (12" LENGTH) AND SEND TO THE GOLDEN VALLEY LAB WITH STREET LOCATION AND W.O. #. COMPLETE TIE-IN/EXTENSION USING AN ELECTROFUSION COUPLING(S). DOCUMENT IN FIELD NOTES.



MINNESOTA REGION

PROPRIETARY AND CONFIDENTIAL

PROJECT #: 83623502

M52900 MAPLE GROVE

ONE CALL:
 Hennepin
 *NE6 T119/R22 MAIN & SERVICE
 *NW6 T119/R22
 * = this Page

LEGEND:

- ACTIVE MAIN
- DESIGNED MAIN
- - - PROPOSED ABANDONED/ OUT OF SERVICE MAIN
- ⊙ ABANDONED/ OUT OF SERVICE MAIN
- ⋯ PROPOSED SERVICE LINE SEE I/C DESIGN FOR EXACT LOCATION

PIPE REQUIRED:

- 454' 2" PE CL-6
- 530' 4" PE CL-6
-
- 984' PIPE

PROPOSED ABANDONED PIPE:

COPIES:

- PIPELINE INTEGRITY PACKET: N
- GAS VALVE: N
- DD NUMBER: N
- CORROSION: N
- EMP: N

FOLLOW INTERNAL PIPE SAMPLING REQUIREMENTS? N

SURVEYOR REQUIRED? N

RETURN PACKET TO ENG? N

GFIP #: N

PERMITS: MAPLE GROVE

PROJECT DESCRIPTION: NBCO HINDU TEMPLE OF MN STAFF HOUSING

DESIGNER: Wendy Kronwall
 PHONE #: 612-321-5508
 DRAWN BY: Wendy Kronwall
 DESIGN DATE: 10/18/2017

REVISION INFO: 10-19-2017 WLK REDESIGNED 2" PE CL-6 MAIN ALONG TROY LN N TO 4" PE CL-6

Main
 SCAN
 DATE:

SCALE 1" = 100'
 SHEET 1 OF 1

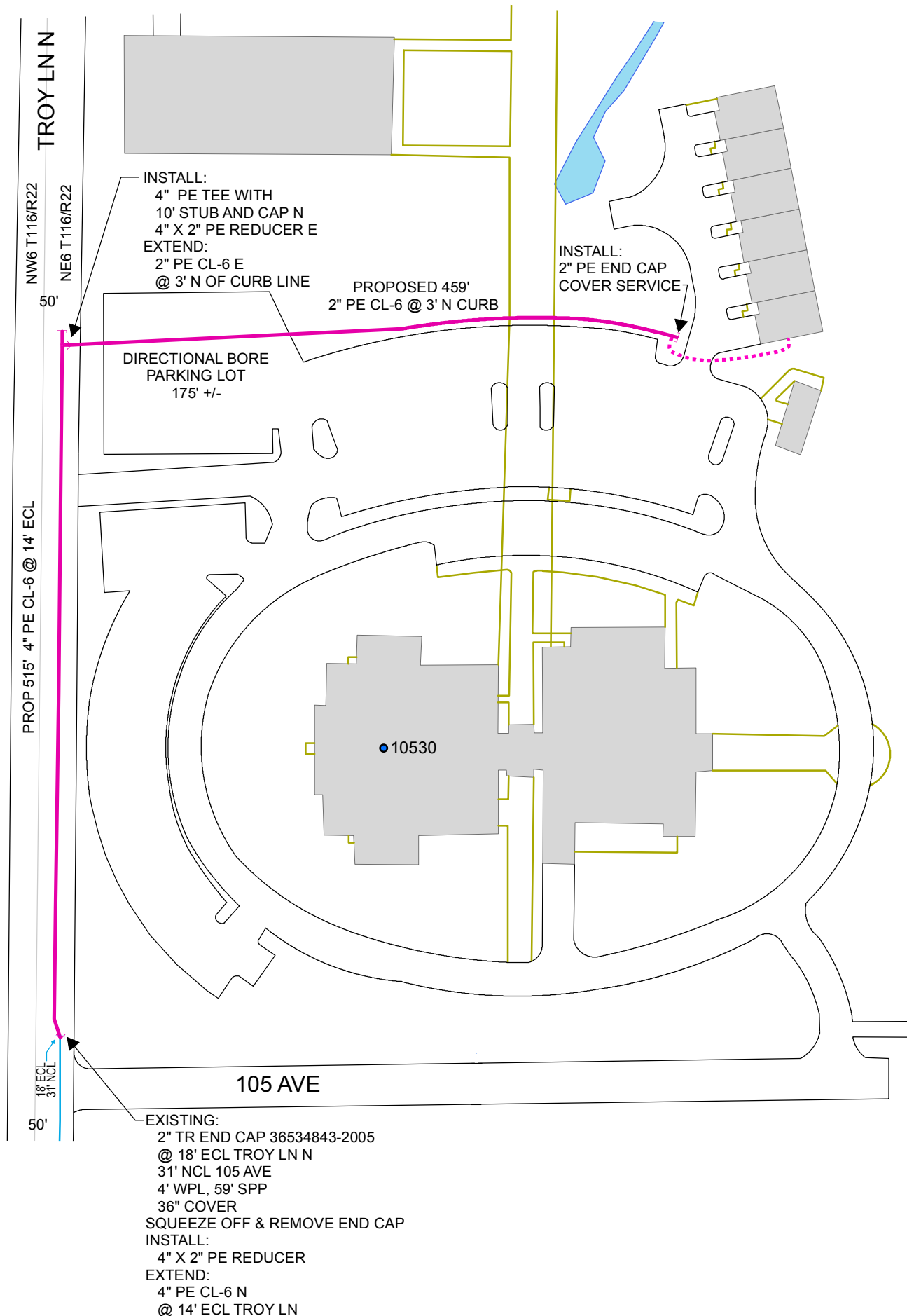

DESIGNER EXPRESS DESIGN

10/19/2017 12:32:57 PM