

CONSTRUCTION NOTES

Obtain Construction Plans from Designer prior to starting job.
 Coordinate with Contractor / Engineering Firm for exact locations of proposed structures and facilities prior to installation of gas facilities.
 Install new main as shown or as directed in field at time of installation.

Long side mains and services to be installed below proposed sub-cuts (See Construction Plans).

All test points should be installed in the boulevard or other acceptable locations and avoid placement in driving lanes.

Verify Coating test results if required prior to abandoning main.

CONSTRUCTION PROCEDURES

Install; Clean and Test; and Put in Service; Proposed new main per CenterPoint Energy Construction and Services Manual.

Purge new main until essentially 100% reading is obtained on Combustible Gas Indicator. See CenterPoint Energy Construction and Service Manual Section CS-B-1.230 for purging mains into service.

Complete all Service / Meter Work as directed. (See Service Survey)

Cut and Abandon existing main as shown. Purge abandoned mains until essentially 0% gas reading is obtained on Combustible Gas Indicator. See CenterPoint Energy Construction and Service Manual Section CS-B-1.110 and Section CS-B-1.230 for purging mains out of service using air movers.

Install a marker ball at a new end of main, at a valve, at each ell of a horizontal offset, at road crossings and at any fitting or pressure control identified as needing to be located in the future. Refer to CenterPoint Energy Construction and Service Manual section CS-B-1.310 for installation procedures.

NOTE: BORE ALL PAVED STREETS AND DRIVEWAYS
 Minimum depth requirements for crossings of state highways and county roads is 60". Minimum depth requirements for crossings of city streets and township roads is 48".
 Minimum depth for parallel installations on state highways and county roads is 36". Minimum depth for parallel installations on city streets and township roads is 30". All steel pipe welds to be coated with 2 part epoxy.



MINNESOTA REGION
 PROPRIETARY AND CONFIDENTIAL

PROJECT #: 83734657

M52900 MAPLE GROVE

ONE CALL:
 Hennepin
 *SW3 T119/R22
 *SE4 T119/R22
 * = this Page

LEGEND:
 — ACTIVE MAIN
 — DESIGNED MAIN
 - - - PROPOSED ABANDONED/
 OUT OF SERVICE MAIN
 (A) ABANDONED/
 OUT OF SERVICE MAIN

PIPE REQUIRED:
 455' 2" PE CL-6

 455' PIPE
 PROPOSED ABANDONED PIPE:
 442' 2" TR CL-6

 442' PIPE

COPIES:
 PIPELINE INTEGRITY PACKET: N
 GAS VALVE: N
 DD NUMBER:
 CORROSION:
 EMP: N

FOLLOW INTERNAL PIPE SAMPLING REQUIREMENTS? N
 SURVEYOR REQUIRED? N
 RETURN PACKET TO ENG? N
 GFIP#:
 PERMITS:
 CITY OF MAPLE GROVE

PROJECT DESCRIPTION: SREL
 TERRITORIAL RD

DESIGNER: TJ Haider
 PHONE #: 612-321-5132
 DRAWN BY: TJ Haider
 DESIGN DATE: 10/12/2017

REVISION INFO:

Main
 SCAN DATE: SCALE 1" = 100'
 SHEET 1 OF 1

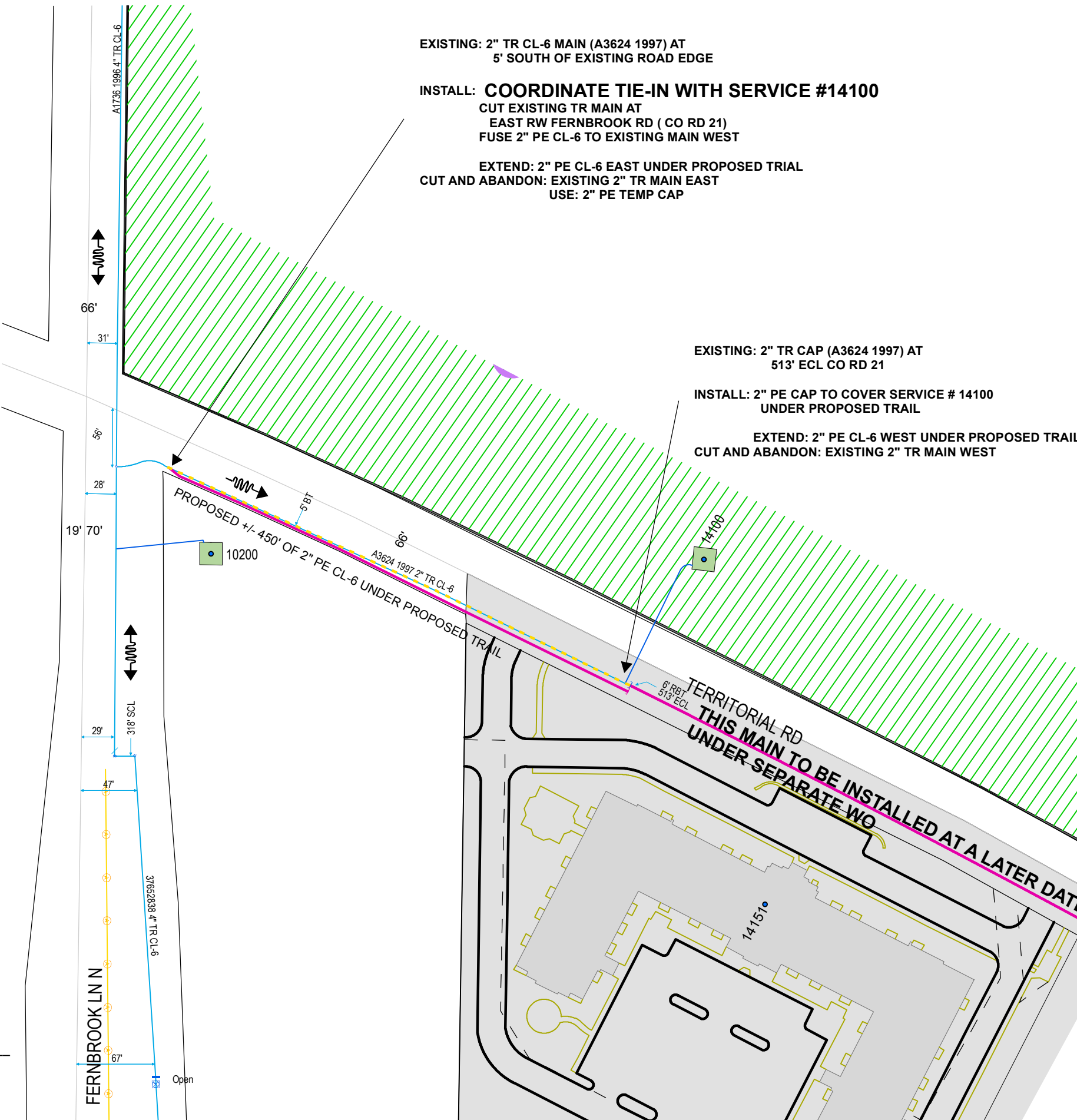

DESIGNER EXPRESS DESIGN

10/12/2017 12:05:37 PM

I hereby certify that this plan, specification, or report was prepared by me or under my direct supervision and that I am a duly Licensed Professional Engineer under the laws of the state of Minnesota.

Signature: Jerome Kallstrom

Typed or Printed Name: Jerome Kallstrom

Date: 10/13/2017 License Number: 13149