

# WATERS EDGE AT CENTRAL PARK

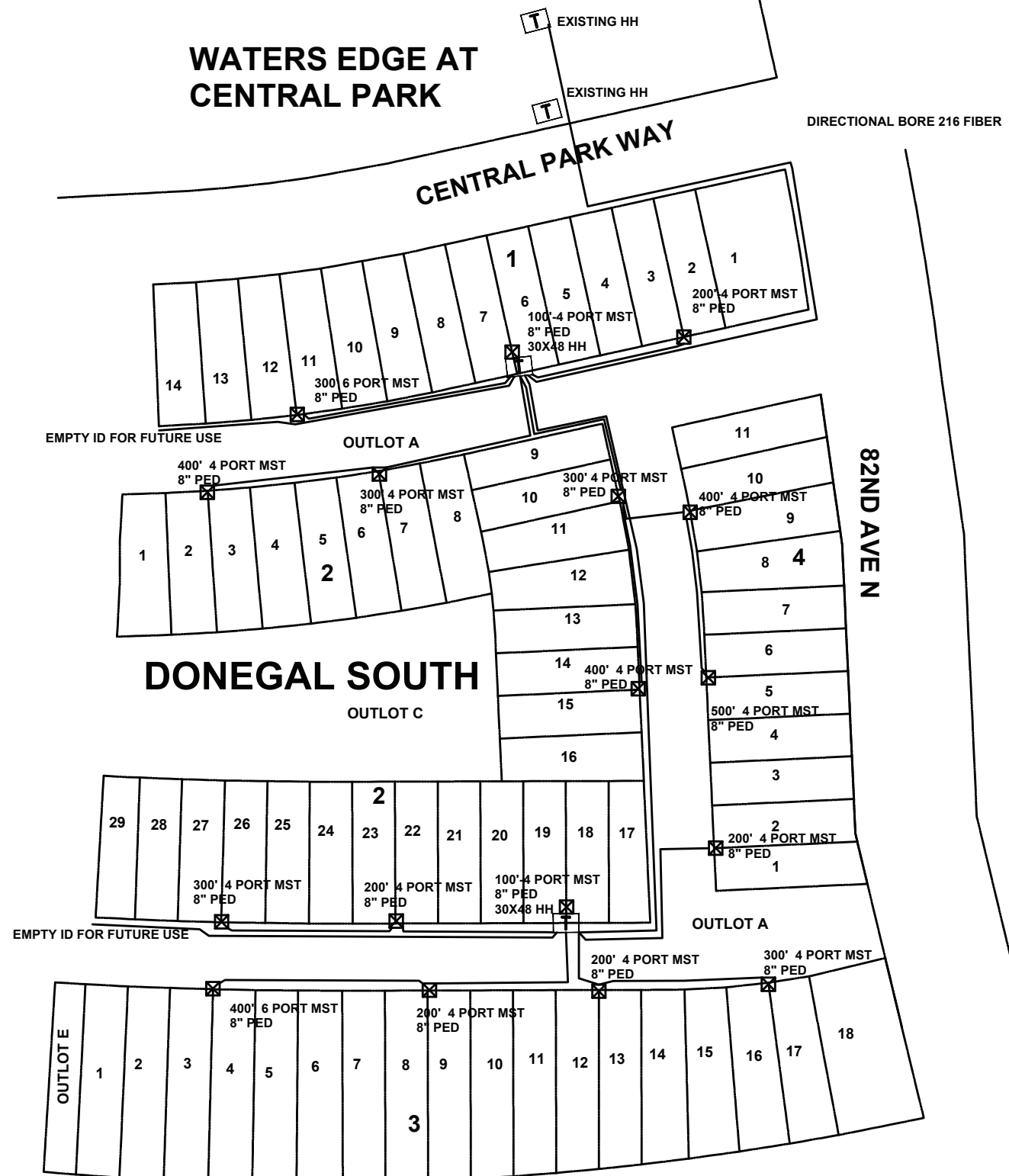

**CONSTRUCTION NOTES:**  
 1) ALL EXISTING UTILITIES WILL BE LOCATED PRIOR TO CONSTRUCTION.  
 2) ALL DISTURBED SURFACES WILL BE RESTORED TO AS GOOD OR BETTER CONDITION THAN FOUND.  
 3) JOINT TRENCH WILL DETERMINE EXACT LOCATION OF CABLE PLACEMENT

DONEGAL 4TH ADDITION

**DONEGAL SOUTH**  
 8300 CENTRAL PARK WAY  
 HENN. COUNTY  
 CITY PERMIT -MAPLE GROVE, MN 55369

SCALE: 1/8"=1'



ENGINEER: CENTURYLINK  
 JUSTIN FOTH  
 PHONE: (651)312-5323  
 E-MAIL: JUSTIN.FOTH1@CENTURYLINK.COM

PROJECT: N.305885  
 PERMIT TO PLACE NEW FIBER OPTIC CABLES,  
 AND HAND HOLES  
 SHEET: 01 OF 01 REV:01 DATE:10/11/2017