

78818154 - Install New Service Line - Plastic - CSV  
 INSTALL 4" X 1/2" CTS PE SVC TEE W/ .80" TAP  
 INSTALL 150' OF 1/2" CTS PE CL-6 SVC LINE  
 W/ 3/4" MPT x 1/2" CTS ANODELESS RISER, W/SLEEVE  
 EQUIPMENT# 60533812  
 TAP LOCATION IS 120' ECL FORESTVIEW LN N

78693446 - Install New Measurement Station - CSV  
 INSTALL 250TC ERT'D OSM (CL-6) (LOAD: 40 CFH)  
 W/ 3/4" B42R REG @ 2PSI W/ 1/8" x 3/16" ORIFICE  
 METER M/I WO# 78817806  
 EQUIPMENT# 14852161

CUSTOMER APPROVAL OF DESIGN I/C:  
 SIGNATURE: \_\_\_\_\_ DATE: \_\_\_\_\_  
 PRINTED NAME: \_\_\_\_\_  
 EMAIL: \_\_\_\_\_  
 Please review Center Point Energy design for installing Natural Gas to your facility. Verify the route of the Service Line and Meter Location on the building. If there is a conflict please contact the Designer or Sales Rep as shown in the Title Block.



PROPRIETARY AND CONFIDENTIAL

**78818154**  
 M52900 MAPLE GROVE

ONE CALL:  
 Hennepin  
 \*SE26 T119/R22  
 \*NE26 T119/R22  
 \*= this Page

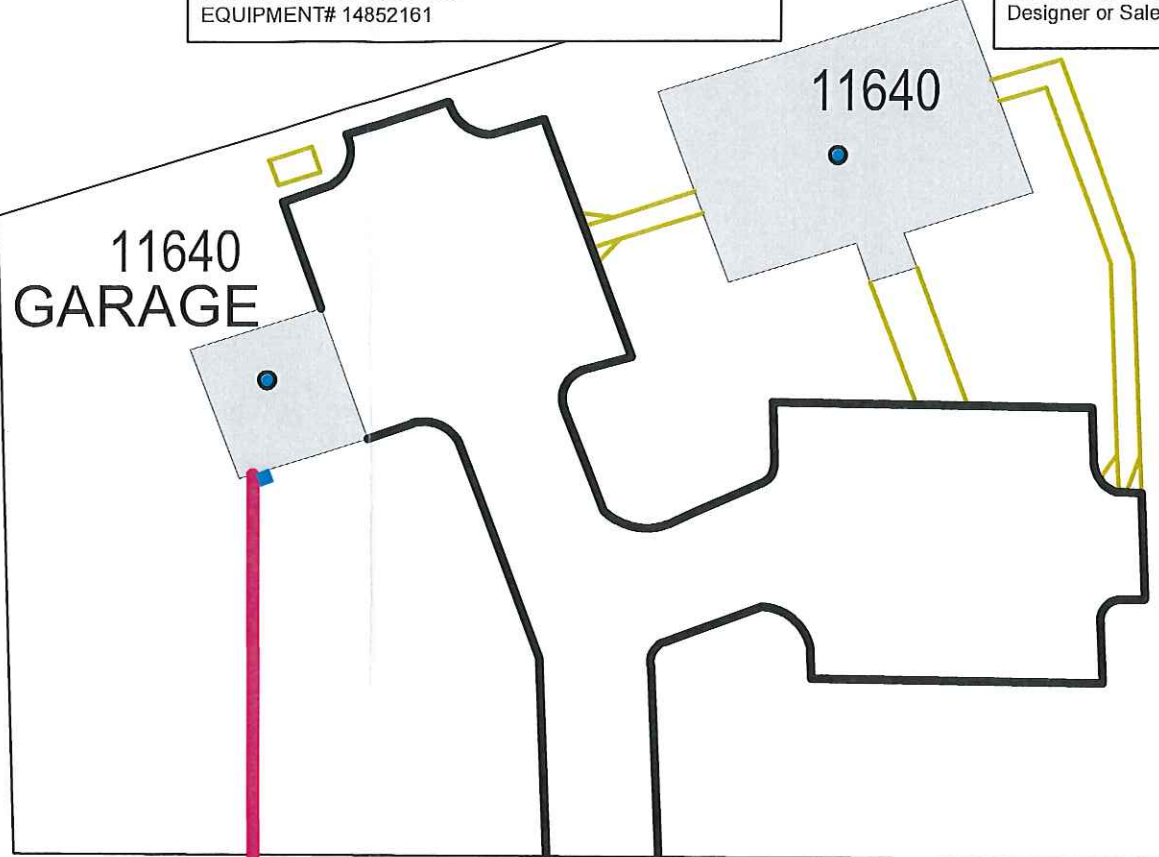

**LEGEND:**

- ACTIVE
- DESIGNED
- PROPOSED
- ABANDONED
- (A) ABANDONED

- Interruptible
- Existing
- Normal
- Future
- Proposed

Address: 11640 73rd Ave N, Maple Grove  
 Customer: MREA Garage  
 Contact Person: Brian Baas  
 Contact Phone: 763-286-9884  
 Sales Rep: Ryan Goetz  
 Sales Rep Phone: 612-202-7873  
 Construction Hotline: 612-321-5310  
 Copies To Pipeline Integrity: No  
 Customer Service Valve: No  
 Copies to Corrosion: No  
 Corrosion Approval: No  
 Follow Internal Pipe Sampling Requirements? No  
 GFIP#: NA  
 Permits: City  
 Requested Install Date: 7/31/16

Approval: *Ben Grob 11/3/16*

PROJECT DESCRIPTION:  
 MREA Garage

DESIGNER: John Miller  
 PHONE #: 612-321-5231  
 DRAWN BY: John Miller  
 DESIGN DATE: 6/30/2016

Revised Print  
 Destroy All Others  
 Revision History  
 Date:  
 Description:  
 Design Approval:

IC Services  
 SCAN DATE: 1": 40'  
 SHEET 1 OF 1

HWY 694 ROW

73RD AVE N 80'

NE26 T119/R22  
 SE26 T119/R22

M 429 1987 4" TR CL-6

87 4" TR CL-6

FORESTVIEW LN N

43'

22'

DESIGNER EXPRESS DESIGN  
 7/13/2016 11:06:31 AM