

Revised 5-23-17				CMS#		17207455 HELD PERMIT				
CenturyLink BSW Order/Maintenance Work Authorization										
Company		T600	Exchange		MAPLE GROVE			Service Order#		1461147087
Work Activity					Capital	Y	Maintenance	N		
Customer Name		Rachel Nader					Phone#		763-416-0661	
Address		7791 Garland Ln N					One Call Ticket#			
City & Zip		Maple Grove, MN 55369								
Location/Directions										
Description of Work or Special Instructions		MST PLACEMENT MST PLACEMENT MST PLACEMENT								
Held Order		Y	Permit:		Y	Bore:		Y	CBR#	
Employee Name		Les Peterson			Employee Contact#		763-807-0943			
Sketch		Material/Labor Units			Footage		Quantity		Comments	
(Include Cntr Line & Pedestal)		Description			Notes					
Cntr Line Footage		SEB3-22			BSW 3 pair					
Ped#		109556			SEP CUTOVER		CUTOVER BSW			
Parish/County		Hennepin			BM83		BSW guard at house			
		XXSEB-GL			Remove temp drop					
Township:		BM61(1.25)SEB			BSW Bore footage					
Section		SEBO PER FT LBR			Fiber Drop					
Range		BM2(5/8)(8)			Ground Rod					
		SEB6-22			BSW 6 Pair					
Nearest cross st.		78th Ave N			Plat Page		Map#			

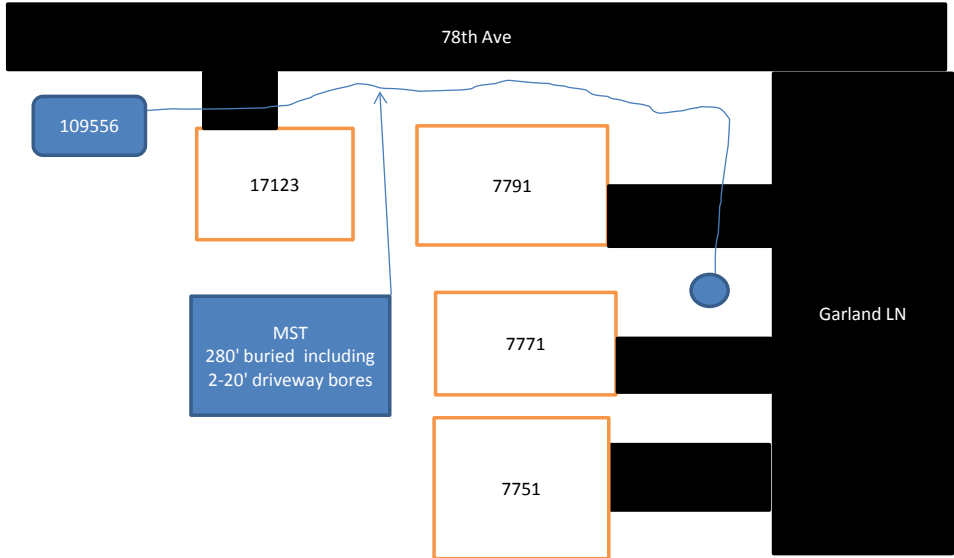

Originated By:		Date:		Completed By:		Date:	
Authorized By: (APS)		Date:		Inspected By:		Date:	
Authorized By: (AOM)		Date:					
Email sketch to:		MetroBSW@Centurylink.com					
1. Distance of the bury in Right-of-Way				3. Distance to the nearest intersection			
2. Distance from the terminal to the centerline				4. Nearest State Hwy mile marker			