



VICINITY MAP

INTERSECTION OF
TERRITORIAL RD AND
FERNBROOK LN N
MAPLE GROVE,
MN 55369
HENNEPIN COUNTY

CITY PERMIT

PROJECT: N.291310

CENTURYLINK
ENGINEER:
AARON LESMEISTER
PHONE:
612.861.8111
EMAIL:
AARON.LESMEISTER1@CENTURYLINK.COM

POWER ENGINEERS
DRAWN BY:
RION E TENWAH
EMAIL:
RION.TENWAH@POWERENG.COM

FIELD ENGINEER:
RION E TENWAH

SHEET: 01 REV: 01
OF: 05 DATE: 09/26/2017

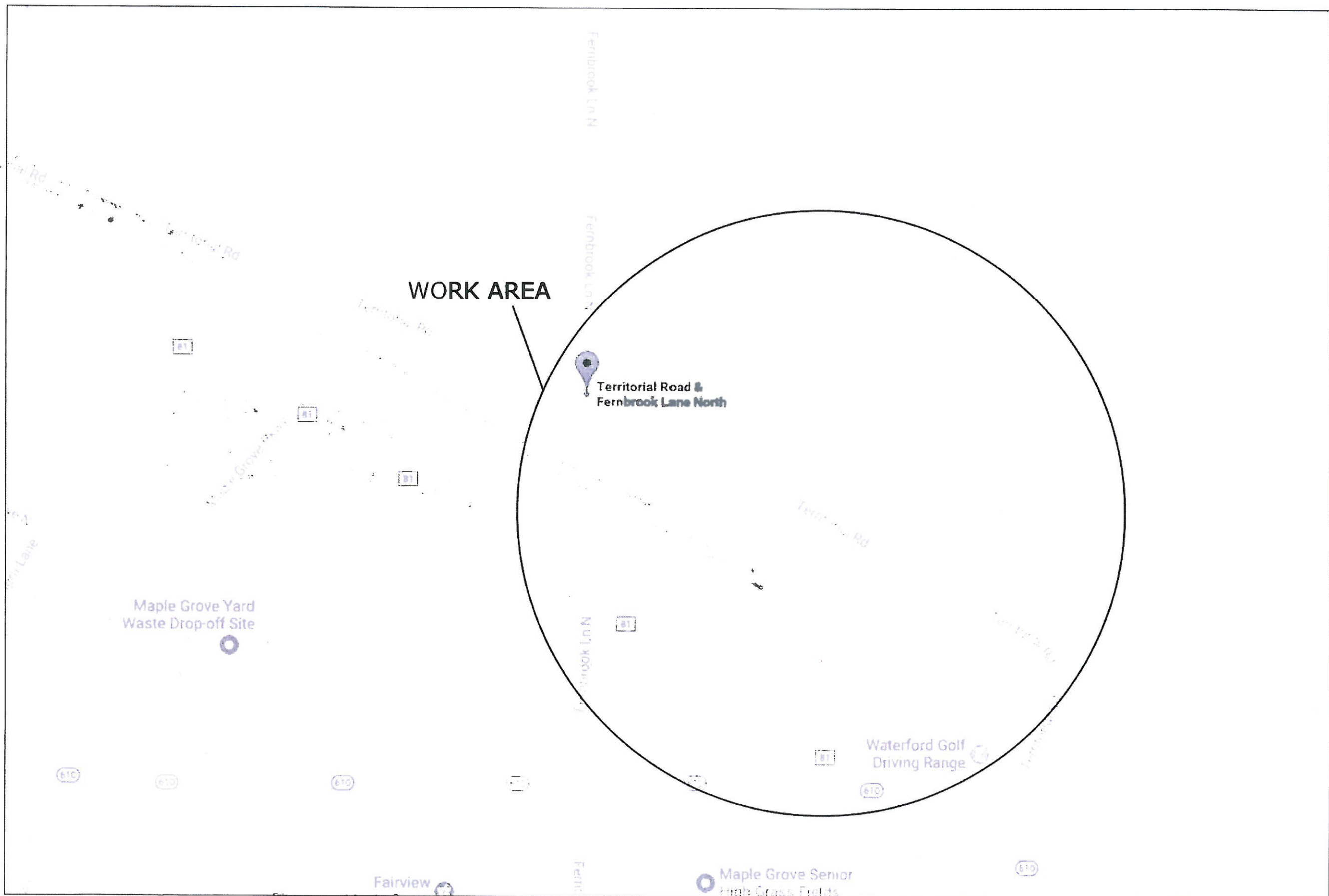

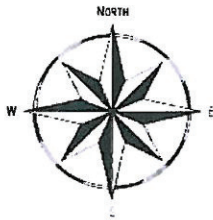

INTERSECTION OF
TERRITORIAL RD AND
FERNBROOK LN N
MAPLE GROVE,
MN 55369
HENNEPIN COUNTY

CITY PERMIT

PROJECT: N.291310

CENTURYLINK
ENGINEER:
AARON LESMEISTER
PHONE:
612 861 8111
EMAIL:
AARON.LESMEISTER1@CENTURYLINK.COM

POWER ENGINEERS
DRAWN BY:
RION E TENWAH
EMAIL:
RION.TENWAH@POWERENG.COM

FIELD ENGINEER:
RION E TENWAH

SHEET: 02 REV: 01
OF: 05 DATE: 09/26/2017



- CITY OF MAPLE GROVE PERMIT NOTES
- 1 THIS JOB REMOVES APPROXIMATELY 2,382' OF AERIAL CABLE AND 15 CTL POLES TO PLOW NEW UNDERGROUND CABLE. BORE UNDER ROADWAY APPROXIMATELY 50' TO PLACE NEW UNDERGROUND CABLE AND 1.25' CONDUIT
 - 2 ALL DISTURBED SURFACES WILL BE RESTORED TO AS GOOD AS OR BETTER CONDITION THAN FOUND CONDITION PRIOR TO CONSTRUCTION.
 3. ALL EXISTING UNDERGROUND UTILITIES WILL BE LOCATED PRIOR TO CONSTRUCTION.
 - 4 ANY CONFLICTING UNDERGROUND UTILITIES WILL BE POTHOLED
 - 5 CONTRACTOR TO DETERMINE TRENCH LOCATION.
 - 6 MINIMUM 36" DEPTH WILL BE MAINTAINED.

LEGEND	
	NEW PEDESTAL
	EXISTING PEDESTAL
	REMOVE POLE
	EXISTING XCEL POLE
	EXISTING XCEL POLE
	EXISTING AERIAL CABLE
	RIGHT OF WAY
	EDGE OF PAVEMENT
	CENTERLINE
	SIDEWALK
	PROPOSED BURIED CABLE
	BORE

SCALE: 1:50

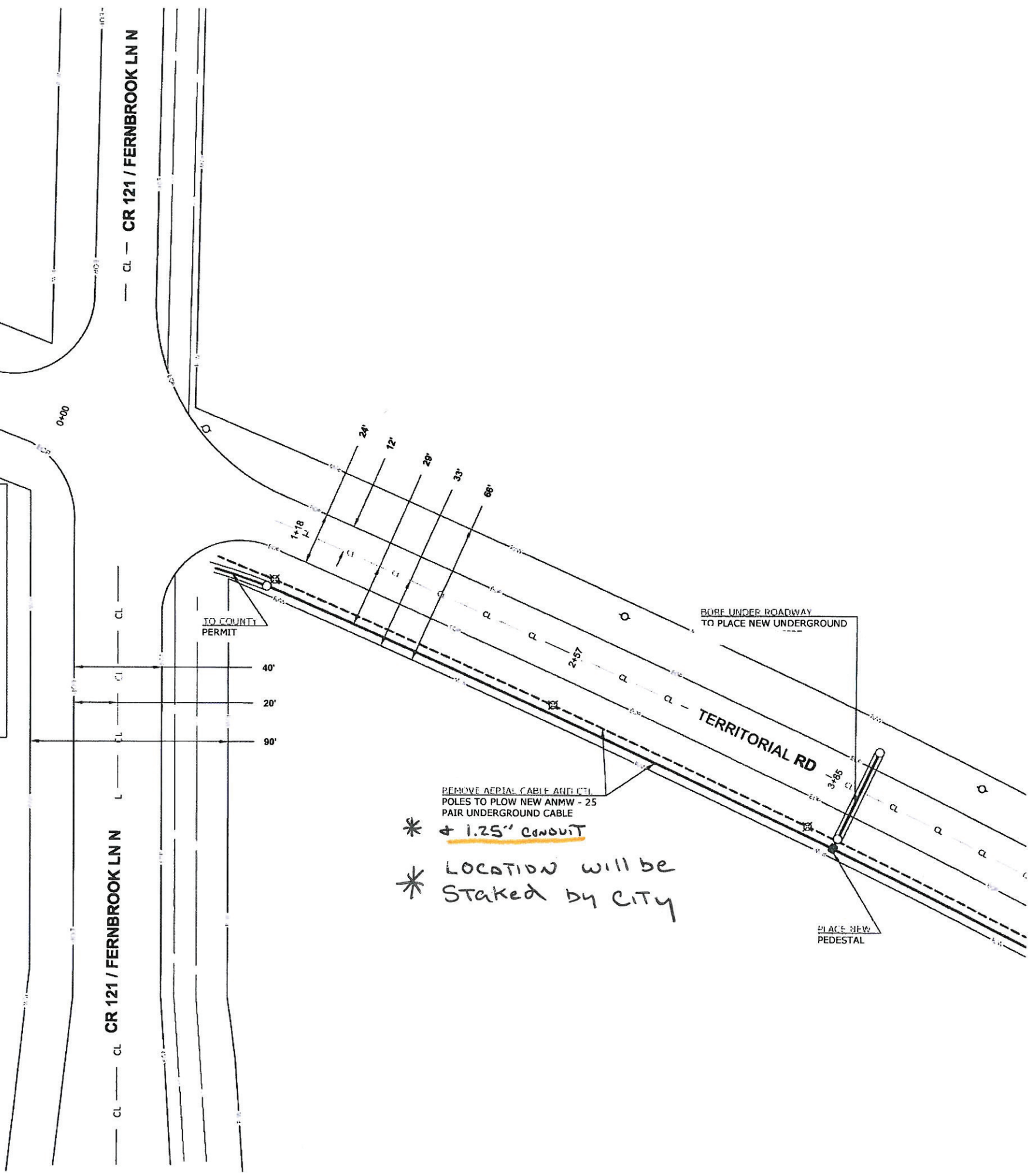

TO SHEET 03



INTERSECTION OF
TERRITORIAL RD AND
FERNBROOK LN N
MAPLE GROVE,
MN 55369
HENNEPIN COUNTY

CITY PERMIT

PROJECT: N.291310

CENTURYLINK
ENGINEER:
AARON LESMEISTER
PHONE:
612 861.8111
EMAIL:
AARON.LESMEISTER1@CENTURYLINK.COM

POWER ENGINEERS
DRAWN BY:
RION E TENWAH
EMAIL:
RION.TENWAH@POWERENG.COM

FIELD ENGINEER:
RION E TENWAH

SHEET: 03 REV: 01
OF: 05 DATE: 09/26/2017

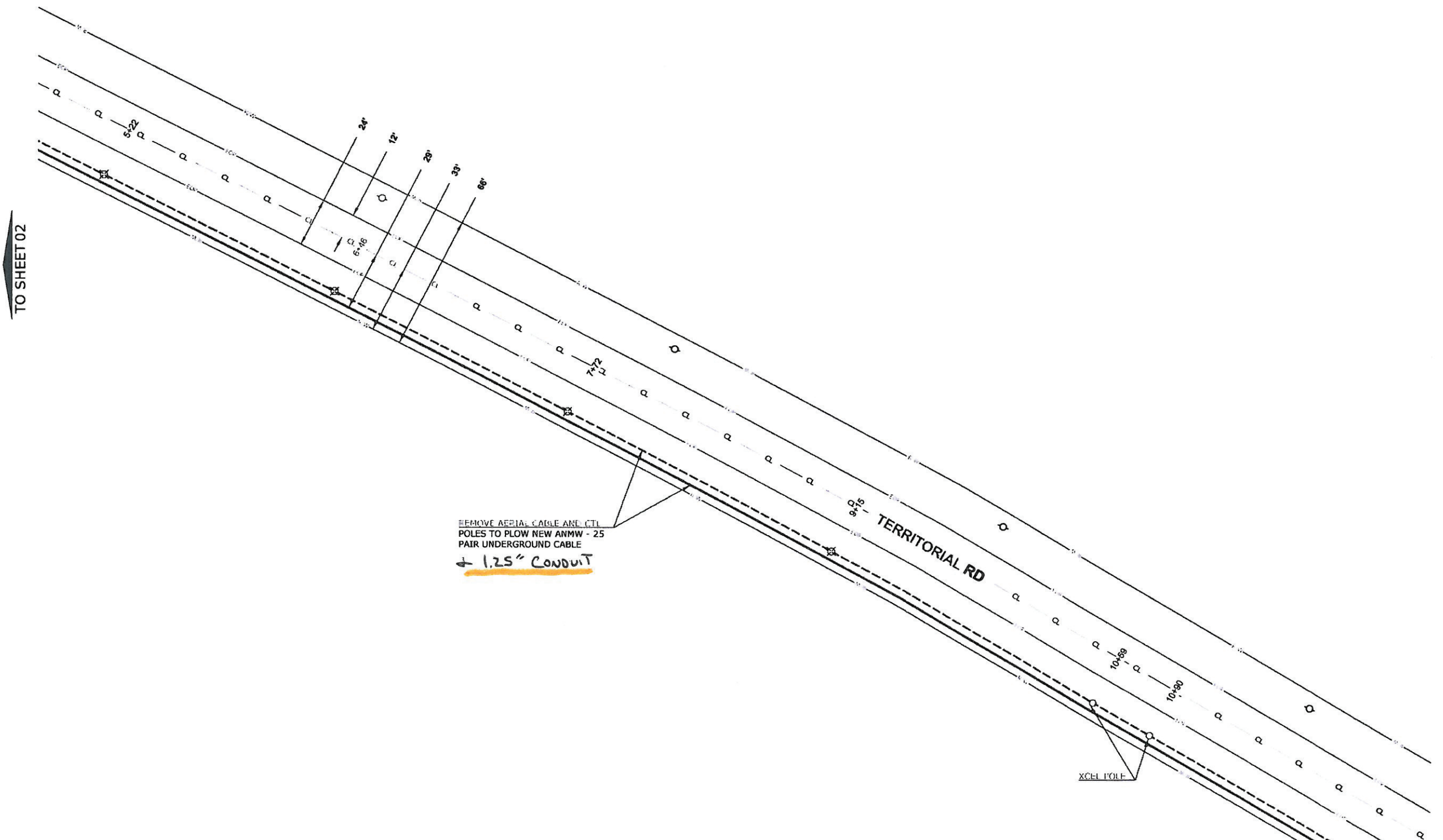

TO SHEET 02

TO SHEET 04

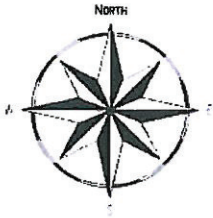

INTERSECTION OF
TERRITORIAL RD AND
FERNBROOK LN N
MAPLE GROVE,
MN 55369
HENNEPIN COUNTY

CITY PERMIT

PROJECT: N.291310

CENTURYLINK
ENGINEER:
AARON LESMEISTER
PHONE:
612 861 8111
EMAIL:
AARON.LESMEISTER1@CENTURYLINK.COM

POWER ENGINEERS
DRAWN BY:
RION E. TENWAH
EMAIL:
RION.TENWAH@POWERENG.COM
FIELD ENGINEER:
RION E. TENWAH

SHEET: 04 REV: 01
OF: 05 DATE: 09/26/2017



TO SHEET 03

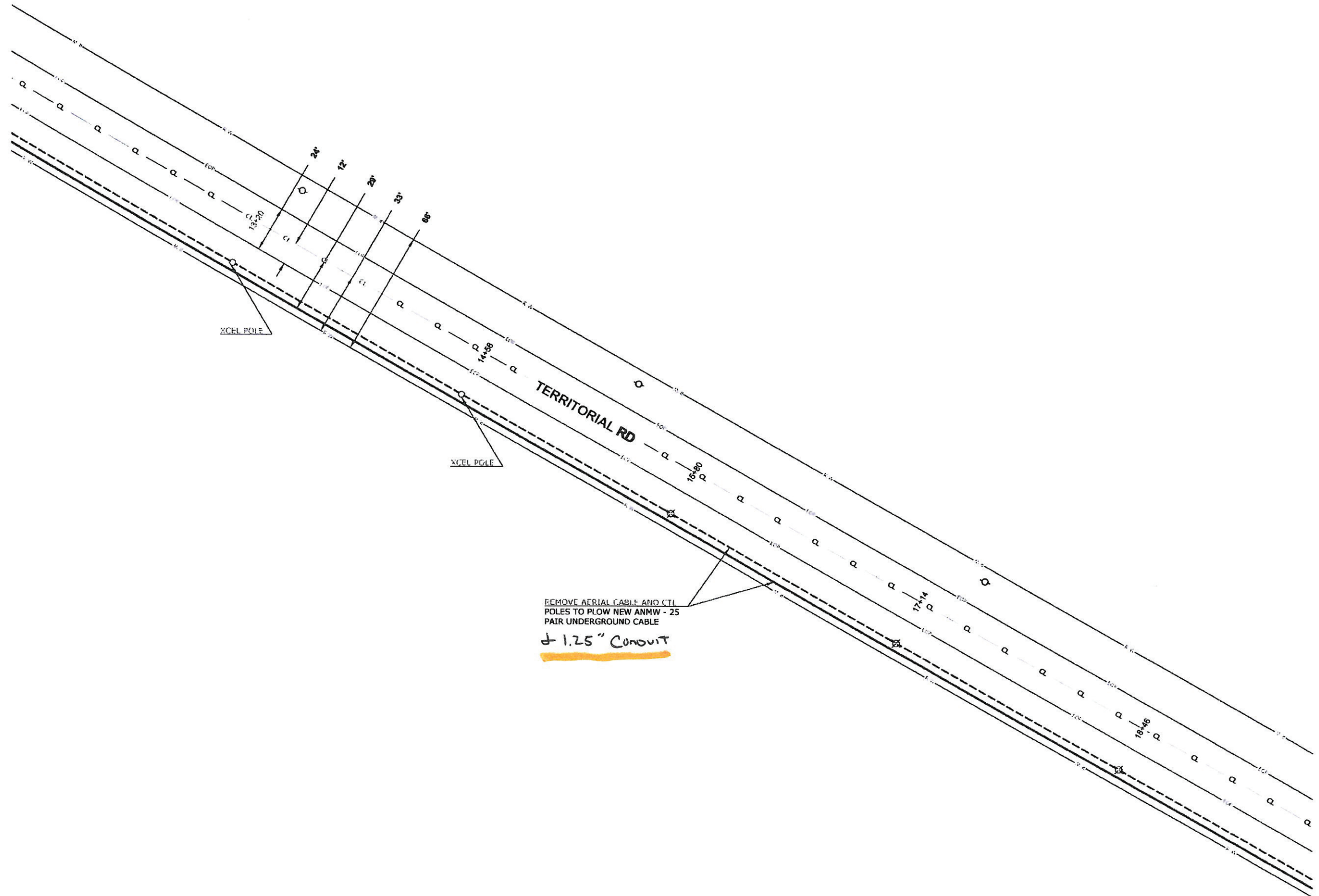

TO SHEET 05

