

Address: Maple Grove/11881 90th Ave
 Feeder: ECK 063
 Voltage: A phase 7.9 kVA
 Last Failed Span: TR L1 to TR M1

Task 1: Bore 525' one Phase #2 AL 7.9 kVA cable TR L1 - TR M1

Task 2: Terminate TR L1 to TR M1
 Replace TR L1 with 50KVA XFMR
 Replace TR L1 basement

Task 3: Restore

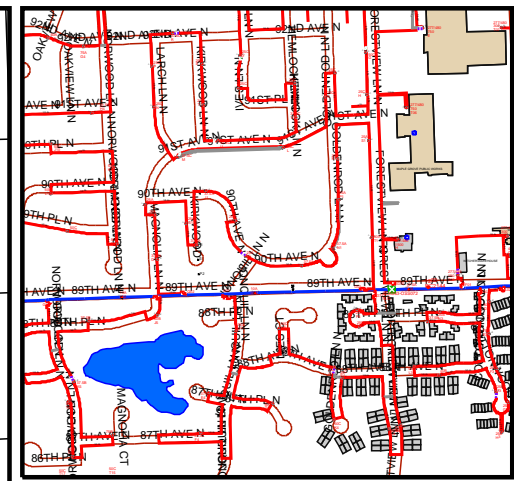
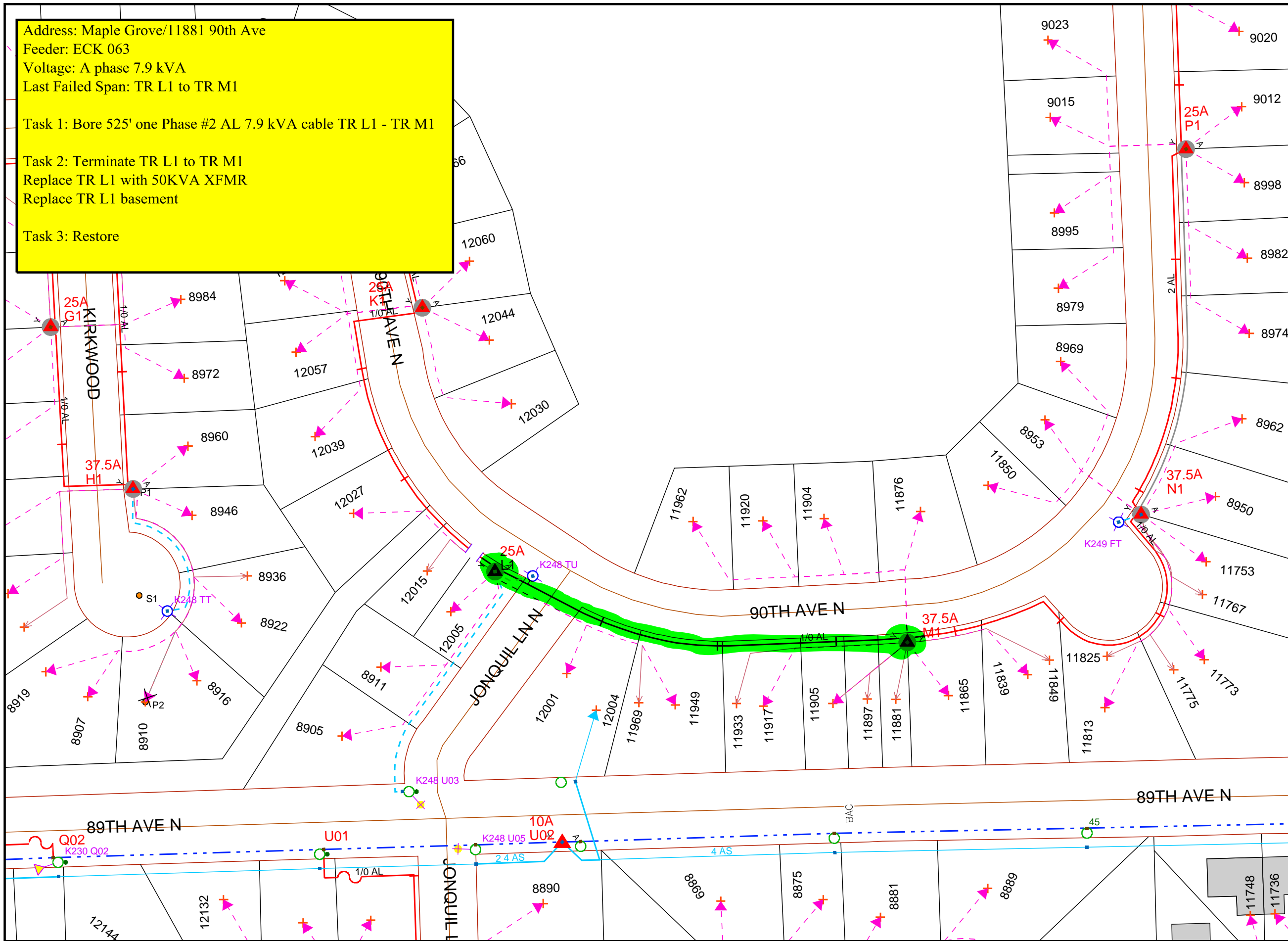

TBD

Work Order Information	
Service Request #	:
Design Number	: TBD
Designer/Planner ID	: TBD
Designer/Planner Name	: TBD
Designer/Planner Ph #	: (XXX) XXX - XXXX
Manager Approval	:

Joint Utility	
E:	G:
T:	C:

Design Location	
Division	: Maple Grove
County	: Hennepin
City	: Maple Grove
Address	: 11881 90th Ave, Maple Grove, MN
T: 119N	R: 22W S: 14
Map #	: K52048
Permit	:

Electric	
Feeder	: See notes
Voltage	: See notes
Phase	: See notes
Bkup Dev ID	:

Gas	
System	: Pressure :
Size	: Material :
Dead End	:

Work Order # :
 Date: 09/26/2017
 Sketch: # Of # Sketch Data
 Scale: 1" equals 100'



CONSTRUCTION USE ONLY	
<input type="checkbox"/>	NO CHANGES (BUILT AS DESIGNED)
<input type="checkbox"/>	CHANGES MADE AS INDICATED (ALL URD MUST HAVE ACTUAL MEASUREMENTS FROM THE FIELD SITE)

RFO _____
 FOREMAN _____ DATE _____
 TEAM LEADER _____

DISCLAIMER: THERE ARE NO REPRESENTATIONS OR WARRANTIES (EXPRESS OR IMPLIED) ABOUT THE ACCURACY OF THIS PRINT. THIS PRINT IS PROVIDED WITH NO CLAIM AS TO PRINT COMPLETENESS, TIMELINESS, ACCURACY OF CONTENT OR USEFULNESS. STATE LAW REQUIRES ANYONE DIGGING, GRADING OR EXCAVATING TO OBTAIN A PRIOR FIELD LOCATE OF ALL UTILITIES; THIS PRINT DOES NOT DISCHARGE THIS REQUIREMENT OR ANY OTHER REQUIREMENT. THE COMPANY AND ITS AFFILIATES ASSUME NO LEGAL RESPONSIBILITY OR LIABILITY FOR THE RECIPIENT'S USE (OR ANY OTHER PARTIES' USE) OF THE PRINT, INCLUDING THE RECIPIENTS INTENDED PURPOSE IN USING THE PRINT. NO COMPANY EMPLOYEE OR OTHER PARTY HAS BEEN AUTHORIZED TO PROVIDE THIS PRINT FOR PLANNING OR ESTIMATING PURPOSES; RELY ON THIS PRINT AT YOUR OWN RISK. BY ACCEPTING THIS PRINT, THE RECIPIENT & ANY OTHER PARTY RECEIVING A COPY OF THE PRINT ACKNOWLEDGES AND AGREES TO THIS DISCLAIMER. For All Field Locates Call 811