

Revised 5-23-17				CMS#		17177153 PERMIT									
CenturyLink BSW Order/Maintenance Work Authorization															
Company		T600		Exchange		MAPLE GROVE		Service Order#							
Work Activity		Buried Cable-Metallic				Capital		Y		Maintenance		N			
Customer Name		Marcie Demaio				Phone#									
Address		8321 Deerwood Ln.				One Call Ticket#									
City & Zip		Maple Grove 55369													
Location/Directions															
Description of Work or Special Instructions															
Held Order		N		Permit:		N		Bore:		N		CBR#		651-302-9778	
Employee Name		Brandon Smith				Employee Contact#		612-296-7599							
Sketch		Material/Labor Units				Footage		Quantity		Comments					
(Include Cntr Line & Pedestal)		Description		Notes											
Cntr Line Footage		33		SEB3-22		BSW 3 pair									
Ped#				SEPCUTOVER		CUTOVER BSW									
Parish/County		BM83		XXSEB-GL		Remove temp drop									
Township:		BM61(1.25)SEB				BSW Bore footage									
Section		SEBO PER FT LBR				Fiber Drop									
Range		BM2(5/8)(8)				Ground Rod									
		SEB6-22				BSW 6 Pair									
Nearest cross st.						Plat Page		Map#							

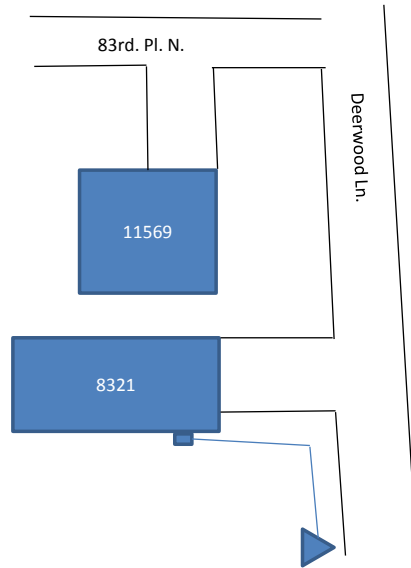

Originated By:		Date:		Completed By:		Date:	
Authorized By: (APS)		Date:		Inspected By:		Date:	
Authorized By: (AOM)		Date:					
Email sketch to:		MetroBSW@Centurylink.com					
1. Distance of the bury in Right-of-Way				3. Distance to the nearest intersection			
2. Distance from the terminal to the centerline				4. Nearest State Hwy mile marker			