



*Applicant:

| | | |
|-------------------------------|------------|----------------------|
| First Name: | Last Name: | |
| Paulson | Todd | |
| Company: | | |
| CenturyLink | | |
| Company Phone: | | Local Phone: |
| (214) | 326 | 7894 () - () - () |
| Email Address: | | |
| Lance.Murdock@centurylink.com | | |
| Mailing Address: | | |
| Address Line 1: | | |
| 425 Monroe St | | |
| Address Line 2: | | |
| | | |
| City: | State: | Zip Code: |
| Anoka | MN | 55303 |

* Nature of Work:

- Main Installation
- Service Installation
- Other

* Surface to be Disturbed:

- Gravel
- Concrete
- Bituminous
- Boulevard

* Work to start on or after:

08/16/2017

* To be completed on or before:

02/12/2018

Applicant Project No.:

N.282602

(Job Number)



* Provide a detailed work description:

Bore 70' from existing HH 113380 to the West, below Wedgwood Rd N, Place new HH. From New HH, bore South along the West side of Wedgwood Rd N for 490', place new HH. Bore West for 10' to exit City of Maple Grove Right-of-Way.

Size and kind of pipe:

Direct buried Fiber Optic Cable

* Depth from surface:

36" - 48"

If other is selected, please provide additional information:

* Length of utility construction:

570'

(Feet Only)

* Method of installation:

- Directional Bore
- Hand Dig
- Open Trench
- Joint Trench
- Other

If other is selected, please provide additional information:

* Machine excavation:

Yes

* Development:

New

* Will traffic detouring be necessary:

No

* Will any excavation be taking place on Hennepin County right-of-way?

No

PERMIT DRAWING

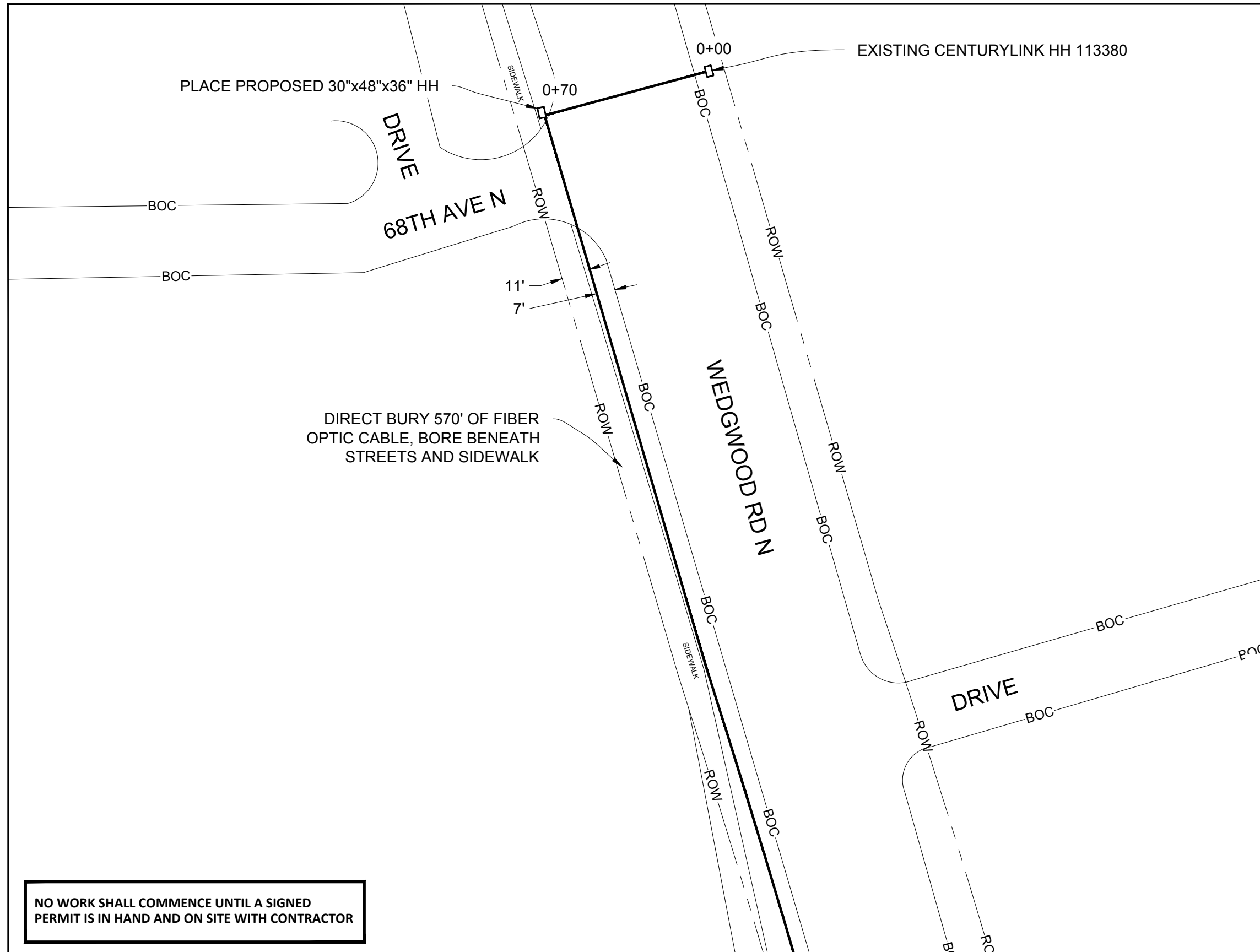

- CITY OF MAPLE GROVE PERMIT NOTES:
1. CENTURYLINK ENGINEER: TODD PAULSON
TELEPHONE: 651-312-5527
EMAIL: TODD.PAULSON@CENTURYLINK.COM
 2. THIS JOB PLACES 570' OF FIBER OPTIC CABLE & (2) 30"x48"x36" HH
 3. DIRECTIONAL BORE AND HAND DIGGING WILL BE USED.
 4. ALL DISTURBED SURFACES WILL BE RESTORED TO AS GOOD AS OR BETTER CONDITION THAN FOUND CONDITION.
 5. ALL EXISTING UNDERGROUND UTILITIES WILL BE LOCATED PRIOR TO CONSTRUCTION.
 6. ANY CONFLICTING UNDERGROUND UTILITIES WILL BE POT HOLED.
 7. 36" MINIMUM COVER WILL BE MAINTAINED ALONG ROADWAY
 8. BORE SHALL MAINTAIN 2' CLEARANCE FROM HAND HOLES STREET LIGHTS & SIGNAL POLE FOUNDATION.

5605 GREEN CIRCLE DR.
MINNETONKA, MN 55363

PERMITS REQUIRED: CITY OF MAPLE GROVE
W/C: MPGVMNXA
CPA: MDEMAIO
CPS: BRICHTER

CONTACT PERSON: LANCE MURDOCK
PHONE: 214-326-7894
FAX:
EMAIL: LANCE.MURDOCK@CENTURYLINK.COM

JOB: N.282602
Loc.: 13300 67TH AVE N,
MAPLE GROVE, MN
SECTION: 34, TOWN: 119, RANGE: 22
COORDINATES: 45.077254, -95.449529

DRAWING SYMBOLS

| | | | |
|--------------|--------------|----------------------|---------|
| STREET LIGHT | FIRE HYDRANT | VALVE | MANHOLE |
| STORM DRAIN | UTILITY POLE | EXISTING PED/CABINET | TREE |

SCALE: 1" = 40'

SHEET: 1 OF 2

PERMIT DRAWING



DIRECT BURY 570' OF FIBER OPTIC CABLE, BORE BENEATH STREETS AND SIDEWALK

PLACE PROPOSED 30"x48"x36" HH

NO WORK SHALL COMMENCE UNTIL A SIGNED PERMIT IS IN HAND AND ON SITE WITH CONTRACTOR



PERMITS REQUIRED: CITY OF MAPLE GROVE
 W/C: MPGVMNXA
 CPA: MDEMAIO
 CPS: BRICHTER

CONTACT PERSON: LANCE MURDOCK
 PHONE: 214-326-7894
 FAX:
 EMAIL: LANCE.MURDOCK@CENTURYLINK.COM

JOB: N.282602
 Loc.: 13300 67TH AVE N,
 MAPLE GROVE, MN
 SECTION: 34, TOWN: 119, RANGE: 22
 COORDINATES: 45.077254, -93.449529

DRAWING SYMBOLS

- STREET LIGHT
- FIRE HYDRANT
- VALVE
- MANHOLE
- STORM DRAIN
- UTILITY POLE
- EXISTING PED/CABINET
- TREE

