

Address: 7486 Quantico  
 Feeder: ECK062  
 Voltage: 7.9 kVA  
 Last Failed Span: D1 - G5  
 Task 1: Bore 1254' Single Phase #2AL 7.9 kVA cable D1 - G5  
 Task 2: Terminate D1 - G5  
 Replace transformer and basement and raise basement on G5  
 Replace basement and raise basement on D1  
 Task 3: Restore

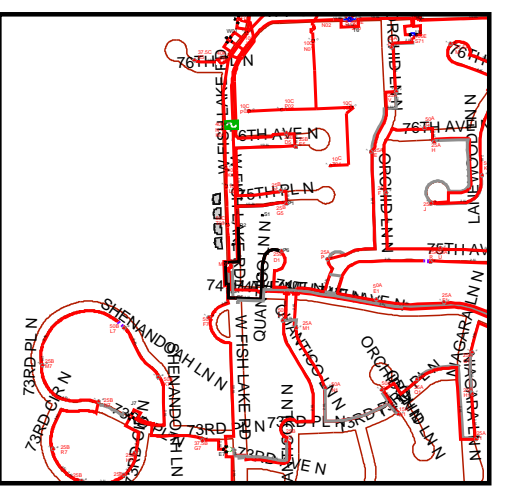
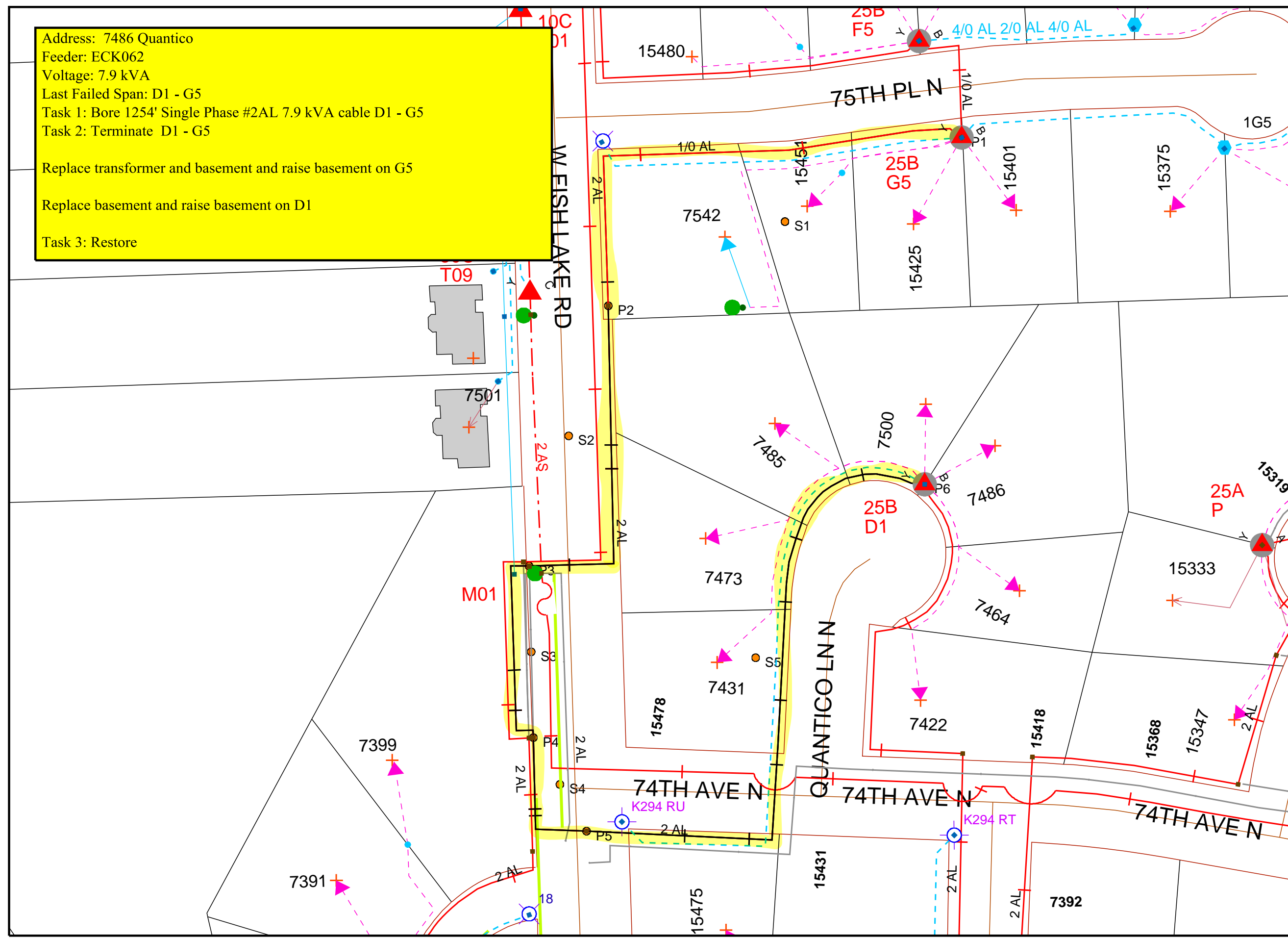

Work Order Information	
Service Request #	: 01423385
Design Number	: 0000585231
Designer/Planner ID	: 216166
Designer/Planner Name	: Joel.Feik@xcelenergy.com
Designer/Planner Ph #	: (651) 415 -3836
Manager Approval	: _____

Joint Utility	
E:	G:
T:	C:

Design Location	
Division	: Maple grove
County	: Hennepin
City	: Maple Grove
Address	:
T: 119N	R: 22W S: 28
Map #	: K52094 Permit :

Electric	
Feeder:	Voltage: 7970
Phase:	Bkup Dev ID:

Gas	
System	: Pressure :
Size	: Material :
Dead End	:

Work Order # :  
 Date: 07/21/2017  
 Sketch: # Of # Sketch Data  
 Scale: 1" equals 72'

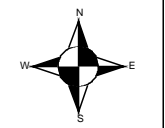

- CONSTRUCTION USE ONLY**
- NO CHANGES (BUILT AS DESIGNED)
  - CHANGES MADE AS INDICATED (ALL URD MUST HAVE ACTUAL MEASUREMENTS FROM THE FIELD SITE)

RFO \_\_\_\_\_  
 FOREMAN \_\_\_\_\_ DATE \_\_\_\_\_  
 TEAM LEADER \_\_\_\_\_

DISCLAIMER: THERE ARE NO REPRESENTATIONS OR WARRANTIES (EXPRESS OR IMPLIED) ABOUT THE ACCURACY OF THIS PRINT. THIS PRINT IS PROVIDED WITH NO CLAIM AS TO PRINT COMPLETENESS, TIMELINESS, ACCURACY OF CONTENT OR USEFULNESS. STATE LAW REQUIRES ANYONE DIGGING, GRADING OR EXCAVATING TO OBTAIN A PRIOR FIELD LOCATE OF ALL UTILITIES; THIS PRINT DOES NOT DISCHARGE THIS REQUIREMENT OR ANY OTHER REQUIREMENT. THE COMPANY AND ITS AFFILIATES ASSUME NO LEGAL RESPONSIBILITY OR LIABILITY FOR THE RECIPIENT'S USE (OR ANY OTHER PARTIES' USE) OF THE PRINT, INCLUDING THE RECIPIENTS INTENDED PURPOSE IN USING THE PRINT. NO COMPANY EMPLOYEE OR OTHER PARTY HAS BEEN AUTHORIZED TO PROVIDE THIS PRINT FOR PLANNING OR ESTIMATING PURPOSES; RELY ON THIS PRINT AT YOUR OWN RISK. BY ACCEPTING THIS PRINT, THE RECIPIENT & ANY OTHER PARTY RECEIVING A COPY OF THE PRINT ACKNOWLEDGES AND AGREES TO THIS DISCLAIMER. For All Field Locates Call 811