

PROJECT INFORMATION:
 Install 35KV 1/0 AL J Primary in a joint trench with gas, telephone, and cable TV
 Feeder is ECK322 and is currently operating at 34.5KV
 Install single voltage 19920 Transformers
 Direct Bore primary along County Road 30 back of R/W to T24
 Run new joint trench 5ft back of curb, Water-Stops/Sewer Tails extend 10ft back of curb
 Run new joint trench minimum 10ft back of proposed building
 Drainage and Utility Easement over all of Outlot A; refer to Plat
 There is no proposed sidewalk on this project
 New residences are medium house sized homes, approximately 2,000 sq. ft.
 House setback is 20ft from curb
 Homes will have 200 Amp electric meters
 No services will be stubbed for future connections
 One Traditional 100W on 18ft Fiberglass Direct Bury; Bronze installed at Block 1 Lot 1
 One Traditional 100W on 18ft Fiberglass Direct Bury Bronze installed at Block 6 Lot 5
 All transformer, pedestal, and street light locations to be staked by developer
 Map #: K52011

**CAMBRIDGE PARK SECOND ADDITION
 MAPLE GROVE, MN
 ELECTRIC LAYOUT**

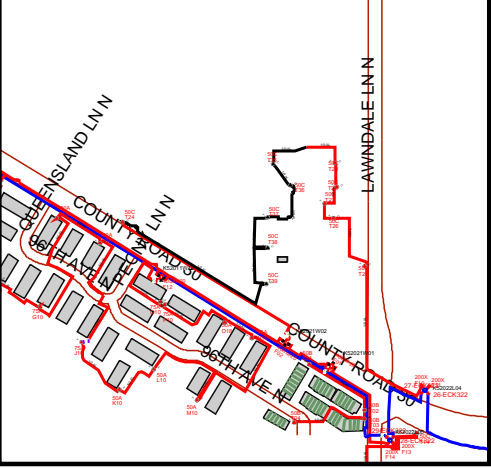
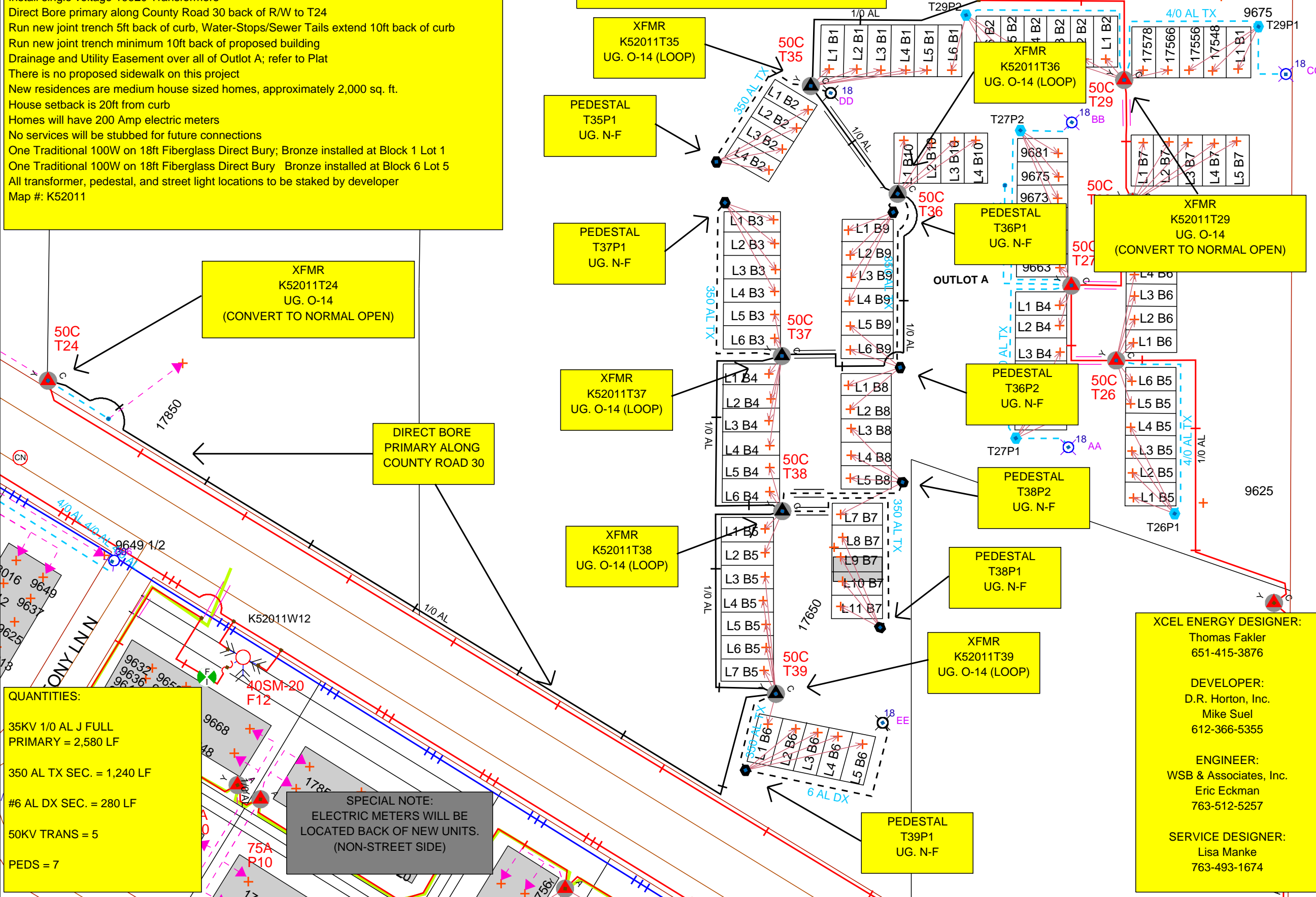

**TASK 01: JT INSTALL
 TASK 02: TERMINATION**

Work Order Information

Service Request #	: 01399596
Design Number	: 0000576971 3
Designer/Planner ID	: 223718
Designer/Planner Name	: Fakler, Thomas
Designer/Planner Ph #	: (651) 415-3876
Manager Approval	: _____

Joint Utility

E: Xcel Energy	G: CenterPoint
T: Century Link	C: Comcast

Design Location

Division	: Maple Grove		
County	: Hennepin		
City	: Maple Grove		
Address	: Cambridge Park 2nd Addition		
T: 119N	R: 22W	S: 7	
Map #	: K52011	Permit	: City of Maple Grove

Electric

Feeder: ECK322	Voltage: 34.5/19.9
Phase: C	Bkup Dev ID: N/A

Gas

System	: N/A	Pressure	: N/A
Size	: N/A	Material	: N/A
Dead End	: N/A		

Work Order # : EJ-12551673/ES-12551675
 Date: 05/24/2017
 Sketch: 1 Of 1 Sketch Data
 Scale: 1" equals 100'



QUANTITIES:
 35KV 1/0 AL J FULL PRIMARY = 2,580 LF
 350 AL TX SEC. = 1,240 LF
 #6 AL DX SEC. = 280 LF
 50KV TRANS = 5
 PEDS = 7

SPECIAL NOTE:
 ELECTRIC METERS WILL BE LOCATED BACK OF NEW UNITS.
 (NON-STREET SIDE)

XCEL ENERGY DESIGNER:
 Thomas Fakler
 651-415-3876

DEVELOPER:
 D.R. Horton, Inc.
 Mike Suel
 612-366-5355

ENGINEER:
 WSB & Associates, Inc.
 Eric Eckman
 763-512-5257

SERVICE DESIGNER:
 Lisa Manke
 763-493-1674

DISCLAIMER: THERE ARE NO REPRESENTATIONS OR WARRANTIES (EXPRESS OR IMPLIED) ABOUT THE ACCURACY OF THIS PRINT. THIS PRINT IS PROVIDED WITH NO CLAIM AS TO PRINT COMPLETENESS, TIMELINESS, ACCURACY OF CONTENT OR USEFULNESS. STATE LAW REQUIRES ANYONE DIGGING, GRADING OR EXCAVATING TO OBTAIN A PRIOR FIELD LOCATE OF ALL UTILITIES; THIS PRINT DOES NOT DISCHARGE THIS REQUIREMENT OR ANY OTHER REQUIREMENT. THE COMPANY AND ITS AFFILIATES ASSUME NO LEGAL RESPONSIBILITY OR LIABILITY FOR THE RECIPIENT'S USE (OR ANY OTHER PARTIES' USE) OF THE PRINT, INCLUDING THE RECIPIENT'S INTENDED PURPOSE IN USING THE PRINT. NO COMPANY EMPLOYEE OR OTHER PARTY HAS BEEN AUTHORIZED TO PROVIDE THIS PRINT FOR PLANNING OR ESTIMATING PURPOSES; RELY ON THIS PRINT AT YOUR OWN RISK. BY ACCEPTING THIS PRINT, THE RECIPIENT & ANY OTHER PARTY RECEIVING A COPY OF THE PRINT ACKNOWLEDGES AND AGREES TO THIS DISCLAIMER. For All Field Locates Call 811

CONSTRUCTION USE ONLY

NO CHANGES (BUILT AS DESIGNED)
 CHANGES MADE AS INDICATED
 (ALL URD MUST HAVE ACTUAL MEASUREMENTS FROM THE FIELD SITE)

RFO _____
 FOREMAN _____ DATE _____
 TEAM LEADER _____