



*Applicant:

First Name:	Last Name:	
Todd	Paulson	
Company:		
CenturyLink		
Company Phone:	Local Phone:	
(651) 312 - 5527	() -	
Email Address:		
todd.paulson@centurylink.com		
Mailing Address:		
Address Line 1:		
425 Monroe St		
Address Line 2:		
City:	State:	Zip Code:
Anoka	MN	55303

* Nature of Work:

- Main Installation
- Service Installation
- Other

* Surface to be Disturbed:

- Gravel
- Concrete
- Bituminous
- Boulevard

* Work to start on or after:

* To be completed on or before:

Applicant Project No.:

(Job Number)

* Provide a detailed work description:

Bore 57' of Fiber from existing HH in South West corner of the intersection of Trenton Ln N and 73rd Ave N, across Trenton Ln N, then bore 90' North across 73rd Ave N to the customer premise of 10297 73rd Ave N. Then Place 1 30"x48"x36" Handhole.

Size and kind of pipe:

1.25" PVC Pipe with Fiber

* Depth from surface:

36" - 48" ▼

If other is selected, please provide additional information:

* Length of utility construction:

147' (Feet Only)

* Method of installation:

- Directional Bore
- Hand Dig
- Open Trench
- Joint Trench
- Other

If other is selected, please provide additional information:

* Machine excavation:

Yes ▼

* Development:

Existing ▼

* Will traffic detouring be necessary:

No ▼

* Will any excavation be taking place on Hennepin County right-of-way?

No ▼

PERMIT DRAWING

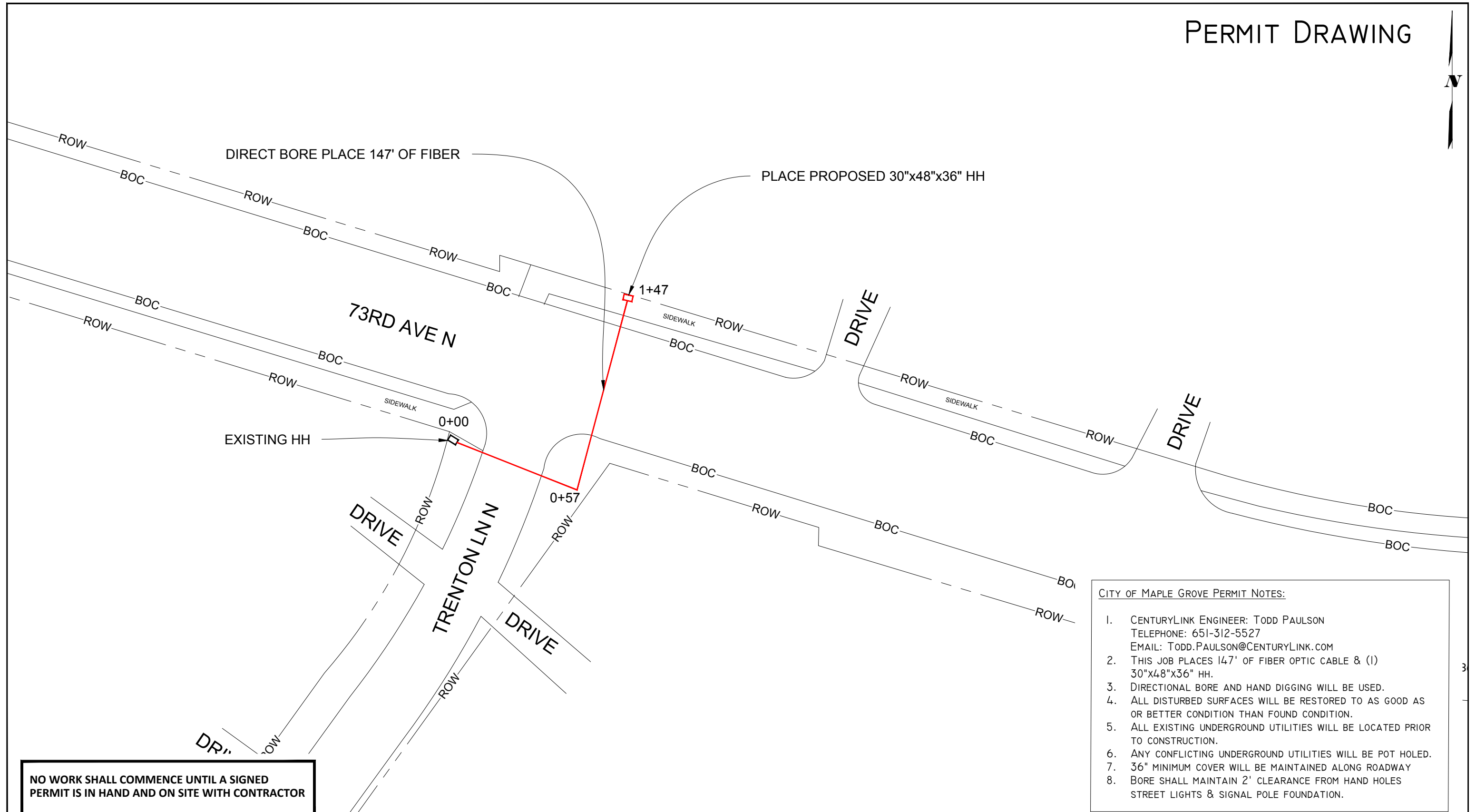
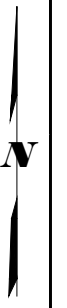

NO WORK SHALL COMMENCE UNTIL A SIGNED PERMIT IS IN HAND AND ON SITE WITH CONTRACTOR

- CITY OF MAPLE GROVE PERMIT NOTES:
1. CENTURYLINK ENGINEER: TODD PAULSON
TELEPHONE: 651-312-5527
EMAIL: TODD.PAULSON@CENTURYLINK.COM
 2. THIS JOB PLACES 147' OF FIBER OPTIC CABLE & (1) 30"x48"x36" HH.
 3. DIRECTIONAL BORE AND HAND DIGGING WILL BE USED.
 4. ALL DISTURBED SURFACES WILL BE RESTORED TO AS GOOD AS OR BETTER CONDITION THAN FOUND CONDITION.
 5. ALL EXISTING UNDERGROUND UTILITIES WILL BE LOCATED PRIOR TO CONSTRUCTION.
 6. ANY CONFLICTING UNDERGROUND UTILITIES WILL BE POT HOLED.
 7. 36" MINIMUM COVER WILL BE MAINTAINED ALONG ROADWAY
 8. BORE SHALL MAINTAIN 2' CLEARANCE FROM HAND HOLES STREET LIGHTS & SIGNAL POLE FOUNDATION.



PERMITS REQUIRED: CITY OF MAPLE GROVE
W/C: OSSEMNXO
CPA: MDEMAIO
CPS: BRICHTER

CONTACT PERSON: LANCE MURDOCK
PHONE: 214-326-7894
FAX:
EMAIL: LANCE.MURDOCK@CENTURYLINK.COM

JOB: N.259260
Loc.: 10297 73RD AVE N,
MAPLE GROVE, MN
SECTION: 25, TOWN: 119, RANGE: 22
COORDINATES: 45.084846, -93.411062

DRAWING SYMBOLS

STREET LIGHT	FIRE HYDRANT	VALVE	MANHOLE
STORM DRAIN	UTILITY POLE	EXISTING PED/CABINET	TREE

0' 40'
SCALE: 1" = 40'
SHEET: 1 OF 1