

# PERMIT DRAWING

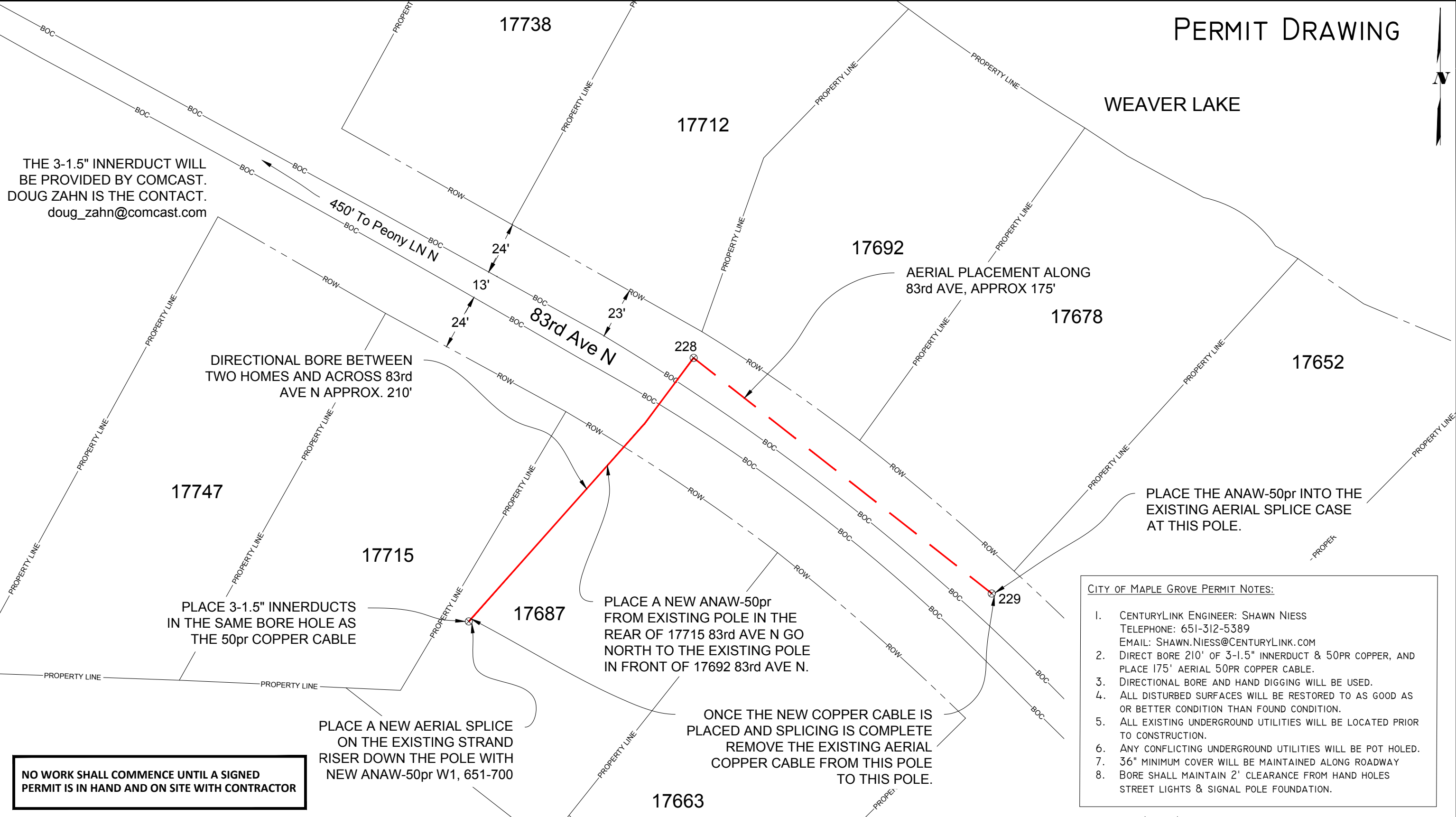

THE 3-1.5" INNERDUCT WILL BE PROVIDED BY COMCAST. DOUG ZAHN IS THE CONTACT. [doug\\_zahn@comcast.com](mailto:doug_zahn@comcast.com)

- CITY OF MAPLE GROVE PERMIT NOTES:
1. CENTURYLINK ENGINEER: SHAWN NIESS  
TELEPHONE: 651-312-5389  
EMAIL: SHAWN.NIESS@CENTURYLINK.COM
  2. DIRECT BORE 210' OF 3-1.5" INNERDUCT & 50PR COPPER, AND PLACE 175' AERIAL 50PR COPPER CABLE.
  3. DIRECTIONAL BORE AND HAND DIGGING WILL BE USED.
  4. ALL DISTURBED SURFACES WILL BE RESTORED TO AS GOOD AS OR BETTER CONDITION THAN FOUND CONDITION.
  5. ALL EXISTING UNDERGROUND UTILITIES WILL BE LOCATED PRIOR TO CONSTRUCTION.
  6. ANY CONFLICTING UNDERGROUND UTILITIES WILL BE POT HOLED.
  7. 36" MINIMUM COVER WILL BE MAINTAINED ALONG ROADWAY
  8. BORE SHALL MAINTAIN 2' CLEARANCE FROM HAND HOLES STREET LIGHTS & SIGNAL POLE FOUNDATION.

**NO WORK SHALL COMMENCE UNTIL A SIGNED PERMIT IS IN HAND AND ON SITE WITH CONTRACTOR**

5605 GREEN CIRCLE DR.  
MINNETONKA, MN 55363

PERMITS REQUIRED: CITY OF MAPLE GROVE  
W/C: MPGVMNXA  
CPA: MDEMAIO  
CPS: BRICHTER

CONTACT PERSON: SHAWN NIESS  
PHONE: 651-312-5389  
FAX:  
EMAIL: SHAWN.NIESS@CENTURYLINK.COM

JOB: N.204354  
Loc.: 17687 83RD AVE N,  
MAPLE GROVE, MN 55311  
SECTION: 19, TOWN: 119, RANGE: 22  
COORDINATES: 45.106302, -93.504347

DRAWING SYMBOLS

0' 40'

SCALE: 1" = 40'

SHEET: 1 OF 1