

Tony Rosales
 Office: 763-493-1845
 Cell: 763-245-6056
 14101 92nd PL N
 Maple Grove MN
 Feeder: ECK063
 Replacing faulted primary cable from TR-E to TR-F

ELM CREEK

Task 2:
 Remove and replace XFMR-E and Basement.
 Replace Basement at XFMR-F if necessary.
 Abandon old Cable from E-F

Task 2:
 Service Connections

Task 3:
 Restoration

Task 1:
 Bore in approx. 700ft of new 2AL
 Primary cable from TR-E to TR-F

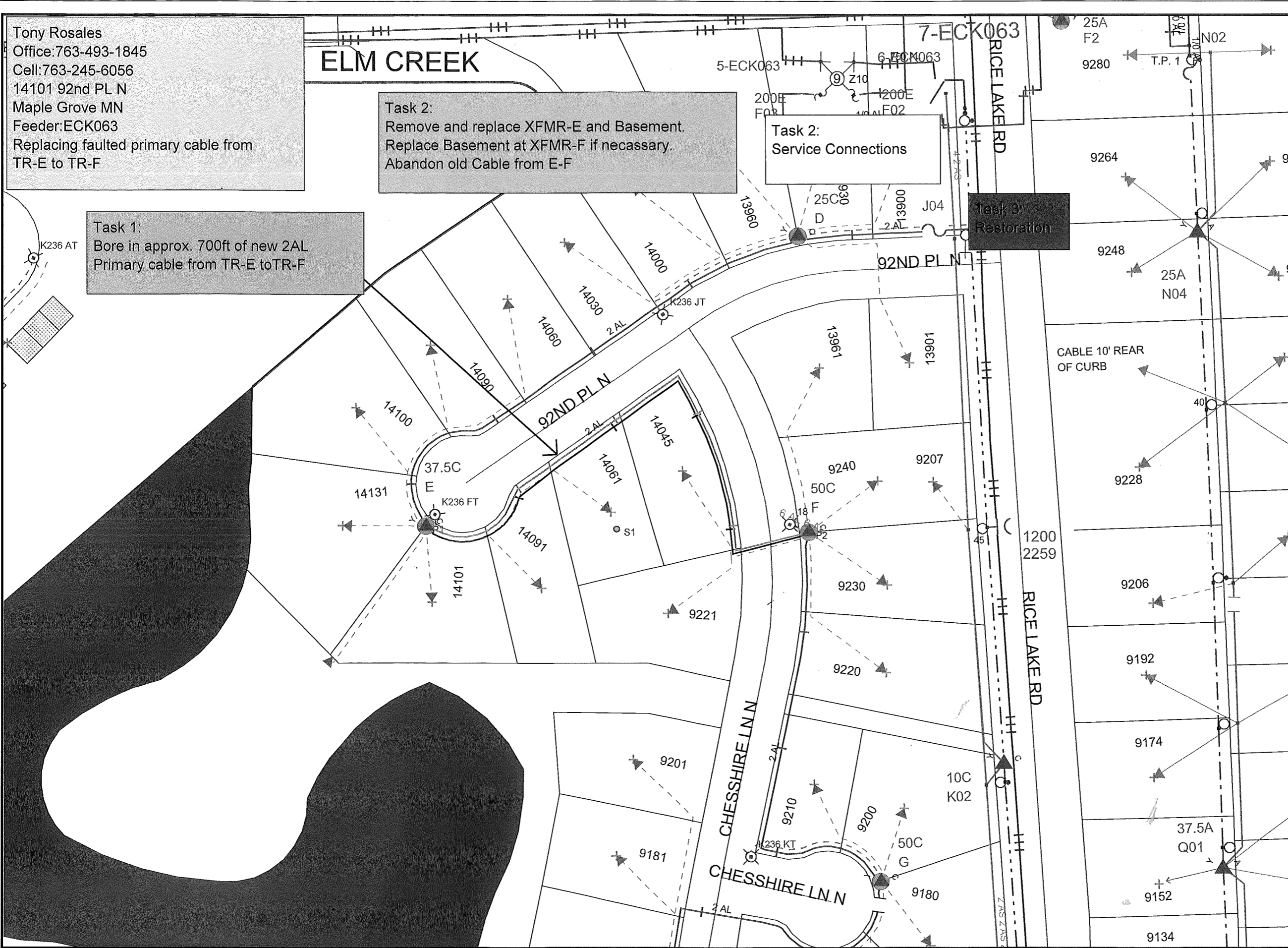

Work Order Information	
Service Request #	:
Design Number	: 0000564969 1
Designer/Planner ID	: 223912
Designer/Planner Name	: Tony Rosales
Designer/Planner Ph #	: 763-245-6056
Manager Approval	:

Joint Utility	
E:	G:
T:	C:

Design Location	
Division	: Maple Grove
County	: Hennepin
City	: Maple Grove
Address	:
T:	119N R: 22W S: 15
Map #	: K52036 Permit :

Electric	
Feeder:	ECK063 Voltage: 7970
Phase:	C Bkup Dev ID:

Gas	
System	: Pressure :
Size	: Material :
Dead End	:

Work Order # :
 Date: 05/15/2017
 Sketch: # Of # Sketch Data
 Scale: 1" equals 100'

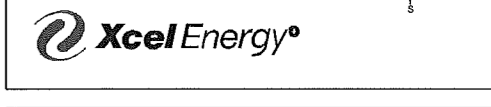

CONSTRUCTION USE ONLY
 NO CHANGES (BUILT AS DESIGNED)
 CHANGES MADE AS INDICATED
 (ALL URD MUST HAVE ACTUAL MEASUREMENTS FROM THE FIELD SITE)

RFO _____
 FOREMAN _____ DATE _____
 TEAM LEADER _____

DISCLAIMER: THERE ARE NO REPRESENTATIONS OR WARRANTIES (EXPRESS OR IMPLIED) ABOUT THE ACCURACY OF THIS PRINT. THIS PRINT IS PROVIDED WITH NO CLAIM AS TO PRINT COMPLETENESS, TIMELINESS, ACCURACY OF CONTENT OR USEFULNESS. STATE LAW REQUIRES ANYONE DIGGING, GRADING OR EXCAVATING TO OBTAIN A PRIOR FIELD LOCATE OF ALL UTILITIES; THIS PRINT DOES NOT DISCHARGE THIS REQUIREMENT OR ANY OTHER REQUIREMENT. THE COMPANY AND ITS AFFILIATES ASSUME NO LEGAL RESPONSIBILITY OR LIABILITY FOR THE RECIPIENT'S USE (OR ANY OTHER PARTIES' USE) OF THE PRINT, INCLUDING THE RECIPIENT'S INTENDED PURPOSE IN USING THE PRINT. NO COMPANY EMPLOYEE OR OTHER PARTY HAS BEEN AUTHORIZED TO PROVIDE THIS PRINT FOR PLANNING OR ESTIMATING PURPOSES; RELY ON THIS PRINT AT YOUR OWN RISK. BY ACCEPTING THIS PRINT, THE RECIPIENT & ANY OTHER PARTY RECEIVING A COPY OF THE PRINT ACKNOWLEDGES AND AGREES TO THIS DISCLAIMER. For All Field Locates Call 811