

		Local Exch#			CMS#	17095543 HELD / PERMIT	
CenturyLink BSW Order/Maintenance Work Authorization							
Company	T600	Exchange				Service Order#	
Work Activity	Drop-Buried Copper			Capital	Y	Maintenance	
Customer Name	kent schmid			Phone#	7633152991		
Address	12216 85th pl n.			One Call Ticket#			
City & Zip	maple grove						
Location/Directions							
Description of Work or Special Instructions	plow in fiber drop, 3 driveway bores. 250ft						

Held Order ?		Permit:		Bore:	Y	CBR#	630-947-6254
Employee Name	pat nathe			Employee Contact#	612-715-9213		

Sketch (Include Cntr Line & Pedestal)	Material/Labor Units		Est Qty.	Actual Qty	Placed by (Foreman/Crew Name)
	Description	Notes			
Cntr Line foot#	SEB3-22	Place 3 pair BSW			
Ped#	123944	SEPCUTOVER			
Parish/County	Hennep	BM83	1		
		XXSEB-GL			
Township:		BM61(1.5)D			
Section		SEB3-22T			
Range		SEBOP2	1		
Nearest cross st.	kirkwood ln		Plat Page		Map#
Damaged facility #					
SKETCH					

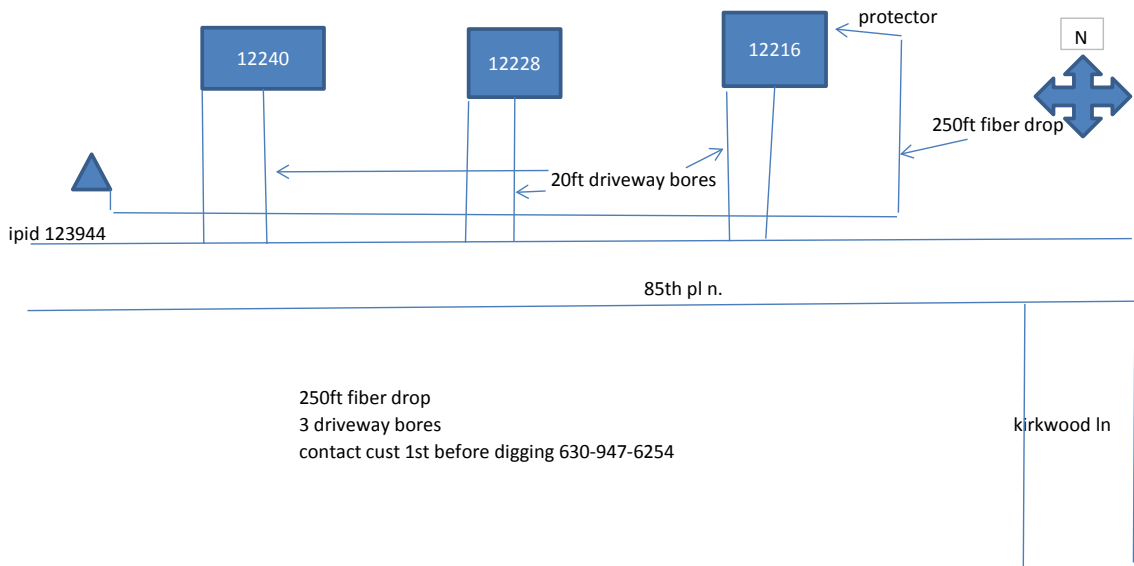

--	--

Originated By:	p.nathe	Date:		Completed By:		Date:	
Authorized By: (APS)		Date:		Inspected By:		Date:	
Authorized By: (AOM)		Date:					
Inspection Notes:	MetroBSW@centurylink.com						

1. Distance of the bury in Right-of-Way					3. Distance to the nearest intersection		
2. Distance from the terminal to the centerline:					4. Nearest State Hwy mile marker		